

VICINITY MAP
NO SCALE

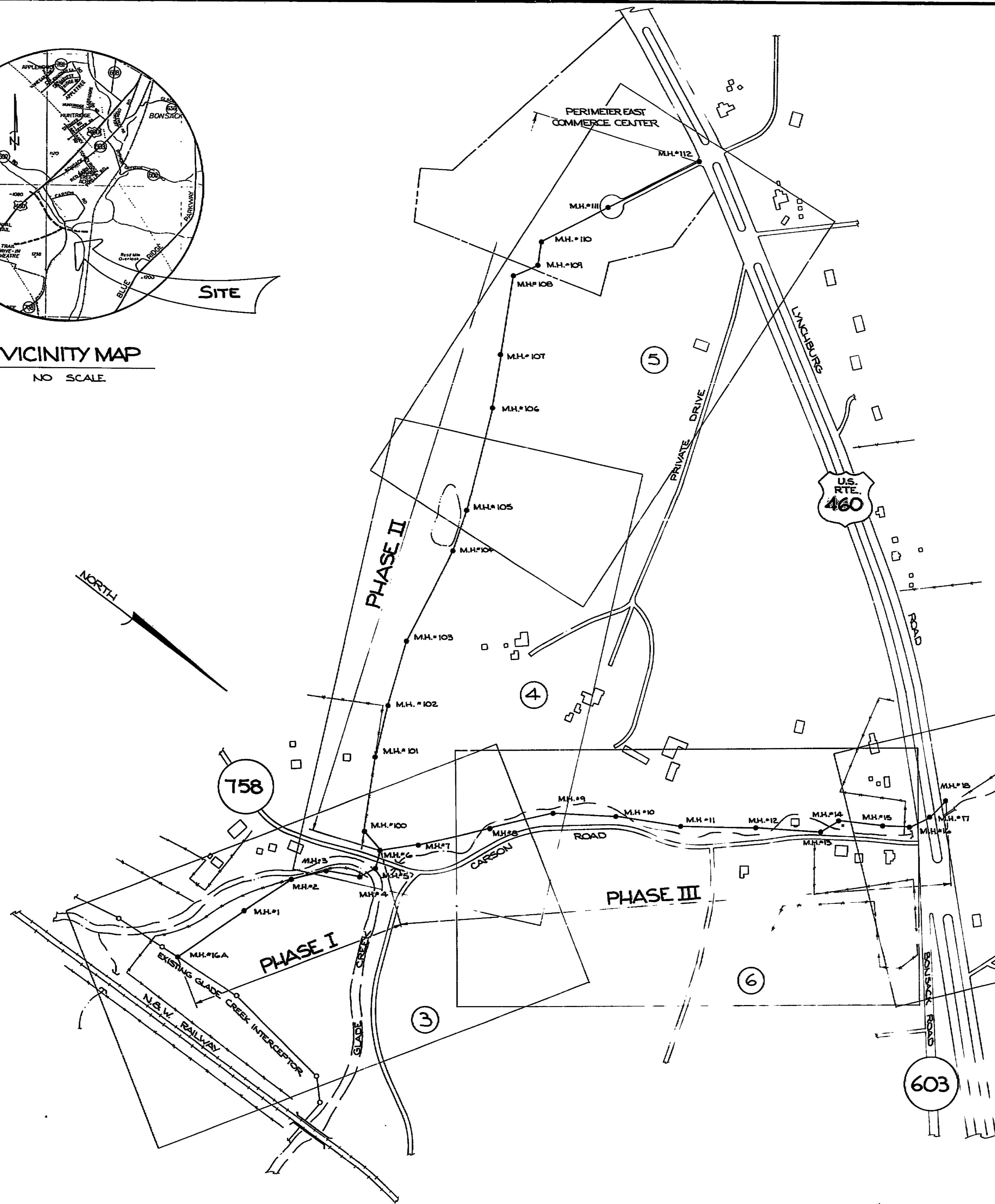

GENERAL NOTES:

- LOCATION OF UNDERGROUND UTILITIES IS BASED ON FIELD SURVEYS, AS SHOWN BY AVAILABLE RECORDS AND AS LOCATED BY THE UTILITY LOCATOR SERVICE. CONTRACTOR SHALL VERIFY LOCATION OF ALL UTILITIES PRIOR TO CONSTRUCTION.
- A PRECONSTRUCTION CONFERENCE SHALL BE SCHEDULED WITH THE ROANOKE COUNTY ENGINEERING DIVISION A MINIMUM OF ONE WEEK PRIOR TO ANY CONSTRUCTION.
- CONTRACTORS SHALL NOTIFY UTILITIES OF CONSTRUCTION AT LEAST TWO BUT NOT MORE THAN TEN WORKING DAYS IN ADVANCE. AREA PUBLIC UTILITIES SHALL BE NOTIFIED THRU MISS UTILITY 800-552-7001
- ALL WORK SHALL BE INSPECTED BY ROANOKE COUNTY AND/OR VDOT INSPECTORS. THE CONTRACTOR SHALL COORDINATE HIS WORK AS NECESSARY WITH THE APPROPRIATE AGENCIES, AS REQUIRED FOR INSPECTION.
- FIELD CORRECTIONS SHALL BE APPROVED BY THE ROANOKE COUNTY ENGINEERING DIVISION PRIOR TO CONSTRUCTION.
- ALL CONSTRUCTION METHODS AND MATERIALS SHALL CONFORM TO THE CONSTRUCTION STANDARDS AND SPECIFICATIONS OF ROANOKE COUNTY AND/OR THE VIRGINIA DEPARTMENT OF TRANSPORTATION.
- A MINIMUM COVER OF THREE FEET (3') IS REQUIRED OVER PROPOSED LINE. STREAM CROSSINGS SHALL BE CONCRETE ENCASED AND/OR DUCTILE IRON AS INDICATED ON PLANS.
- ALL EXISTING UTILITIES MAY NOT BE SHOWN OR MAY NOT BE SHOWN IN THE EXACT LOCATION. THE CONTRACTOR SHALL COMPLY WITH STATE WATER WORKS REGULATIONS, SECTION 12.05.03, WHERE LINES CROSS.
- ALL TRENCHES IN EXISTING OR FUTURE HIGHWAY RIGHT-OF-WAYS SHALL BE COMPACTED ACCORDING TO VDOT STANDARDS.
- GRADE STAKES SHALL BE SET AND CUT SHEETS PROVIDED TO THE INSPECTOR PRIOR TO CONSTRUCTION.
- PERMITS FOR STREAM AND ROAD CROSSINGS WILL BE PROVIDED BY ROANOKE COUNTY. THE CONTRACTOR SHALL INSURE THAT THE JOB SUPERINTENDENT HAS COPIES AND IS FAMILIAR WITH THE REQUIREMENTS OF THESE PERMITS.
- THE CONTRACTOR SHALL COMPLY WITH LOCAL CODES IN OBSERVING EROSION CONTROL MEASURES BOTH ON AND OFF THE SITE. REFER TO THE VIRGINIA SOIL EROSION AND SEDIMENT CONTROL HANDBOOK DATED 1980 FOR DETAILS AND SPECIFICATIONS OF APPROPRIATE EROSION CONTROL ITEMS.
- THE CONTRACTOR SHALL PROVIDE ADEQUATE MEANS OF CLEANING MUD FROM TRUCKS OR OTHER EQUIPMENT PRIOR TO ENTERING PUBLIC STREETS. IT IS THE CONTRACTOR'S RESPONSIBILITY TO INSURE THAT THE STREETS ARE IN A CLEAN, MUD AND DUST FREE CONDITION AT ALL TIMES.
- THE CONTRACTOR SHALL CONSTRUCT THE SEWER FROM MH #109 THRU MH #112, PHASE II PRIOR TO CONSTRUCTING ANY OTHER PIPELINE IN THE PROJECT. CONTRACTOR SHALL COORDINATE HIS WORK WITH THE CONTRACTOR FOR PERIMETER EAST COMMERCE CENTER FOR ALL WORK IN THE PROPOSED TRAIL DRIVE.
- THE CONTRACTOR SHALL PROTECT EXISTING 16" DUCTILE IRON WATER LINE AS NECESSARY DURING CONSTRUCTION OF SEWER LINE FROM MH #110 THRU MH #112.
- ACCESS TO PHASE I CONSTRUCTION IS OFF OF ROUTE 606 THRU THE FARM OF MR. W. H. DOWDY. CONTRACTOR SHALL COORDINATE ACCESS WITH MR. DOWDY PRIOR TO CONSTRUCTION.
- PHASE II AND PHASE III CONSTRUCTION THRU PROPERTY OF DR. RICHARD LOWE, JR. IS THRU AREAS WHICH HAVE LIVESTOCK IN CONSTRUCTION AREA. CONTRACTOR SHALL COORDINATE WITH DR. LOWE PRIOR TO CONSTRUCTION. THE CONTRACTOR SHALL ALSO BE RESPONSIBLE FOR TEMPORARY FENCING AND REPLACEMENT OF PERMANENT FENCING AS REQUIRED.
- MANHOLES FOR THE PROJECT AS REQUIRED:

WATER TIGHT MANHOLES	STANDARD FRAME & COVER MANHOLES
16A, 1, 2, 3, 4, 5, 10, 12, 102, 103	6, 7, 8, 9, 11, 13, 14, 15, 16, 17, 18, 100, 101, 104, 105, 106, 107, 108, 109, 110, 111, 112
10 TOTAL	22 TOTAL

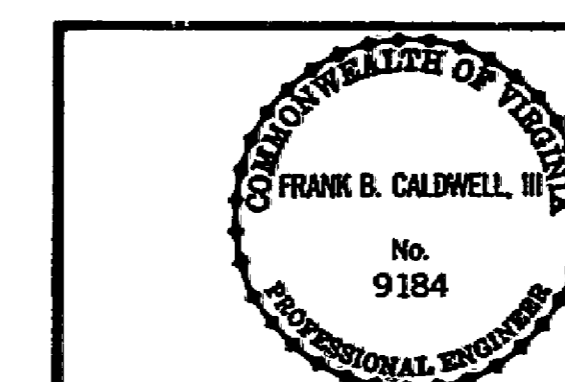

SHEET INDEX MAP
GLADE CREEK
SANITARY SEWER INTERCEPTOR
EXTENSION - PHASE I II & III

SCALE: 1" = 200' ROANOKE CO., VIRGINIA DATE: MARCH 10, 1988

DATE	REVISIONS	BY

DESIGNED BY: D.W.B.
DRAWN BY: D.W.B.
CHECKED BY: [Signature]
W.O. # 88-0022
R.B. RCPSA-1

T. P. PARKER & SON
engineers & surveyors, ltd.

TELEPHONE (703) 387-1153
P.O. DRAWER 473, SALEM, VIRGINIA 24153

88-02-S

SHEET 2 OF 8

