

BRATTONLAWN DR., N.E.

MATCH LINE—SEE SHEET 8 FOR CONTINUATION

APPROXIMATE LOCATION OF NEW NATURAL GAS SERVICE LINES (TYP)—COORDINATE EXACT LOCATIONS, SIZES, METER LOCATION(S), AND CONSTRUCTION REQUIREMENTS WITH ROANOKE GAS CO.

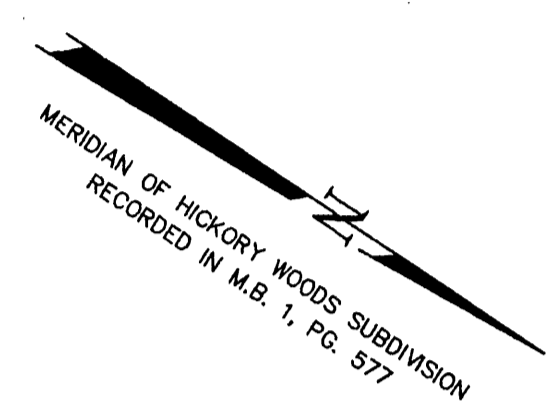

ALL NEW WATER AND SANITARY SEWER CONSTRUCTION SHALL BE PERFORMED IN STRICT CONFORMANCE WITH CITY OF ROANOKE STANDARDS AND SPECIFICATIONS PERTAINING THERETO.

- ◻ SEE SHEETS 5 AND 9 FOR NEW STORM DRAIN INFORMATION
- SEE SHEET 10 FOR SANITARY SEWER PROFILES ○

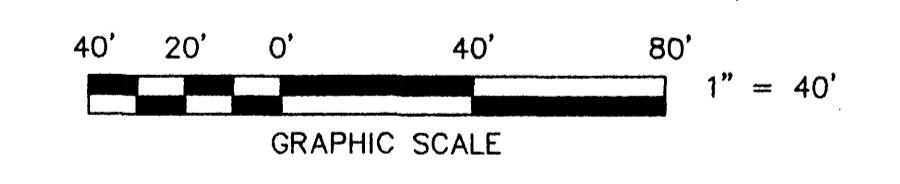

BENCHMARK:
RAILROAD SPIKE SET IN
APCO POLE #231-DI-6055
ELEVATION = 977.31

PROPERTY OF
FRALIN & WALDRON, INC.
TAX No. 7100610
ZONED: RM-2

WATER NOTE
THE NEW 2-1/2" WATERLINE WITHIN THE EXISTING EASEMENT MUST BE MAINTAINED BY THE DEVELOPER, NOT THE CITY OF ROANOKE.

EXIST. 12" C.M. PIPE
INV. IN=986.04
INV. OUT=984.07
CONTRACTOR SHALL EXTEND 12" C.M. PIPE
8' AT THE INLET END. NEW INV. IN=986.35

	UTILITY PLAN — EAST FOR GLADE CREEK STATION FOR MANAGEMENT SERVICES CORPORATION SITUATE KING STREET CITY OF ROANOKE, VIRGINIA	
	SCALE: 1" = 40'	DATE: MARCH 03, 1997
DESIGNED BY CLW/JPR DRAWN BY CLW/JPR CHECKED BY JTP W.O. # 96-0802 N.B. HICKORY WOODS # 5 TAX NO. 709-0501		
		T. P. PARKER & SON 816 Boulevard Post Office Box 39 Salem, Virginia 24153 Telephone: 540-387-1183 FAX: 540-389-8787

REVISED NOV. 23, 1999: MISCELLANEOUS REVISIONS PER OWNER - JMS
 REVISED OCT. 14, 1998: REVISED S.S.C.O. ELEVATIONS PER OWNER - JPR
 REVISED SEPT. 11, 1998: REVISED BLDG. LAYOUT PER OWNER - JPR
 REVISED JULY 01, 1997: REVISED GRADING OF NORTHWEST QUADRANT OF SITE PER OWNER-CLW
 REVISED MAY 05, 1997: REVISED PHASE LINE PER OWNER-CLW
 REVISED APRIL 16, 1997 PER OWNER AND CITY OF ROANOKE REVIEW-CLW
 REVISED APRIL 08, 1997-ADD GAS LINES-CLW