

DEVELOPMENT PLAN
FOR
SANITARY SEWER EXTENTION
SECTION No.1 & No.2 "GROVE PARK"

SITUATED IN
CAVE SPRING MAGISTERIAL DISTRICT
ROANOKE COUNTY, VIRGINIA

DATE: 15 DECEMBER 1994
"AS-BUILT" 20 JUNE 1995

PREPARED FOR
PALM LAND COMPANY, L.C.

INDEX OF DRAWINGS

<u>SHEET No.</u>	<u>DESCRIPTION</u>
1.	LUMSDEN ASSOCIATES COVER SHEET
2.	ROANOKE COUNTY STD. COVER SHEET
3.	DIMENSIONAL LAYOUT & UTILITIES PLAN
4.	GRADING DETAILS
5.	SANITARY SEWER PROFILES
6.	SANITARY SEWER PROFILES
7.	CROSS SECTIONS (NOT USED)
8.	CROSS SECTIONS (NOT USED)
9.	LIFT STATION DETAILS
10.	EROSION CONTROL PLAN
11.	EROSION CONTROL DETAIL SHEET
12.	ROANOKE CO. STD. SANITARY SEWER DETAIL SHEET

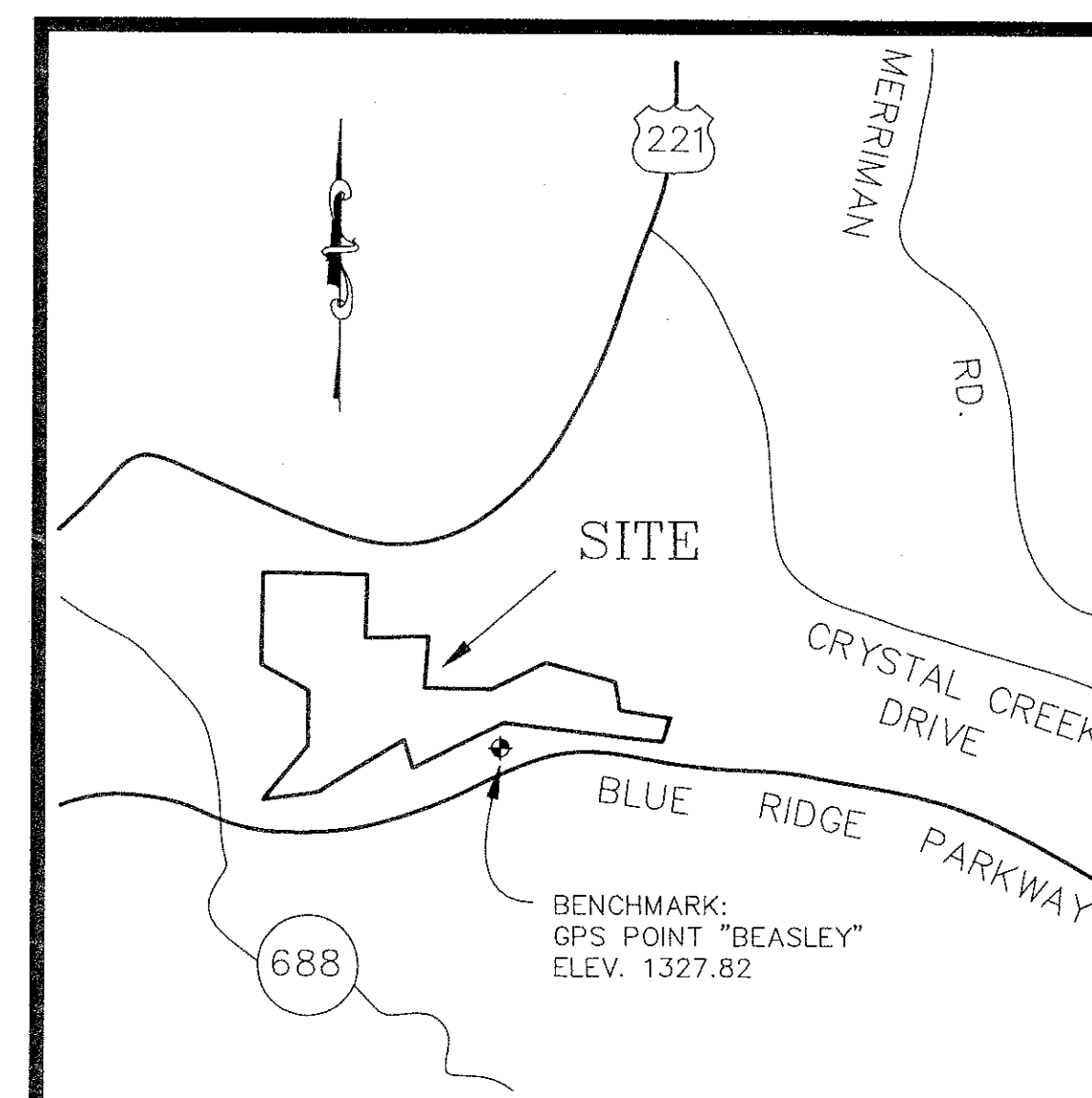

LUMSDEN ASSOCIATES, P.C.
ENGINEERS-SURVEYORS-PLANNERS
ROANOKE, VIRGINIA