

**GENERAL NOTES**

1. PHYSICAL HANDLES, PROPERTY BOUNDARIES, AND UNDERGROUND UTILITY LOCATIONS ARE BASED ON FIELD SURVEY PERFORMED BY WV ASSOCIATES IN FEBRUARY 2014. BENCHMARK AND CONTROL LOCATIONS ARE SHOWN ON THE DRAWINGS. HORIZONTAL POSITION AND VERTICAL ELEVATION ARE ASSUMED.
2. ANY TEST PIT WORK OR PROVIDE LOCATION SERVICES AS REQUIRED TO AVOID CONFLICTS. WATER SERVICE INTERRUPTIONS WILL NOT BE ALLOWED UNLESS APPROVED BY THE TOWN. WATER SERVICE INTERRUPTIONS REQUIRED FOR SERVICE LINE RECONNECTIONS SHALL BE APPROVED BY AND COORDINATED WITH THE TOWN.
3. ALL WORK SHALL BE PERFORMED IN ACCORDANCE WITH THESE DRAWINGS AND THE LATEST EDITION OF THE VIRGINIA DEPARTMENT OF HEALTH (VDH) WETWEATHER REGULATIONS. ALL WORK IN VDOT RIGHT-OF-WAY SHALL BE PERFORMED IN ACCORDANCE WITH THE VIRGINIA DEPARTMENT OF TRANSPORTATION ROAD AND BRIDGE 2008 STANDARDS AND 2007 SPECIFICATIONS. ALL WORK IN PUBLIC RIGHT-OF-WAY SHALL BE PERFORMED IN ACCORDANCE WITH THE VIRGINIA WORK AREA PROTECTION MANUAL. THE CONTRACTOR SHALL MAINTAIN A COPY OF THE CONTRACT DRAWINGS AND PROJECT MANUAL AT THE PROJECT SITE AT ALL TIMES DURING CONSTRUCTION.
4. THE LOCATION, DIMENSIONS, AND ELEVATIONS OF EXISTING STRUCTURES, PIPING, AND UTILITIES SHOWN ARE BASED ON THE BEST AVAILABLE DATA AND ARE APPROXIMATE. THE CONTRACTOR SHALL VERIFY ALL DATA IN THE FIELD PRIOR TO CONSTRUCTION TO HIS OWN SATISFACTION. THE DIMETERS OF EXISTING PIPING ARE APPROXIMATE AND SHALL BE VERIFIED PRIOR TO PERFORMING FINAL CONNECTIONS. CONTACT MISS UTILITY (TELEPHONE NO. 811) 48 HOURS PRIOR TO PERFORMING ANY EXCAVATION TO EXISTING UNDERGROUND UTILITIES MARKED. THE CONTRACTOR SHALL PERFORM ANY TEST PIT WORK OR PROVIDE LOCATION SERVICES AS REQUIRED TO AVOID CONFLICTS WITH EXISTING UTILITIES.
5. THE FLOOD INSURANCE RATE INDEX MAP FOR THE TOWN OF VINTON, VIRGINIA (COMMUNITY PANEL NO. 511610201696), DATED SEPTEMBER 28, 2007, INDICATES THAT THE PROJECT SITE LIES WITHIN FEMA DEFINED FLOOD ZONE X, AREAS DETERMINED TO BE OUTSIDE THE 0.2% CHANCE FLOOD.
6. CHANGES IN NEW PIPING FROM THAT SHOWN ON THE DRAWINGS IN ORDER TO AVOID CONFLICTS WITH EXISTING ELECTRICAL SYSTEMS, MECHANICAL SYSTEMS, EQUIPMENT, STRUCTURES, OR EXISTING PIPING AND UTILITIES, SHALL BE THE RESPONSIBILITY OF THE CONTRACTOR. THE CONTRACTOR SHALL BE RESPONSIBLE FOR OBTAINING ALL NECESSARY FIELD, LICENSE, ATTENDANCES TO EXISTING ELECTRICAL SYSTEMS, MECHANICAL SYSTEMS, EQUIPMENT OR EXISTING PIPING IN ORDER TO ACCOMMODATE NEW PIPING AND UTILITIES. EQUIPMENT SHALL BE THE RESPONSIBILITY OF THE CONTRACTOR AT NO ADDITIONAL COST TO THE OWNER. THE OWNER AND THE ENGINEER MUST APPROVE ALL SUCH CHANGES.
7. MAINTAIN AND PROTECT ALL OVERHEAD AND UNDERGROUND ELECTRICAL, TELEPHONE, CABLE TV, WATER, GAS, AND ALL OTHER UTILITIES DURING ENTIRE CONSTRUCTION PERIOD.
8. PROVIDE RESTRAINING RINGS FOR BURED PRESSURE PIPING AT ALL VALVES, FITTINGS, AND DEAD ENDS AS INDICATED IN SPEC. SECTION 02460. IF MECHANICAL RESTRAINING DEVICES ARE USED, INSTALLATION SHALL BE PERFORMED IN ACCORDANCE WITH THE MANUFACTURER'S WRITTEN RECOMMENDATIONS.
9. ALL WATER MAIN PIPING SHALL MAINTAIN A MINIMUM COVER OF 36 INCHES UNLESS OTHERWISE INDICATED. WATER MAIN SHALL BE INSTALLED AS REQUIRED TO ALLOW FOR MINIMUM 18" VERTICAL SEPARATION BETWEEN NEW WATER MAIN PIPING AND EXISTING UTILITIES. A POSITIVE GRADE SHALL BE MAINTAINED FOR THE VERTICAL ALIGNMENT OF ALL WATER MAIN PIPING TO ELIMINATE THE FORMATION OF AIR POCKETS.
10. ISOLATION VALVES AND VALVE BOXES: PROVIDE AN EXTENDED VALVE STEM WHERE DEPTH TO TOP OF VALVE EXCEEDS 5 FEET.
11. THE CONTRACTOR SHALL PROVIDE VERTICAL PIPE FITTINGS AS REQUIRED FOR COMPLETE AND OPERABLE PIPE INSTALLATIONS.
12. PROVIDE ALL CONNECTING PIECES AND TRANSITION PIECES REQUIRED TO MAKE FINAL PIPING CONNECTIONS.
13. PROVIDE A MINIMUM OF 18 INCHES CLEARANCE BETWEEN PIPING AND FOOTINGS, STRUCTURES, AND OTHER PIPING UNLESS OTHERWISE INDICATED.
14. VEGETATE AND STRUCTURAL EROSION AND SEQUEST CONTROL DEVICES SHALL BE CONSTRUCTED AND MAINTAINED FOR ALL DISTURBED AREAS IN ACCORDANCE WITH ALL LOCAL REQUIREMENTS AND THE LATEST EDITION OF THE EROSION CONTROL HANDBOOK. ALL EROSION AND SEDIMENTATION CONTROL DEVICES SHALL BE INSTALLED AS A FIRST STEP IN CONSTRUCTION AND BEFORE EXCAVATION BEGINS.
15. CONSTRUCTION LIMITS SHALL INCLUDE ALL DISTURBED AREAS. ALL DISTURBED AREAS SHALL BE SEEDDED AND PROVIDED WITH EROSION CONTROL DURING AND AT THE END OF CONSTRUCTION.
16. UNLESS OTHERWISE NOTED, REMOVE AND DISPOSE OF ALL ITEMS INDICATED TO BE DEMOLISHED OFF THE OWNER'S PROPERTY IN ACCORDANCE WITH ALL FEDERAL, STATE, AND LOCAL REGULATIONS.
17. THE CONTRACTOR SHALL COMPLY WITH ALL FEDERAL, STATE, AND LOCAL CONFINED SPACE ENTRY REGULATIONS.
18. ALL ROCK EXCAVATION SHALL BE UNCLASSIFIED. SEE SPEC. SECTION 02200 FOR ADDITIONAL REQUIREMENTS.
19. THE CONTRACTOR SHALL BE FULLY LIABLE FOR REPAIR OF ANY DAMAGES ON PUBLIC OR PRIVATE PROPERTY CAUSED BY HIS CONSTRUCTION ACTIVITIES. THE CONTRACTOR SHALL BE RESPONSIBLE FOR THE PROTECTION OF ALL EXISTING UTILITIES, STRUCTURES, STONE, DITCHES, WATERBODIES, STORM COLLECTORS, DRAINAGE COLLECTORS, SIGNS, CURBS, GUTTERS, FILL, SLOPES, OR STRUCTURES TO STABILIZED PRECONSTRUCTION CONDITIONS. ROADSIDE TREES SHALL BE PROTECTED AS MUCH AS POSSIBLE. IF TREES ARE DAMAGED, THEY SHALL BE TRIMMED OR REPAIRED TO PRESERVE THEIR LIFE. ROAD CUTTERS IMPACTED BY THE PROJECT SHALL BE SUPPORTED PROPERLY DURING WATERLINE CONSTRUCTION. CULTIVATORS SHALL BE BACKFILLED AND PROPERLY COMPACTED PER VDOT SPECIFICATIONS. CULTIVATOR FENDS SHALL BE GRADED WITH POSITIVE DRAINAGE WITH SUFFICIENT EROSION AND SEDIMENT CONTROLS INSTALLED. PRIVATE ENTRANCE CULTIVATORS SHALL BE MAINTAINED FOR POSITIVE ROADSIDE DRAINAGE.
20. ALL CONCRETE AND ASPHALT DRIVEWAYS DISTURBED BY CONSTRUCTION ACTIVITIES SHALL BE SMOOTH AND REPLACED PER RESIDENTIAL DRIVEWAY ASPHALT PAVEMENT REPAIR DETAIL. ALL GRAVEL DRIVEWAYS DISTURBED BY CONSTRUCTION ACTIVITIES SHALL BE REPLACED PER GRAVEL DRIVEWAY REPAIR DETAIL.
21. THE CONTRACTOR SHALL PROTECT EXISTING PAVED SURFACES. ANY DAMAGED PAVEMENT SHALL BE REPAIRED TO MATCH EXISTING. TRACKED EQUIPMENT WILL NOT BE ALLOWED ON PAVED SURFACES. ANY PAVEMENT MARKINGS DAMAGED BY CONSTRUCTION SHALL BE REPLACED IN KIND BY A PAVEMENT MARKING CONTRACTOR FROM THE VDOT PRE-QUALIFICATION LIST.
22. ALL PROPERTY PINS DISTURBED DURING CONSTRUCTION SHALL BE REPLACED BY A LAND SURVEYOR LICENSED BY THE COMMONWEALTH OF VIRGINIA.
23. MAINTAIN TRAFFIC TO ALL PROPERTIES AT ALL TIMES DURING CONSTRUCTION ACTIVITIES. WHENEVER CONSTRUCTION IS IN OR ADJACENT TO VDOT OR TOWN STREETS, THE CONTRACTOR SHALL PROVIDE SIGNS, DULMS, AND TRAFFIC CONTROL DEVICES AS DIRECTED BY THE OWNER'S REPRESENTATIVE. ALL SIGNS AND TRAFFIC CONTROL DEVICES SHALL CONFORM TO THE CURRENT MANUAL OF UNIFORM TRAFFIC CONTROL DEVICES (MUTCD) FOR ROADWAYS AND HIGHWAYS AS PUBLISHED BY THE U.S. DEPT. OF TRANSPORTATION, FEDERAL HIGHWAY ADMINISTRATION, THE VIRGINIA SUPPLEMENT TO MUTCD, AND THE VIRGINIA WORK AREA PROTECTION MANUAL.
24. CONSTRUCT EXCAVATION SUPPORT SYSTEMS AS REQUIRED BY GSA AND U.S. ARMY CORPS OF ENGINEERS SAFETY & HEALTH STRUCTURES MANUAL, PA 395-1-1, SECTION 23 A THROUGH E, AND WHERE INDICATED ON THE DRAWINGS TO ADEQUATELY SUPPORT EXISTING SOIL AND ADJACENT STRUCTURES DURING CONSTRUCTION ACTIVITIES.
25. SURFACE DRAINAGE: COMPLETELY DRAIN CONSTRUCTION SITE DURING PERIODS OF CONSTRUCTION TO KEEP SOIL MATERIALS SUFFICIENTLY DRY. PROVIDE TEMPORARY DITCHES, SWALES, AND OTHER DRAINAGE FEATURES AND EQUIPMENT AS REQUIRED TO MAINTAIN DRY SOILS. WHEN UNSATURATED WORKING MATERIALS ARE REQUIRED FOR EXCAVATION OPERATION AND UNSUITABLE SOIL SUPPORT FOR SUBSEQUENT CONSTRUCTION FEATURES DEVELOP, REMOVE UNSUITABLE MATERIAL, AND PROVIDE NEW SOIL MATERIAL AS SPECIFIED IN SPEC. SECTION 02200 AT NO ADDITIONAL COST TO THE OWNER.
26. SUBSURFACE DRAINAGE: CONSIDER SITE SURFACE AND SUBSURFACE CONDITIONS, AVAILABLE SOIL, AND HYDROLOGICAL DATA. REMOVE WATER BY BENCHING, SLUMP PUMPING, DEEP WELL PUMPING, OR OTHER METHODS TO PREVENT SOFTENING OF SURFACES EXPOSED BY EXCAVATION. USE FILTERS ON DRAINAGING DEVICES TO PREVENT REMOVAL OF FINES FROM SOIL. PROVIDE EROSION CONTROL AT OUTLET OR PIPING TO PREVENT EROSION. OPERATE DRAINAGING SYSTEM CONTINUOUSLY UNTIL CONSTRUCTION WORK BEYOND EXISTING WATER LEVELS IS COMPLETE.
27. CONSTRUCTION SHALL BE INFORMED AND COMPLY WITH THE VIRGINIA OVERHEAD HIGH VOLTAGE LINE SAFETY ACT. ANY COSTS TO COVER LINES OR DISCONNECT SERVICE TO NEARBY POWER LINES SHALL BE AT THE CONTRACTOR'S EXPENSE.
28. TREES TO REMAIN IN PLACE SHALL BE ROPED OFF DURING GRADING OPERATIONS TO KEEP EQUIPMENT AWAY FROM ROOT SYSTEMS. THE CONTRACTOR SHALL MAKE SELECT CUTTING OF TREES AND THE BEST PRACTICES FIRST, THAT ARE MANDATORY FOR WATER LINE CONSTRUCTION. TOWN'S DECISION SHALL BE FINAL ON DETERMINATION OF WHICH TREES SHALL BE CUT.
29. THE CONTRACTOR SHALL BE RESPONSIBLE FOR THE REMOVAL, DISPOSAL, AND REPLACEMENT OF ANY EXISTING CONCRETE THRUST BLOCKING ON EXISTING WATER LINES REQUIRED FOR CONNECTION OF NEW WATER LINES AND APPURTENANCES AT NO ADDITIONAL COST TO THE OWNER.
30. ABANDON EXISTING WATER LINES IN PLACE IN ACCORDANCE WITH SPEC. SECTION 02060 ONCE NEW WATER LINE IS PLACED INTO SERVICE.
31. DEFLECT PIPE JOINTS AS REQUIRED TO MAINTAIN WATER LINE ALIGNMENT AS SHOWN.
32. WATER MAIN LOCATIONS AND WATER SERVICE LATERAL SIZES SHOWN ON THE DRAWINGS ARE APPROXIMATE. PROVIDE NEW SERVICE LATERALS, WATER METERS, METER BOXES, AND ALL APPURTENANCES AS REQUIRED TO MATCH EXISTING SIZE FOR COMPLETE AND OPERABLE WATER SERVICE. LOCATIONS OF EXISTING WATER MAINS ARE INDICATED ON THE DRAWINGS OF NOT. IF THE EXISTING WATER METER IS LOCATED BETWEEN THE ROADWAY AND THE NEW WATER LINE, RELOCATE FOR THE NEW METER BOX TO THE BACK SIDE OF THE NEW WATER MAIN AND REMOVE THE OLD METER AND BOX. RETURN ALL OLD METERS TO OWNER. OPEN CUTTING FOR THE NEW WATER MAIN AND THE METER SHALL BE ALLOWED ONLY ON TOWN STREETS. ALL WATER SERVICE SHUTDOWNS SHALL BE APPROVED BY AND COORDINATED WITH THE PROPERTY OWNER AND THE OWNER.
33. ALL TRENCHES SHALL BE BACKFILLED WITH PIPE BEDDING MATERIAL TO THE TOP OF THE PIPE AND THEN COMPACTED SOIL MATERIAL MEETING THE REQUIREMENTS OF SPEC. SECTION 02200.
34. CONTRACTOR SHALL PROVIDE NEW ASPHALT FOR PATCHING. PROVIDE ADDITIONAL ASPHALT TO MAINTAIN POSITIVE DRAINAGE. PROVIDE WELDED EDGE FOR SMOOTH TRANSITIONS.

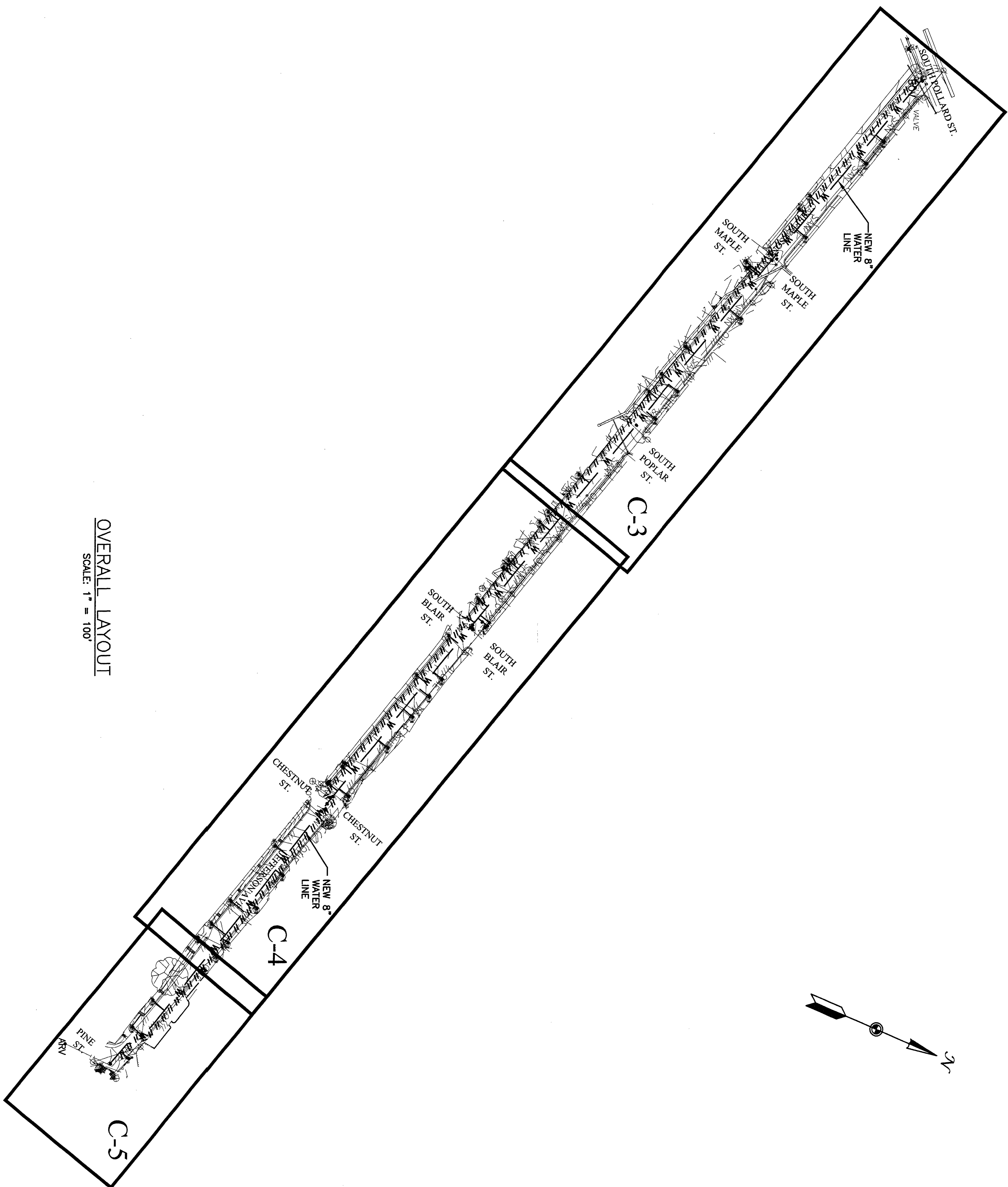

06-15-23

IF THIS DRAWING IS A REDUCTION  
GRAPHIC SCALE MUST BE USED

SCALE: 1" = 100'

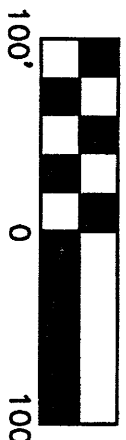
[illegible]