

SANITARY SEWER SCHEDULE:

- BLDG - (A) 5 LF OF 6" SDR-35 PVC AT 4.00%
(INV. AT BLDG. 923.2)
- (A) PRIVATE S.S. C.O. W/TRAFFIC BEARING LID
TOP= 926.9
INV.= 923.0
- (A) - (B) 18 LF OF 6" SDR-35 PVC AT 3.30%
- (B) 1,500 GALLON GREASE TRAP W/TRAFFIC BEARING LIDS
TOP=926.33
INV.=922.4
- (B) - (C) 5 LF OF 6" SDR-35 PVC AT 4.42%
- (C) SAMPLING MANHOLE W.V.W.A. ST'D S-1
TOP= 925.84
INV. IN=922.0
INV. OUT=921.9
- (C) - (F) 7 LF OF 6" SDR-35 PVC AT 3.08%
- BLDG - (D) 5 LF OF 6" SDR-35 PVC AT 4.00%
(INV. AT BLDG. 923.2)
- (D) PRIVATE S.S. C.O. W/TRAFFIC BEARING LID
TOP=926.9
INV.=923.0
- (D) - (E) 35 LF OF 6" SDR-35 PVC AT 2.82%
- (E) PRIVATE S.S. C.O. W/TRAFFIC BEARING LID
TOP=925.66
INV.=922.2
- (E) - (F) 10 LF OF 6" SDR-35 PVC AT 1.98%
- (F) PRIVATE S.S. C.O. W/TRAFFIC BEARING LID
TOP=25.49
INV.=921.7
- (F) - (G) 26 LF OF 6" SDR-35 PVC AT 5.33%
- (G) PUBLIC S.S. C.O. W/TRAFFIC BEARING LID
TOP=923.76
INV.=920.3
- (G) - (EX) 13 LF OF 6" SDR-26 PVC AT 1.56%
INV. OUT= 920.1

NOTES:

1. G.C. TO CONFIRM & COORDINATE ALL BUILDING TIE-IN LOCATIONS WITH M.E.P. AND ARCHITECTURAL DRAWINGS PRIOR TO CONSTRUCTION OF LATERALS.
2. G.C. TO CONFIRM ALL TIE-IN LOCATIONS TO EXISTING LINES PRIOR TO CONSTRUCTION AND NOTIFY THE ENGINEER OF ANY DISCREPANCIES.

STORM STRUCTURE SCHEDULE:

- 1 VDOT ST'D DI-1
TOP: 925.95
INV. OUT: 921.2
- 2 43 LF OF 15" TYPE S
HDPE PIPE AT 2.07%
- 3 VDOT ST'D MH-1
TOP: 926.44
INV. IN: 922.0 (6" ROOF LEADER)
INV. IN: 920.3
INV. OUT: 920.2
- 4 94 LF OF 15" TYPE S
HDPE PIPE AT 1.70%
- 5 VDOT ST'D DI-3A CURB INLET
TOP: 924.58
INV. IN: 918.6
INV. OUT: 918.5
- 6 35 LF 15" TYPE S
HDPE PIPE AT 4.26%
- 7 VDOT ST'D DI-3B CURB INLET
(6" THROAT)
TOP: 922.61
INV. IN: 917.0
INV. OUT: 915.5
- 8 40 LF 15" TYPE S
HDPE PIPE AT 1.76%
- 9 VDOT ST'D DI-1
TOP: 919.51
INV. IN: 914.8
INV. OUT: 914.7
- 10 24 LF 15" CL. III RCP
AT 2.12%
- 11 37 LF 6" SCH. 40 PVC
PIPE AT MIN. 2.00%
INV. OUT 922.0 (STR. 3)
- EX. CURB INLET A
EX. TOP: 919.0
NEW INV. IN: 914.2
EX. INV. IN: 914.9 (T.B.R.)
EX. INV. OUT: 913.2

NOTES:

1. VDOT STD IS-1 INLET SHAPING SHALL BE PROVIDED IN ALL PROPOSED STRUCTURES
2. NON-SHRINK GROUT SHALL BE USED FOR ALL STORM SEWER PIPE CONNECTIONS.

PROPOSED STORM 1-EX PROFILE

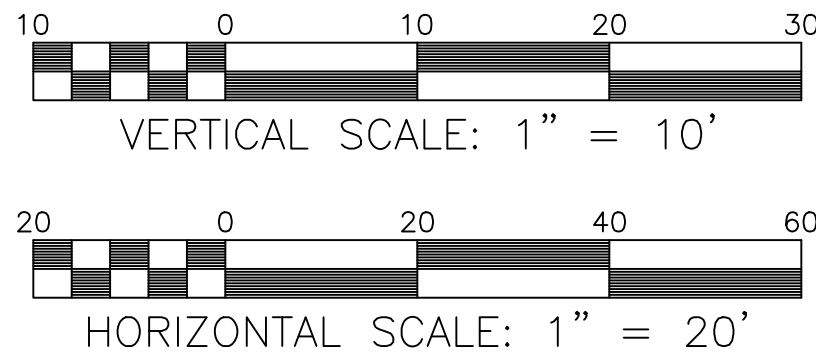
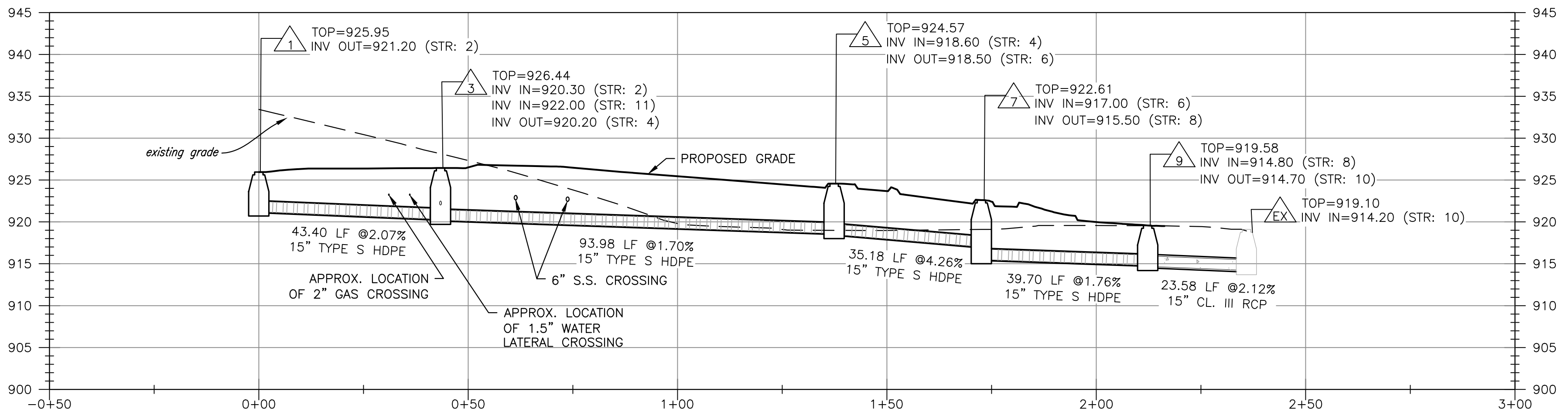

City of Roanoke
Planning, Building, & Development

COMPREHENSIVE DEVELOPMENT PLAN

APPROVED

by Ken Richardson 07/13/2021

UTILITY NOTES:

1. G.C. SHALL COORDINATE THE EXACT SANITARY SEWER, WATER, AND STORM SEWER BUILDING TIE-IN LOCATIONS WITH THE ARCHITECTURAL PLANS.
2. ALL UTILITY SERVICE LATERALS OR LINES, INCLUDING ELECTRIC, SHALL BE INSTALLED UNDERGROUND PER SECTION 36.2-610. WATER & SEWER CONNECTIONS SHALL CONFORM TO WWA UTILITY STANDARDS AND INTERNATIONAL BUILDING CODE.
3. THE G.C. SHALL COORDINATE TEMPORARY POWER FOR THE PROPOSED BUILDING AS REQ'D.
4. G.C. SHALL PROVIDE ALL REQUIRED COORDINATION, MATERIALS, AND INSTALLATION TIMING BETWEEN AEP, ROANOKE GAS, AND OTHER PROVIDERS.

GENERAL W.V.W.A. NOTES:

1. ALL CONSTRUCTION METHODS AND MATERIALS SHALL CONFORM TO THE LATEST WWA DESIGN AND CONSTRUCTION STANDARDS.
2. THE CONTRACTOR OR DEVELOPER IS REQUIRED TO NOTIFY THE WESTERN VIRGINIA WATER AUTHORITY IN WRITING AT LEAST THREE (3) DAYS PRIOR TO ANY CONSTRUCTION PLEASE CONTACT MARK SINK AT (540) 537-3460.
3. ALL WORK SHALL BE SUBJECT TO INSPECTION BY THE WESTERN VIRGINIA WATER AUTHORITY.
4. FIELD CORRECTIONS SHALL BE APPROVED BY THE WESTERN VIRGINIA WATER AUTHORITY PRIOR TO THE START OF CONSTRUCTION.
5. THE CONTRACTOR SHALL MAINTAIN A MINIMUM OF 18" CLEARANCE VERTICALLY AND 2' MINIMUM HORIZONTALLY FROM OUTSIDE OF PIPE TO OUTSIDE OF PIPE AT ALL WATER, SANITARY SEWER CROSSINGS OF ANY OTHER UTILITIES. WHERE THIS CANNOT BE ACHIEVED ADDITIONAL MEASURES IN ACCORDANCE WITH WWA STANDARDS SHALL BE ENFORCED.
6. IT IS THE CONTRACTOR'S RESPONSIBILITY TO HAVE ALL EXISTING UTILITIES LOCATED AND POTHOLED TO VERIFY LOCATIONS. THIS PLAN REVIEW DOES NOT REMOVE THE OWNER'S RESPONSIBILITY TO RELOCATE ANY UNKNOWN EXISTING CONFLICTS FOUND DURING CONSTRUCTION WITH THE PROPOSED UTILITY CONSTRUCTION.
7. REFER TO PLAN SET AND WWA DETAILS FOR SPECIFIC CONSTRUCTION STANDARDS.
8. ALL PAVEMENT IN THE PUBLIC RIGHT OF WAY SHALL BE RESTORED BASED ON THE CITY OF ROANOKE RIGHT OF WAY EXCAVATION AND RESTORATION STANDARDS.

W.V.W.A. WATER NOTES:

1. ALL WATER CONNECTIONS TO EXISTING LINES SHALL BE COORDINATED WITH AND PERFORMED BY THE WESTERN VIRGINIA WATER AUTHORITY. G.C. SHALL PROVIDE ALL MATERIALS REQUIRED FOR THE PROPOSED WATERLINE INCLUDING THE TAPPING SLEEVE AND VALVE. WWA TO PERFORM THE ACTUAL TAP ON THE EXISTING WATERLINE.
2. ALL WATER AND SANITARY SEWER FACILITIES ARE TO BE INSTALLED ACCORDING TO THE WESTERN VIRGINIA WATER AUTHORITY DESIGN AND CONSTRUCTION STANDARDS.
3. .G.C. SHALL PROVIDE 5 DAYS NOTICE TO THE WWA FOR ANY ANTICIPATED WATER OUTAGE TO ALLOW THE WWA TIME TO SCHEDULE AND NOTIFY AFFECTED CUSTOMERS. (540) 537-3460
4. CONTRACTOR TO FURNISH AND INSTALL ALL MATERIALS, TAP TO BE MADE BY WWA. CONTRACTOR SHALL BE RESPONSIBLE FOR EXCAVATION AND SHORING PER OSHA REGULATIONS.

W.V.W.A. SANITARY SEWER NOTES:

1. ALL SANITARY SEWER CONNECTIONS TO EXISTING LINES SHALL BE COORDINATED WITH AND PERFORMED BY THE WESTERN VIRGINIA WATER AUTHORITY.
2. ALL WATER AND SANITARY SEWER FACILITIES ARE TO BE INSTALLED ACCORDING TO THE WESTERN VIRGINIA WATER AUTHORITY DESIGN AND CONSTRUCTION STANDARDS.
3. SANITARY SEWER TAP TO EXISTING MANHOLE TO BE MADE BY CONTRACTOR AND COORDINATED WITH W.V.W.A. MANHOLE CONNECTION MUST BE CORED WITH A FLEXIBLE BOOT INSTALLED.

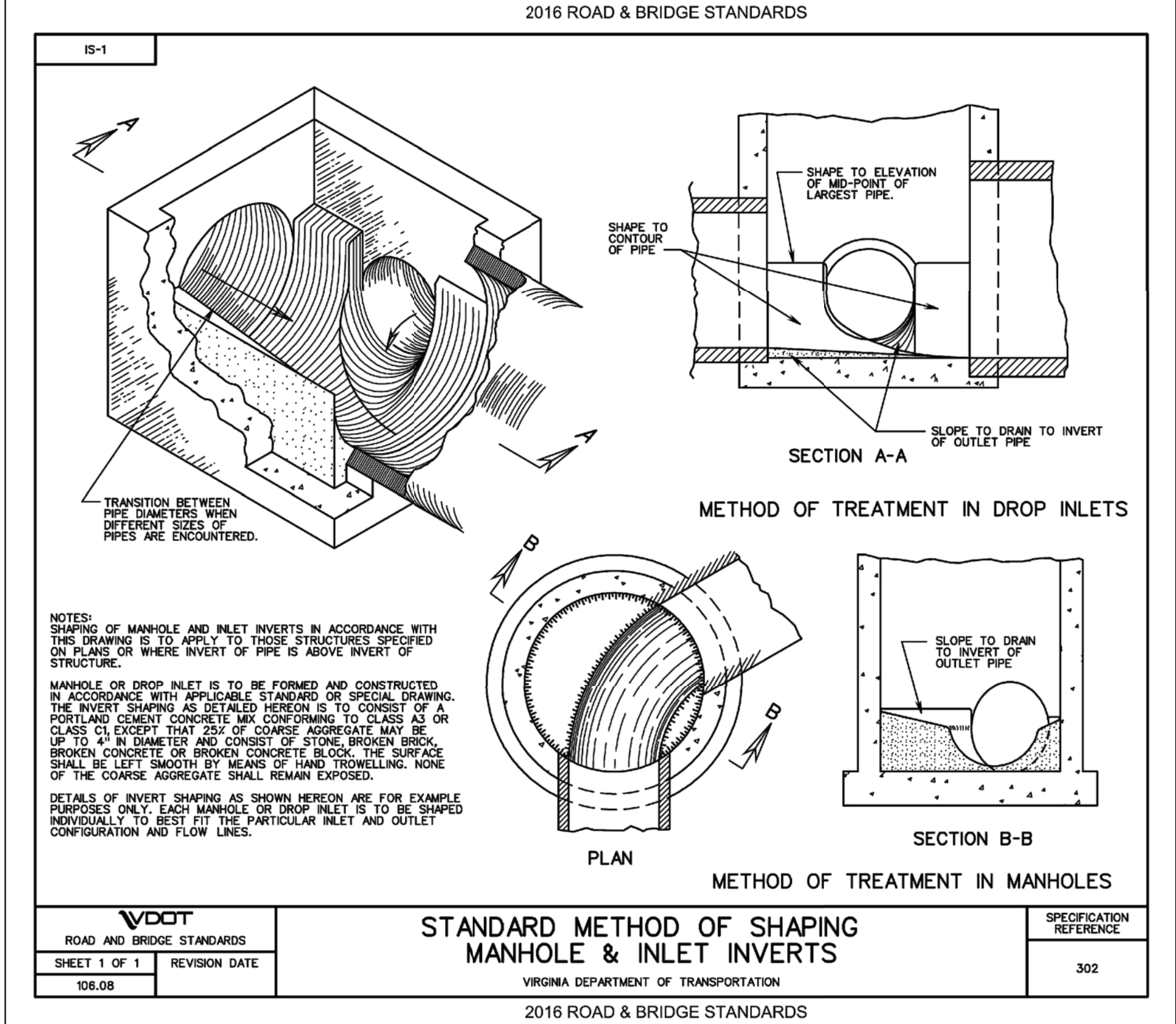
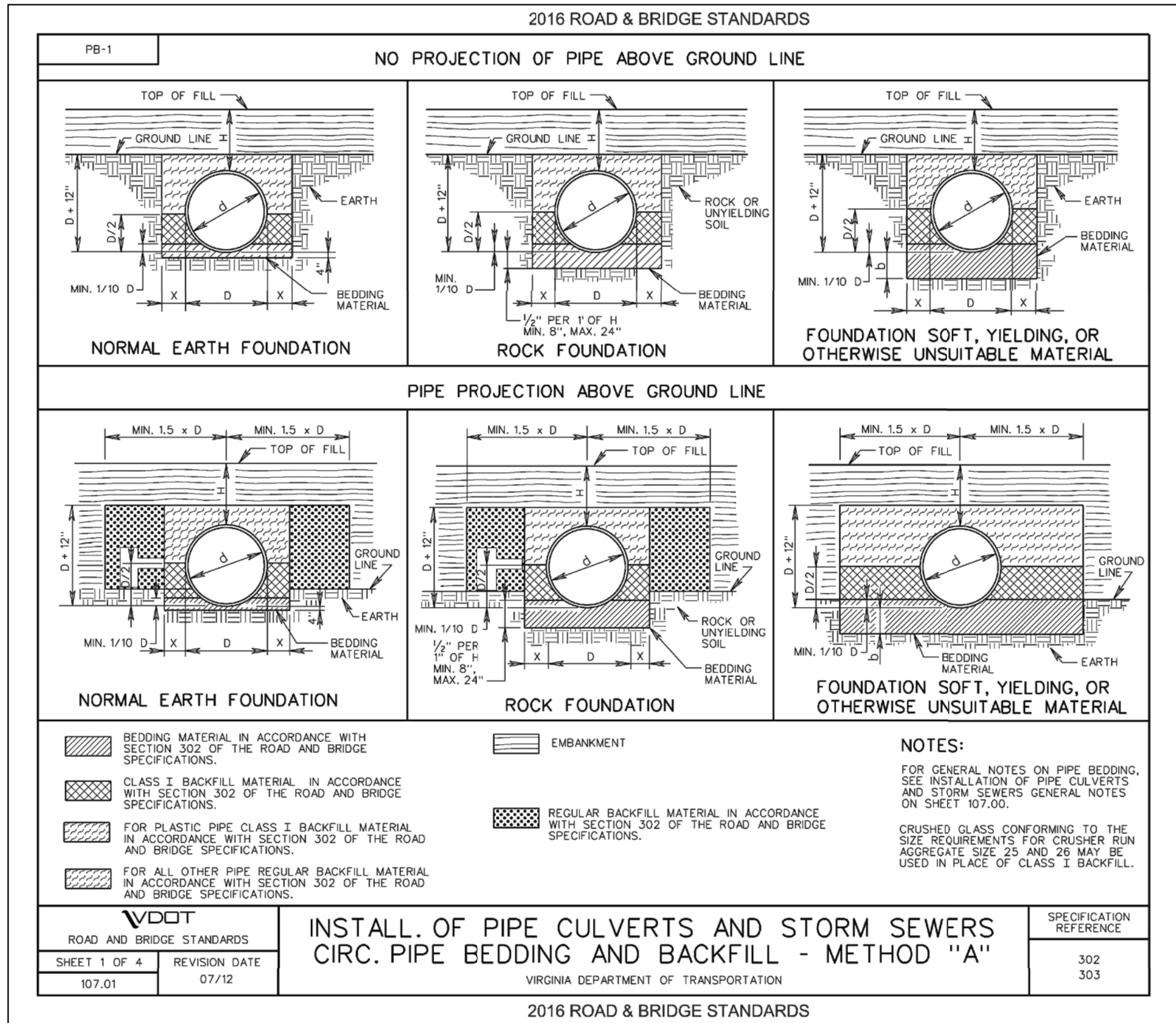

BALZER & ASSOCIATES
PLANNERS / ARCHITECTS
ENGINEERS / SURVEYORS

Roanoke / Richmond
New River Valley / Staunton
Harrisonburg / Lynchburg
www.balzer.cc

1208 Corporate Circle
Roanoke, VA 24018
540.772.9580

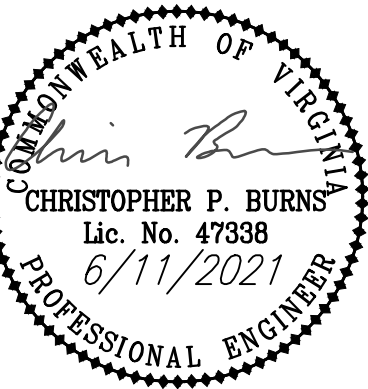

LITTLE CAESARS ORANGE AVENUE

UTILITY PROFILES

DRAWN BY KAM
DESIGNED BY BTC
CHECKED BY BTC
DATE 6/11/2021
SCALE AS SHOWN
REVISIONS

C9
PROJECT NO. 04180041.00