

**TYPICAL FOOTING CROSS SECTION**  
SCALE: 1" = 1'-0"

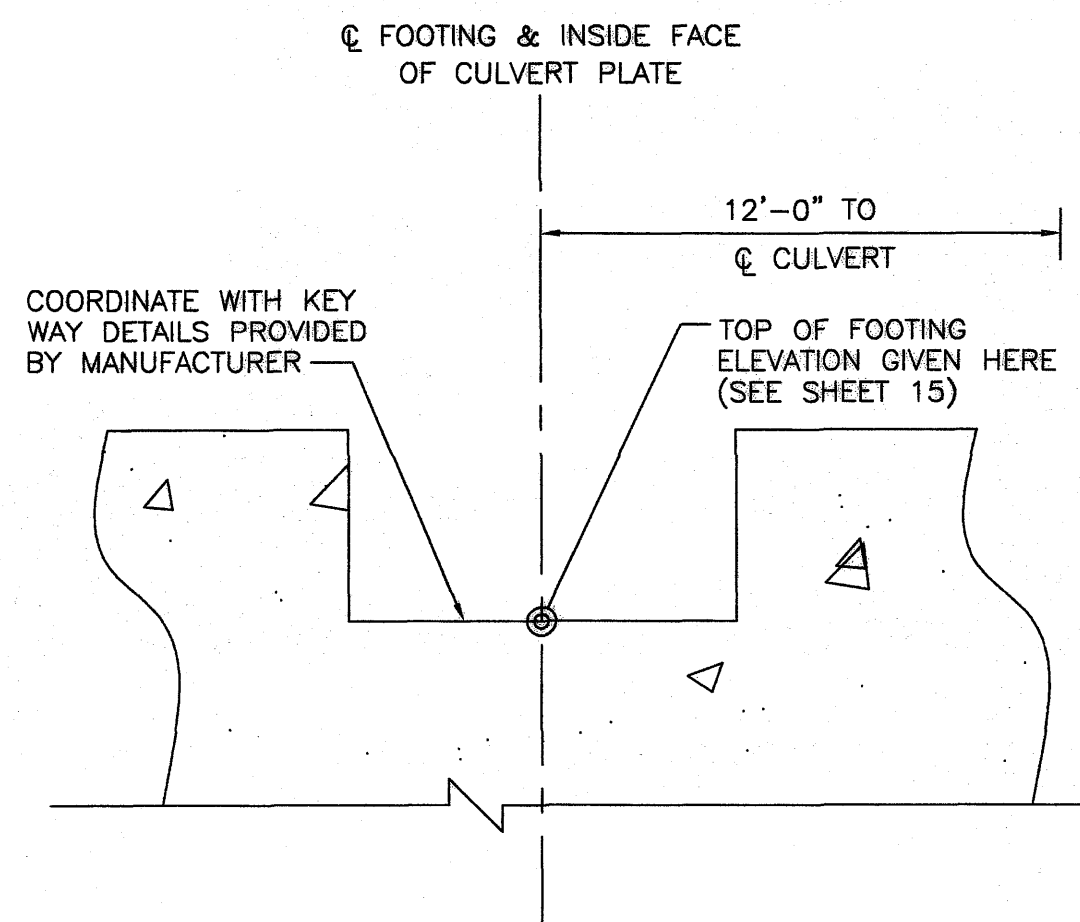

**KEYWAY DETAIL**  
NOT TO SCALE

NAME	SIZE	LENGTH
A	NO. 5	4'-0"
B	NO. 4	4'-0"
C	NO. 4	6'-10"
D	NO. 4	VARIES *

\* NOTE:

NO. 4 LONGITUDINAL BARS SHALL BE CONTINUOUS FOR ENTIRE LENGTH OF FOOTING WITH LAP SPLICE OF 2'-2" WHERE REQUIRED.

**PLAN NOTES:**

1. CONCRETE IN FOOTING SHALL BE CLASS A3 IN ACCORDANCE WITH SECTION 207 OF VDOT ROAD AND BRIDGE SPECIFICATIONS (2002). CONCRETE PLACEMENT SHALL CONFORM TO SECTION 404 OF VDOT ROAD AND BRIDGE SPECIFICATIONS (2002).
2. DEFORMED REINFORCING BARS SHALL CONFORM TO ASTM A615, GRADE 60.
3. FOOTING SHALL REST ON SOLID ROCK. BEARING CAPACITY OF FOUNDATION SHALL BE 5.5 TONS/SQFT. MINIMUM.
4. SEE SHEET 15 FOR CULVERT LAYOUT AND PROFILE DETAILS.
5. FOOTING CONSTRUCTION SHALL BE COORDINATED WITH STRUCTURAL PLATE ARCH CULVERT FINAL DETAILS AS PROVIDED BY MANUFACTURER.

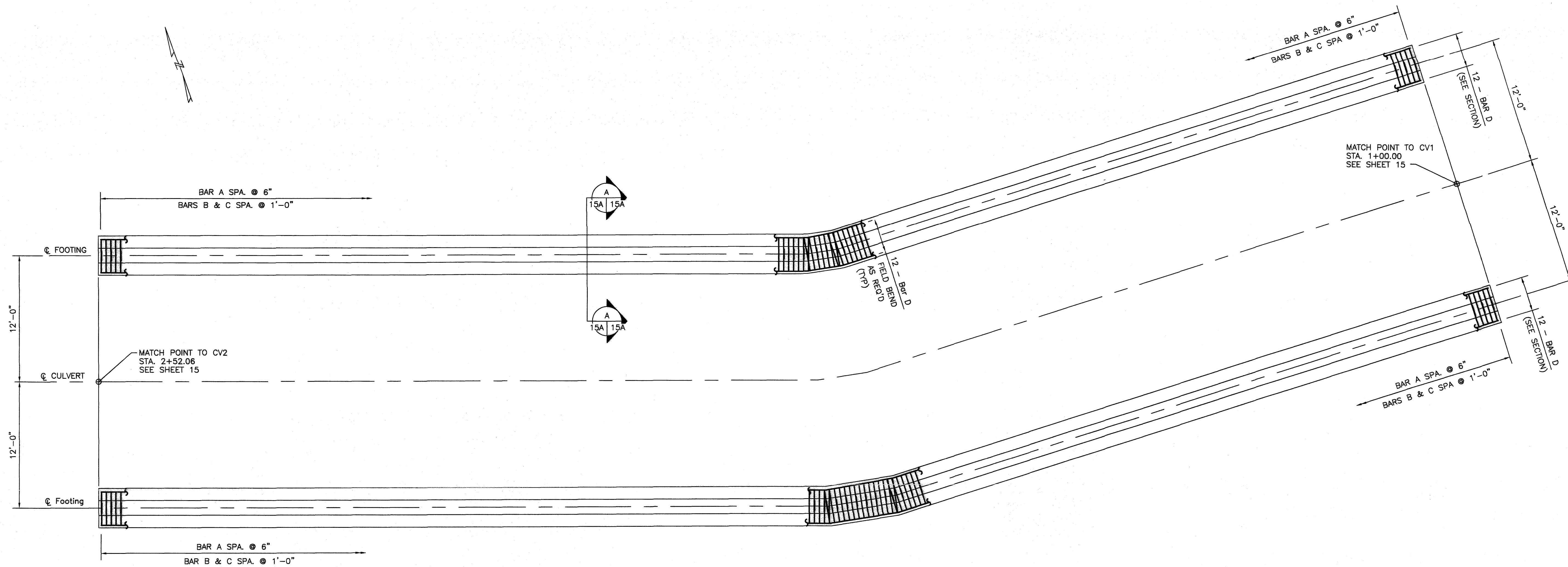

**FOOTING PLAN VIEW**  
NOT TO SCALE

**LUMSDEN ASSOCIATES, P.C.**  
ENGINEERS-SURVEYORS-PLANNERS  
ROANOKE, VIRGINIA

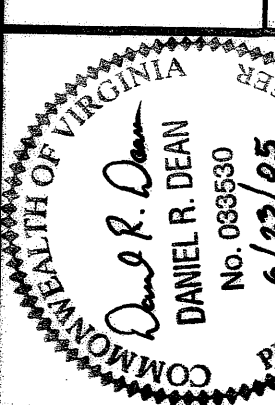
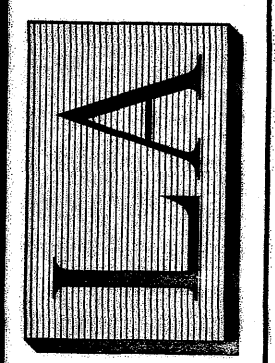

STRUCTURAL PLATE  
ARCH FOUNDATION DETAILS



SECTION No. 1  
**MASON'S CREST**  
PREPARED FOR  
**RADFORD & COMPANY**  
CAVE SPRING INDUSTRIAL DISTRICT  
ROANOKE COUNTY, VIRGINIA

REVISIONS	DATE	DESCRIPTION
1		
2		
3		
4		
5		

DESIGN PREPARED BY  
**HSM**  
ARCHITECTS ENGINEERS PLANNERS  
HAYES, SEAY, MATTERN & MATTERN, INC.  
1315 FRANKLIN ROAD  
ROANOKE, VA 24016  
(540) 857-3100 WWW.HSM.COM

DATE: JUNE 20, 2005  
SCALE: AS NOTED  
COMMISSION NO.: 04-136  
SHEET 15A OF 18