

- NOTES:
- SURVEY PROVIDED BY CALDWELL WHITE AND ASSOCIATES.
 - BASE MAPPING BASED UPON AERIAL MAPPING PROVIDED BY ROANOKE COUNTY AND CITY OF ROANOKE.
 - CONTRACTOR SHALL FIELD VERIFY SIZE & INVERT OF ALL LATERALS, SUBMANS, & MAINS AND PROVIDE INFORMATION AS PART OF SHOP DRAWING SUBMITTAL.
 - LATERALS IN POOR CONDITION AS IDENTIFIED BY THE AUTHORITY CONNECTING TO THE EXISTING INTERCEPTOR SHALL BE REPLACED TO THE PERMANENT EASEMENT. PAYMENT SHALL BE IN ACCORDANCE WITH SPECIFICATION 01026. SEWER SERVICE LATERALS SHALL BE REPLACED TO THE PERMANENT EASEMENT BOUNDARY. CONTRACTOR SHALL CONFIRM SIZE AND LOCATION AND REPLACE W/IDENTICAL SIZE.
 - ALL LATERALS TO HAVE A CLEANOUT INSTALLED AT THE PROPERTY LINE AS SHOWN IN DETAIL C503.5/TYP.
 - CONTRACTOR SHALL REMOVE ONLY THOSE TREES REQUIRED FOR SEWER INTERCEPTOR CONSTRUCTION. ALL TREES WITHIN THE EASEMENT 12" AND LARGER SHALL BE PROTECTED IN ACCORDANCE WITH DETAIL C505.5. ONLY THOSE TREES NOTED ON THE DRAWINGS SHALL BE REMOVED IF REQUIRED. ALL COSTS FOR TREE REMOVAL, DISPOSAL, & PROTECTION SHALL BE INCLUDED IN THE COST FOR SEWER LINE INSTALLATION.
 - EXIST LATERALS, SUBMANS, & MAINS HAVE BEEN IDENTIFIED BY MANHOLE INSPECTIONS PERFORMED BY OI AND FIELD INVESTIGATION BY THE AUTHORITY'S SSER GROUP. ALL ACTIVE SEWER LATERALS SHALL REMAIN IN SERVICE AND BE RECONNECTED BY THE CONTRACTOR..
 - LIMITS OF CLEARING & GRADING ARE LIMITED TO WITHIN THE PERMANENT EASEMENT.

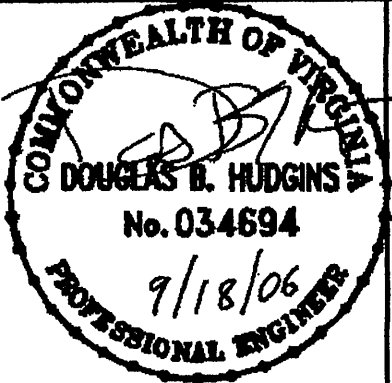

OLVER INCORPORATED
Consulting Engineers & Planners
1116 SOUTH MAIN STREET, SUITE 100
BLACKSBURG, VIRGINIA 24060
(540) 552-5548

WESTERN VIRGINIA WATER AUTHORITY
MUDLICK CREEK INTERCEPTOR
PLAN
STATION 77+00.00 THRU 84+00.00

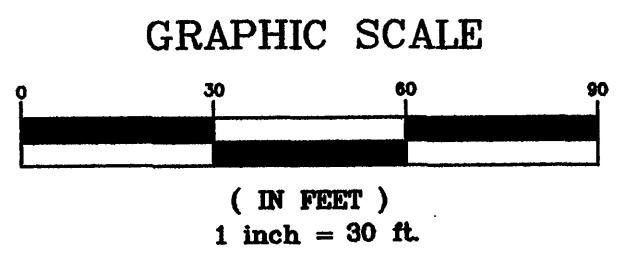
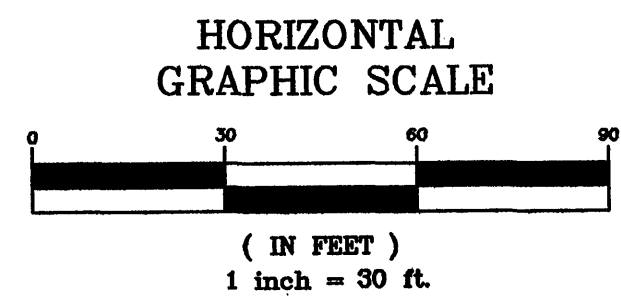
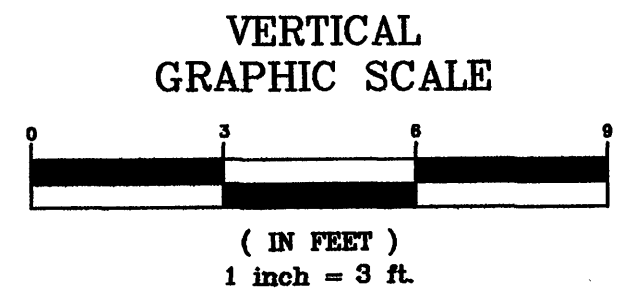
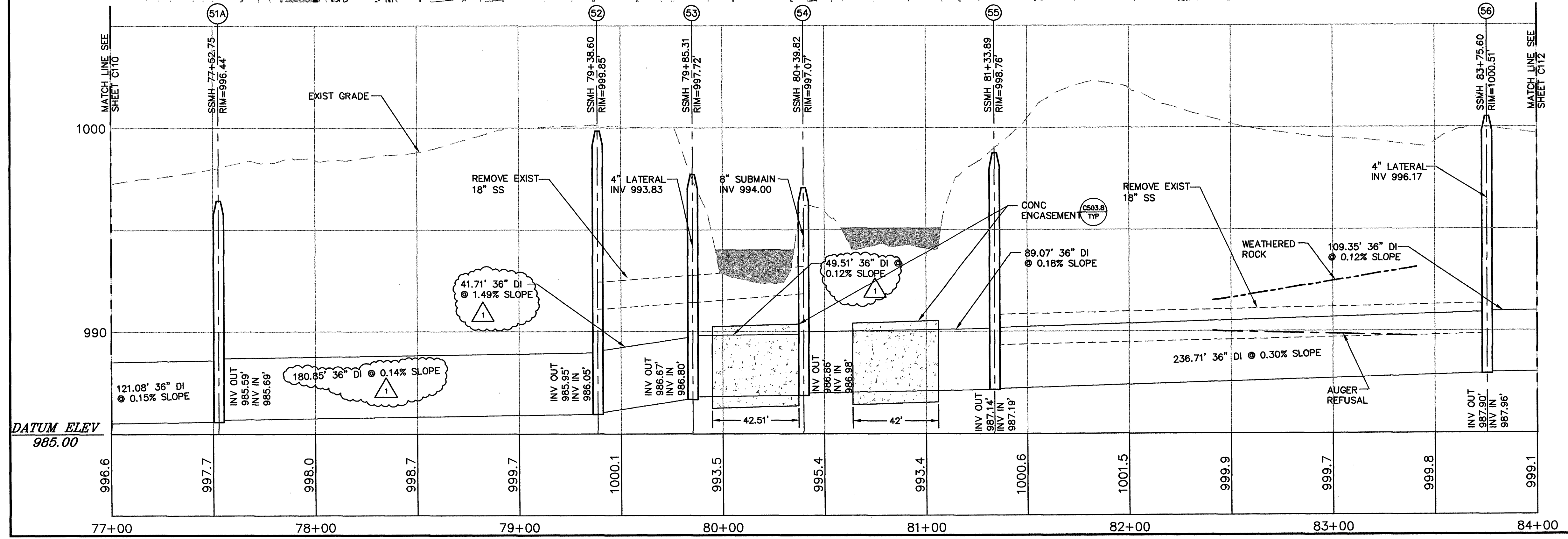

VERIFY SCALE

Bar Scale measures 1" on original drawing

Rev.	Description	Date	By
3	AS-BUILTS	10/16/08	DBH
1	FIELD ORDER NO. 2	2/21/07	DBH
0	AS-BID DOCUMENTS	11/20/06	DBH

Designed: BYP
Drawn: R/JH
Checked: DBH
Date: FEB 2006
Scale: AS SHOWN
Job No. 12307.01
Archived File Name:

C111

I:\DWG\WVA\12307.01\Production\AS-BUILTS\C111.dwg, 3/22/08, 12:32:15, J31, RW, c008e