

DEVELOPMENT PLAN
FOR
NORTH VALLEY
SEVENTH DAY ADVENTIST

*SITUATED IN
CATAWBA MAGISTERIAL DISTRICT
ROANOKE COUNTY, VIRGINIA*

DATE: 1 JUNE 2004
 "AS-BUILT" - 30 AUGUST 2004
 PREPARED FOR

STRUCTURES DESIGN/BUILD

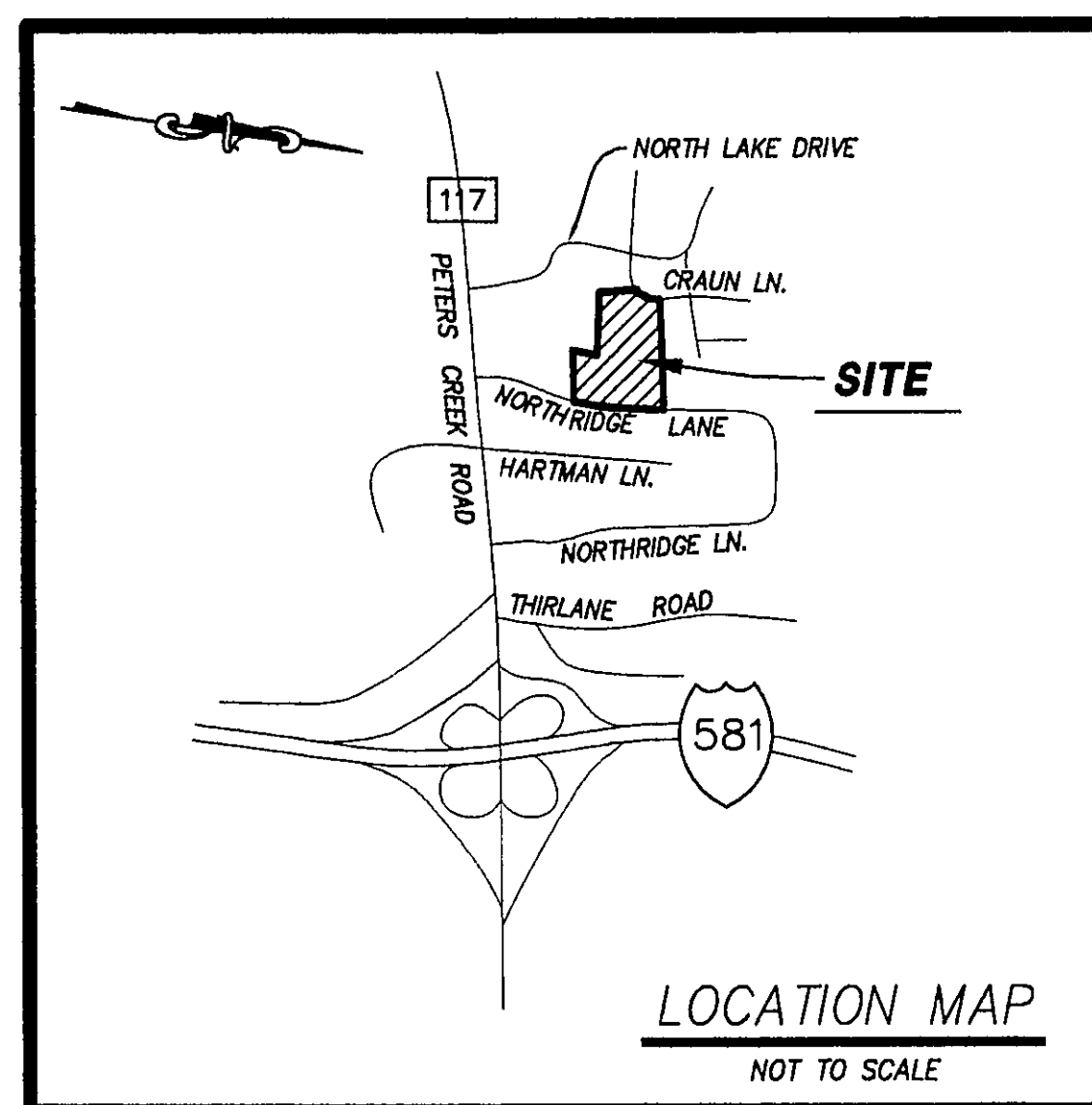

--INDEX OF DRAWINGS--

<i>SHEET No.</i>	<i>DESCRIPTION</i>
------------------	--------------------

1. LUMSDEN ASSOCIATES COVER SHEET
2. ROANOKE COUNTY STD. COVER SHEET
3. RECORD PLAT
4. NOTES & DETAILS
5. DIMENSIONAL LAYOUT
6. GRADING PLAN
7. PROFILES
8. LANDSCAPING PLAN
9. EROSION AND SEDIMENT CONTROL PLAN
10. EROSION AND SEDIMENT CONTROL DETAILS

I AM CERTIFIED BY THE STATE OF VIRGINIA AS A "RESPONSIBLE LAND DISTURBER". I SHALL BE RESPONSIBLE FOR THE IMPLEMENTATION OF THE EROSION AND SEDIMENT CONTROL PLAN AS SHOWN.

SIGNATURE:
PRINTED NAME:
CERTIFICATE No.:
EXPIRATION DATE:
TELEPHONE No.:
ADDRESS:



LUMSDEN ASSOCIATES, P.C.
ENGINEERS-SURVEYORS-PLANNERS

4664 BRAMBLETON AVENUE, SW
P.O. BOX 20669
ROANOKE, VIRGINIA 24018

PHONE: (540) 774-4411
FAX: (540) 772-9445
E-MAIL: MAIL@LUMSDENPC.COM

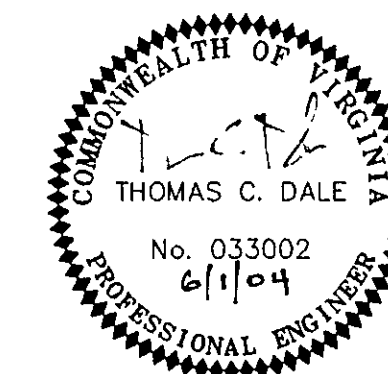

“AS-BUILT”

NOTE:

1. "AS BUILT" INFORMATION TAKEN FROM
PLAN FURNISHED BY J. P. TURNER &
BROTHERS, INC., GENERAL CONTRACTOR.
2. "AS-BUILT" DIMENSIONS SHOWN IN BRACKETS.

REVISIONS	
DATE	SHEETS

COMMISSION NO: 03-360

SHEET 1 OF 10