

KNOW ALL MEN BY THESE PRESENTS TO WIT:

THAT ECHO SENTINEL GROUP, LLC, IS THE FEE SIMPLE OWNER OF THE PARCEL OF LAND SHOWN HEREON, BOUNDED ON THE OUTSIDE BY CORNERS 1, 2, 3, 4 TO 1, CONTAINING 0.8746 ACRE, AND BEING A PORTION OF THE LAND CONVEYED TO SAID OWNER BY INSTRUMENT DATED JANUARY 16, 2007 AND RECORDED IN THE CLERK'S OFFICE OF THE CIRCUIT COURT OF THE CITY OF ROANOKE, VIRGINIA IN INSTRUMENT NUMBER 070000732.

THAT NORFOLK SOUTHERN RAILWAY COMPANY IS THE FEE SIMPLE OWNER OF THE PARCEL OF LAND SHOWN HEREON, BOUNDED ON THE OUTSIDE BY CORNERS 5, 6, 7, 3 TO 5, CONTAINING 0.5675 ACRE, AND BEING A PORTION OF THE LAND CONVEYED TO SAID OWNER BY DEED DATED JUNE 27, 1918 AND RECORDED IN THE CLERK'S OFFICE OF THE CIRCUIT COURT OF THE COUNTY OF ROANOKE, VIRGINIA IN DEED BOOK 90, PAGE 190.

THE SAID OWNERS HEREBY CERTIFY THAT THEY HAVE SUBDIVIDED THE LANDS SHOWN HEREON ENTIRELY OF THEIR OWN FREE WILL AND ACCORD AS REQUIRED BY SECTION 15.2-2240 THROUGH 15.2-2279 OF THE 1950 CODE OF VIRGINIA AS AMENDED TO DATE, AND AS REQUIRED BY THE CITY OF ROANOKE, VIRGINIA SUBDIVISION ORDINANCE AS AMENDED TO DATE.

WITNESS THE SIGNATURES AND SEALS OF SAID OWNERS:

H. Joseph Lohkamp 4/15/08
ECHO SENTINEL GROUP, LLC - AUTHORIZED AGENT
(INSTRUMENT NUMBER 070000732) DATE

H. Joseph Lohkamp D-P
AUTHORIZED AGENT - PRINT NAME - TITLE

P. G. Carrou 5/1/08
NORFOLK SOUTHERN RAILWAY COMPANY - AUTHORIZED AGENT
(D.B. 90, PG. 190) DATE

P.G. CARROU - ASSISTANT VICE PRESIDENT - REAL ESTATE
AUTHORIZED AGENT - PRINT NAME - TITLE

STATE OF VIRGINIA

City of Roanoke

TO WIT:
I, MARGARET S. CONNER, A NOTARY PUBLIC
IN AND FOR THE AFORESAID STATE DO HEREBY CERTIFY THAT
H. JOSEPH LOHKAMP, WHOSE NAME IS SIGNED TO
THE FOREGOING WRITING HAS PERSONALLY APPEARED BEFORE ME AND
ACKNOWLEDGED THE SAME IN MY AFORESAID JURISDICTION ON THIS
15TH DAY OF APRIL, 2008.

MY COMMISSION EXPIRES JUNE 30, 2011
Margaret S. Conner 165997
NOTARY PUBLIC NOTARY REGISTRATION NUMBER

STATE OF GEORGIA

County of Fulton

TO WIT:
I, VIRGINIA L. MOODY, A NOTARY PUBLIC
IN AND FOR THE AFORESAID STATE DO HEREBY CERTIFY THAT
P.G. CARROU, WHOSE NAME IS SIGNED TO
THE FOREGOING WRITING HAS PERSONALLY APPEARED BEFORE ME AND
ACKNOWLEDGED THE SAME IN MY AFORESAID JURISDICTION ON THIS
1ST DAY OF MAY, 2008.

MY COMMISSION EXPIRES
Virginia L. Moody
NOTARY PUBLIC NOTARY REGISTRATION NUMBER

IN THE CLERK'S OFFICE OF THE CIRCUIT COURT OF THE CITY OF ROANOKE, VIRGINIA, THIS MAP WAS PRESENTED WITH THE CERTIFICATE OF ACKNOWLEDGEMENT THEREON ATTACHED ADMITTED TO RECORD AT 10:16 O'CLOCK A.M. ON THIS 6 DAY OF MAY, 2008.

TESTE: BRENDA HAMILTON
CLERK
BY: Frank B. Caldwell, III
DEPUTY CLERK

NOTES:

1. THIS PLAT WAS PREPARED WITHOUT THE BENEFIT OF A CURRENT TITLE REPORT BY A LICENSED ATTORNEY. THERE MAY EXIST ENCUMBRANCES NOT SHOWN WHICH AFFECT THE SUBJECT PROPERTY.
2. THE SUBJECT PROPERTY LIES WITHIN ZONE "X" AS SHOWN ON THE FEMA FLOOD INSURANCE RATE MAP NO. 51161C0163G, DATED SEPTEMBER 28, 2007.
3. REFERENCE: PLAT OF SURVEY FOR ECHO SENTINEL, LLC BY ACS DESIGN, DATED DECEMBER 26, 2006.
4. REFERENCE: COMBINATION PLAT FOR UNIFIED HUMAN SERVICES BY LMW P.C., DATED MAY 7, 2003, RECORDED IN M.B. 1, PG. 2584, SHOWING LOTS 1-7, BLOCK 22 OF "RUNNYMEDE CORP."
5. REFERENCE: NORFOLK & WESTERN RAILWAY COMPANY VALUATION MAP V-10-VA.
6. REFERENCE OF PROPERTY CONVEYANCE:
* INSTRUMENT # 070000732 BEING TAX PARCEL 2510306 CONVEYED TO ECHO SENTINEL GROUP, LLC.
* D.B. 90, PG. 190 (ROANOKE COUNTY) CONVEYED TO NORFOLK SOUTHERN RAILWAY COMPANY
7. THIS PLAT IS BASED ON A CURRENT FIELD SURVEY.
8. THE RECORDATION OF THIS PLAT OF SUBDIVISION DOES NOT CONSTITUTE A CONVEYANCE OF LAND. ANY LOT, PARCEL OR TRACT OF LAND SHOWN HEREON THAT IS INTENDED FOR SALE AND/OR CONVEYANCE MUST BE CONVEYED BY DEED AND SAID DEED MUST BE RECORDED IN THE OFFICE OF THE CLERK OF CIRCUIT COURT OF THE CITY OF ROANOKE.

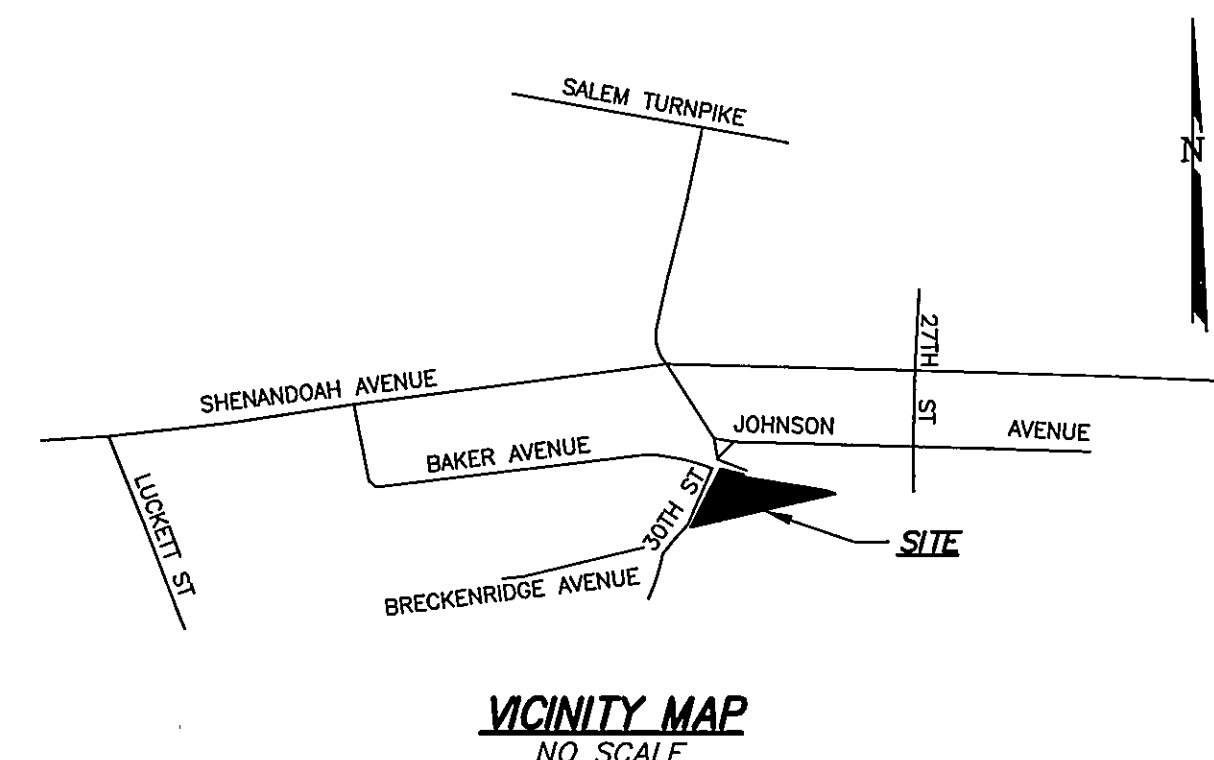

APPROVED: [Signature] 5/5/08
AGENT, ROANOKE CITY PLANNING COMMISSION DATE

COORDINATE LIST (ASSUMED DATUM)		
CORNER	NORTHING	EASTING
1	5000.0000	5000.0000
2	4981.1403	5092.9867
3	4830.8696	5177.8952
4	4755.7601	4879.6372
1	5000.0005	5000.0052
5	4968.1331	5100.3363
6	4919.8814	5434.8119
7	4906.1451	5476.8127

RESUBDIVISION PLAT
FOR
ECHO SENTINEL GROUP, LLC
AND
NORFOLK SOUTHERN RAILWAY COMPANY

SHOWING PARCEL 2 (INSTRUMENT No. 070000732) AND 0.5675 ACRE TO BE ACQUIRED BY ECHO SENTINEL GROUP, LLC FROM NORFOLK SOUTHERN RAILWAY COMPANY (D.B. 90, PG. 190 - ROANOKE COUNTY) CREATING HEREON

PARCEL 2A 1.4419 ACRES

SITUATE BAKER AVENUE, N.W. & 30TH STREET, N.W.
CITY OF ROANOKE, VIRGINIA

CWA
CALDWELL WHITE ASSOCIATES
ENGINEERS / SURVEYORS / PLANNERS
4203 MELROSE AVENUE, NW
P.O. BOX 6260
ROANOKE, VIRGINIA 24017
(540) 366-3400 FAX: (540) 366-8702

REV: FEBRUARY 28, 2008
(CITY COMMENTS)
TAX No. 2510306
DATE: JANUARY 30, 2008
CALC. JW CHK'D FBC
CLOSED: JW

SHEET 1 OF 2

SCALE: 1"= 40'
N.B.: WES-55
DRAWN: JW
W.O.: 08-0001A