

KNOW ALL MEN BY THESE PRESENTS TO WIT:

THAT THE TRUSTEES OF GOD'S HOUSE BAPTIST MINISTRY ARE THE FEE SIMPLE OWNERS OF THE PARCEL OF LAND SHOWN HEREON BOUNDED BY CORNERS 1 THROUGH 10 TO 1, INCLUSIVE, AND BEING ALL OF THE LAND CONVEYED TO SAID OWNER BY INSTRUMENT RECORDED IN THE CLERK'S OFFICE OF THE CIRCUIT COURT OF THE CITY OF ROANOKE, VIRGINIA BY INSTRUMENT NUMBER 060000529.

THAT THE TRUSTEES OF GOD'S HOUSE BAPTIST MINISTRY ARE THE FEE SIMPLE OWNER OF THE PARCEL OF LAND SHOWN HEREON BOUNDED BY CORNERS 7 TO 6 TO 11 TO 12 TO 7, INCLUSIVE, AND BEING ALL OF THE LAND CONVEYED TO SAID OWNER BY INSTRUMENT RECORDED IN THE CLERK'S OFFICE OF THE CIRCUIT COURT OF THE CITY OF ROANOKE, VIRGINIA BY INSTRUMENT NUMBER 040020128.

THE SAID OWNER(S) HEREBY CERTIFIES THAT THE PLAT OF THE LAND AS SHOWN HEREON, AS REQUIRED BY SECTION 15.2-2240 THROUGH 15.2-2279 OF THE CODE OF VIRGINIA (1950) AS AMENDED, AND THE SUBDIVISION ORDINANCE OF THE CITY OF ROANOKE, VIRGINIA; IS ENTIRELY WITH ITS OWN FREE WILL AND CONSENT AND IN ACCORDANCE WITH THE DESIRES OF THE OWNER(S) OR PROPRIETOR(S) OF THE LAND AND THE TRUSTEE(S) IN ANY DEED OF TRUST, OR OTHER INSTRUMENT IMPOSING A LIEN UPON SUCH LAND, IF ANY THERE BE.

IN WITNESS WHEREON ARE HEREBY PLACED THE FOLLOWING SIGNATURES AND SEALS:

TRUSTEES OF GOD'S HOUSE BAPTIST MINISTRIES

Alphonzo L. Holland, Sr.  
ALPHONZO L. HOLLAND, SR. - TRUSTEE

STATE OF VIRGINIA  
COMMONWEALTH AT LARGE

I, FLOYD W. DAVIS, A NOTARY PUBLIC IN  
AND FOR THE AFORESAID STATE DO HEREBY CERTIFY THAT  
ALPHONZO L. HOLLAND, SR., WHOSE  
NAME IS SIGNED TO THE FOREGOING INSTRUMENT, HAS  
PERSONALLY APPEARED BEFORE ME AND ACKNOWLEDGED THE  
SAME ON THIS 6<sup>th</sup> DAY OF AUGUST, 2008.

Floyd W. Davis REG. # 7065145  
NOTARY PUBLIC  
MY COMMISSION EXPIRES 2/28/2010

Roland Crump  
ROLAND CRUMP - TRUSTEE

STATE OF VIRGINIA  
COMMONWEALTH AT LARGE

I, FLOYD W. DAVIS, A NOTARY PUBLIC IN  
AND FOR THE AFORESAID STATE DO HEREBY CERTIFY THAT  
ROLAND CRUMP, WHOSE  
NAME IS SIGNED TO THE FOREGOING INSTRUMENT, HAS  
PERSONALLY APPEARED BEFORE ME AND ACKNOWLEDGED THE  
SAME ON THIS 6<sup>th</sup> DAY OF AUGUST, 2008.

Floyd W. Davis REG. # 7065145  
NOTARY PUBLIC  
MY COMMISSION EXPIRES 2/28/2010

Mable M. Jones  
MABLE JONES - TRUSTEE

STATE OF VIRGINIA  
COMMONWEALTH AT LARGE

I, FLOYD W. DAVIS, A NOTARY PUBLIC IN  
AND FOR THE AFORESAID STATE DO HEREBY CERTIFY THAT  
MABLE JONES, WHOSE  
NAME IS SIGNED TO THE FOREGOING INSTRUMENT, HAS  
PERSONALLY APPEARED BEFORE ME AND ACKNOWLEDGED THE  
SAME ON THIS 6<sup>th</sup> DAY OF AUGUST, 2008.

Floyd W. Davis REG. # 7065145  
NOTARY PUBLIC  
MY COMMISSION EXPIRES 2/28/2010

APPROVED: [Signature] 8/1/08  
AGENT, CITY OF ROANOKE  
PLANNING COMMISSION

IN THE CLERK'S OFFICE OF THE CIRCUIT COURT OF CITY OF ROANOKE,  
VIRGINIA, THIS MAP WITH THE CERTIFICATE OF ACKNOWLEDGMENT  
THEREON IS ADMITTED TO RECORD AT 9:45 O'CLOCK  
A.M. ON THIS 8<sup>th</sup> DAY OF AUGUST, 2008, IN  
MAP BOOK 1, PAGE 3378-A & 3379  
TESTE: BRENDA S. HAMILTON [Signature]  
CLERK DEPUTY CLERK

# NOTES:

1. PARCELS OWNED BY THE TRUSTEES OF GOD'S HOUSE BAPTIST MINISTRY BY THE FOLLOWING DEEDS OF RECORD:

A T.M. #2660101 - 1.5131 ACRES  
3621 MELROSE AVENUE, N.W.  
WESTERN PORTION OF LOT NO. 5; RT. REV. A. VAN DE VYER MAP -  
CITY ENGINEER'S PLAN #3259  
DEEDED AS PART OF PARCEL I  
INSTRUMENT #060000529

B T.M. #2660102 - 1.7301 ACRES  
3619 MELROSE AVENUE, N.W.  
EASTERN PORTION OF LOT NO. 5; RT. REV. A. VAN DE VYER MAP -  
CITY ENGINEER'S PLAN #3259  
DEEDED AS PARCEL III  
INSTRUMENT #060000529

C T.M. #2660130 - 1.2640 ACRES  
3601 MELROSE AVENUE, N.W.  
SOUTHWESTERN PORTION OF LOT NO. 4; RT. REV. A. VAN DE VYER MAP -  
CITY ENGINEER'S PLAN #3259  
INSTRUMENT #040020128

D T.M. #2761601 - 4,669 SF  
ADAMS STREET, N.W.  
LOT 1, BLOCK 24; WASHINGTON HEIGHTS MAP -  
PLAT BOOK 1, PAGE 43 (ROANOKE COUNTY)  
DEEDED AS PART OF PARCEL I  
INSTRUMENT #060000529

E T.M. #2761602 - 5,663 SF  
ADAMS STREET, N.W.  
WEST PART OF LOT 2, BLOCK 24; WASHINGTON HEIGHTS MAP -  
PLAT BOOK 1, PAGE 43 (ROANOKE COUNTY)  
DEEDED AS PART OF PARCEL I  
INSTRUMENT #060000529

F T.M. #2761603 - 6,485 SF  
ADAMS STREET, N.W.  
WEST PART OF LOT 3, BLOCK 24; WASHINGTON HEIGHTS MAP -  
PLAT BOOK 1, PAGE 43 (ROANOKE COUNTY)  
DEEDED AS PART OF PARCEL I  
INSTRUMENT #060000529

G T.M. #2761604 - 8,570 SF  
ADAMS STREET, N.W.  
WEST PART OF LOT 4, BLOCK 24 AND PART OF AN ALLEY VACATED BY  
BOARD OF SUPERVISOR'S BOOK 9, PAGE 274 (RKE. CO.);  
WASHINGTON HEIGHTS MAP -  
PLAT BOOK 1, PAGE 43 (ROANOKE COUNTY)  
DEEDED AS PART OF PARCEL I  
INSTRUMENT #060000529

H T.M. #2761606 - 6,250 SF  
MELROSE AVENUE, N.W.  
LOT 7, BLOCK 24; WASHINGTON HEIGHTS MAP -  
PLAT BOOK 1, PAGE 43 (ROANOKE COUNTY)  
DEEDED AS PART OF PARCEL II  
INSTRUMENT #060000529

I T.M. #2761607 - 6,250 SF  
3707 MELROSE AVENUE, N.W.  
LOT 8, BLOCK 24; WASHINGTON HEIGHTS MAP -  
PLAT BOOK 1, PAGE 43 (ROANOKE COUNTY)  
DEEDED AS PART OF PARCEL II  
INSTRUMENT #060000529

J T.M. #2761608 - 6,273 SF  
MELROSE AVENUE, N.W.  
LOT 9, BLOCK 24; WASHINGTON HEIGHTS MAP -  
PLAT BOOK 1, PAGE 43 (ROANOKE COUNTY)  
DEEDED AS PART OF PARCEL I  
INSTRUMENT #060000529

K T.M. #2761609 - 4,445 SF  
MELROSE AVENUE, N.W.  
LOT 10, BLOCK 24; WASHINGTON HEIGHTS MAP -  
PLAT BOOK 1, PAGE 43 (ROANOKE COUNTY)  
ALSO PART OF PARCEL A; IRA VAN DYKE CHELF PLAT -  
DEED BOOK 829, PAGE 90  
DEEDED AS PART OF PARCEL I  
INSTRUMENT #060000529

L T.M. #2761610 - 6,791 SF  
MELROSE AVENUE, N.W.  
EASTERN PORTION OF LOTS 2, 3, AND 4, BLOCK 24; WASHINGTON HEIGHTS MAP -  
PLAT BOOK 1, PAGE 43 (ROANOKE COUNTY)  
PARCEL C; IRA VAN DYKE CHELF PLAT - DEED BOOK 829, PAGE 90  
DEEDED AS PART OF PARCEL I  
INSTRUMENT #060000529

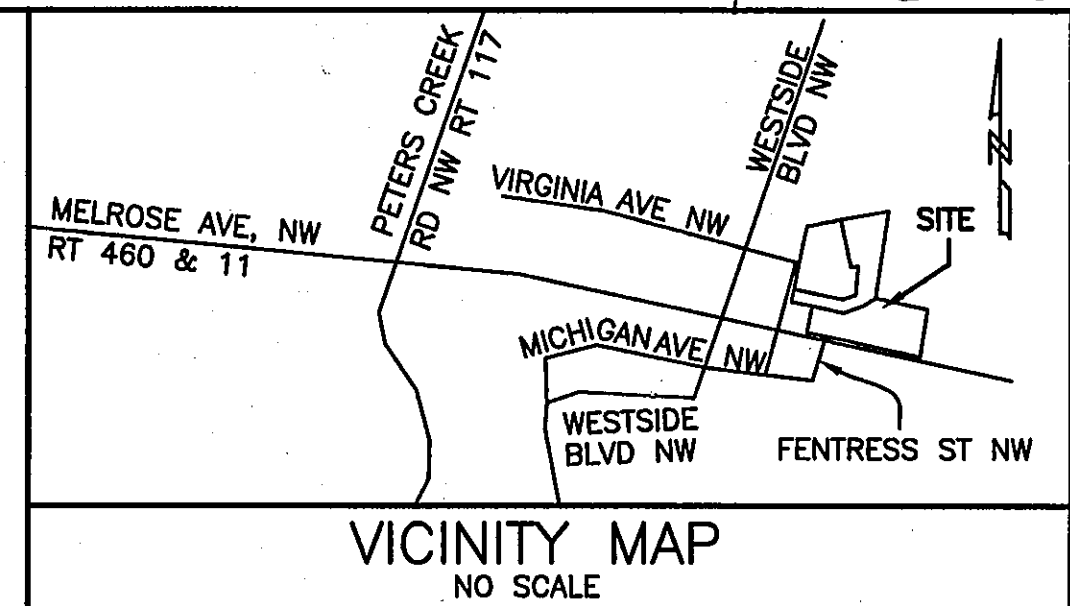

- THIS PLAT WAS PREPARED WITHOUT THE BENEFIT OF A CURRENT TITLE REPORT AND THERE MAY EXIST ENCUMBRANCES WHICH AFFECT THE PROPERTY NOT SHOWN HEREON.
- PROPERTY LINES SHOWN HEREON ARE BASED UPON A COMPILATION OF DEEDS OF RECORD, PLATS OF RECORD, AND ACTUAL MONUMENTATION FOUND BY FIELD SURVEY ON NOVEMBER 20, 2007 AND MAY NOT CONFORM TO DEEDS AND PLATS OF RECORD.
- PROPERTIES ARE ALL IN F.E.M.A. DEFINED ZONE X (UNSHADED). THIS OPINION IS BASED UPON A REVIEW OF F.E.M.A. PANEL #51161C0161 G (EFFECTIVE DATE: 09/28/07) AND HAS NOT BEEN VERIFIED BY ACTUAL FIELD ELEVATIONS.
- THE RECORDATION OF THIS PLAT OF SUBDIVISION DOES NOT CONSTITUTE A CONVEYANCE OF LAND. ANY LOTS, PARCEL OR TRACT OF LAND SHOWN HEREON THAT IS INTENDED FOR SALE AND/OR CONVEYANCE MUST BE CONVEYED BY DEED AND SAID DEED MUST BE RECORDED IN THE OFFICE OF THE CLERK OF THE CIRCUIT COURT OF THE CITY OF ROANOKE.
- PROPERTIES MAY CONTAIN UNDERGROUND UTILITY SERVICE LINES.

I HEREBY CERTIFY THAT THIS PLAT IS FROM A CURRENT FIELD SURVEY AND IS CORRECT TO THE BEST OF MY KNOWLEDGE AND BELIEF.

Brian J. Casella  
BRIAN J. CASELLA 002806

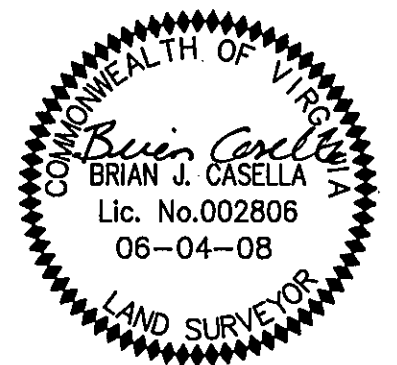

PLAT OF SURVEY  
SHOWING THE SUBDIVISION OF PROPERTIES OWNED BY  
TRUSTEES OF GOD'S HOUSE BAPTIST MINISTRY  
RECORDED IN INSTRUMENT #040020128  
AND INSTRUMENT #060000529  
CREATING HEREON  
GOD'S HOUSE BAPTIST MINISTRY  
LOT 1 (1.7763 ACRES), LOT 2 (1.7717 ACRES), &  
LOT 3 (2.2309 ACRES), A VARIABLE WIDTH PRIVATE SANITARY  
SEWER EASEMENT, AND A PRIVATE STORMWATER  
MANAGEMENT EASEMENT  
SITUATED NORTHEASTERLY OF THE INTERSECTION OF  
MELROSE AVENUE, N.W. AND ADAMS STREET, N.W.  
CITY OF ROANOKE, VIRGINIA  
DATED JUNE 4, 2008  
JOB #R0700302.00  
SCALE: 1" = 50'  
SHEET 1 OF 2



TEL: 540-772-9580 FAX: 540-772-8050  
PLANNERS ARCHITECTS ENGINEERS SURVEYORS  
Balzer & Associates, Inc. 1208 Corporate Circle Roanoke Va. 24018