



GENERAL DEMOLITION NOTES
 UNLESS OTHERWISE STATED HEREON, ALL EXISTING PHYSICAL IMPROVEMENTS INDICATED HEREON TO BE REMOVED ARE TO BE REMOVED FROM THE SITE IN THEIR ENTIRETY. IN THE EVENT THAT THERE ARE QUESTIONS REGARDING THE DISPOSITION OF CERTAIN IMPROVEMENTS, THE CONTRACTOR SHALL VERIFY WITH THE ENGINEER PRIOR TO ENGAGING IN ANY DEMOLITION WORK RELATIVE TO THE ITEM(S) IN QUESTION.

DEMOLITION SHALL INCLUDE, UNLESS OTHERWISE NOTED ON DRAWINGS, REMOVAL OF EXISTING OBJECTS OR IMPROVEMENTS, WHETHER INDICATED ON THE DRAWINGS OR NOT, THAT WOULD IN THE OPINION OF THE OWNER, PRESENT OR INTERFERE WITH THE PROGRESS OR COMPLETION OF THE PROPOSED WORK.

PERMITS, FEES AND LICENSES SHALL BE SECURED AND PAID FOR BY THE CONTRACTOR, INCLUDING DISPOSAL CHARGES AS REQUIRED.

WORK SHALL COMPLY WITH THE REQUIREMENTS OF THE GOVERNING AUTHORITIES IN DEMOLITION OF EXISTING PAVEMENT, CURBS AND GUTTERS, DRAINAGE STRUCTURES AND UTILITIES AS MAY BE REQUIRED.

CONTRACTOR SHALL SAW-CUT ALL JOINTS WHERE EXISTING CURBING, PAVEMENT AND SIDEWALK IS TO BE DEMOLISHED AND NEW CONSTRUCTION ADJACENT TO THE EXISTING.

ALL EXISTING CURBING, CONCRETE SIDEWALK, ENTRANCES, BUILDING FOUNDATIONS AND TREES AND BRUSH THAT ARE DEMOLISHED SHALL BE REMOVED FROM THE SITE AND DISPOSED OF BY THE CONTRACTOR. DEMOLITION DEBRIS, ETC. SHALL NOT BE USED AS FILL MATERIAL ON THE SITE.

REFER TO PROJECT MANUAL FOR DIRECTION GOVERNING ABANDONMENT OR REMOVAL OF EXISTING UTILITIES.

CONTRACTOR SHALL PROVIDE THE FOLLOWING PROTECTIONS AT THE JOB SITE:
 MAKE ARRANGEMENTS BEFORE INITIATING DEMOLITION, FOR RELOCATING, DISCONNECTION, REROUTING, ABANDONING, OR SIMILAR ACTION AS MAY BE REQUIRED RELATIVE TO UTILITIES AND OTHER UNDERGROUND PIPING, TO PERMIT WORK TO PROCEED WITHOUT DELAY.

ARRANGEMENTS SHALL BE MADE IN ACCORDANCE WITH REGULATIONS OF AUTHORITIES OF UTILITIES MENTIONED, SUCH AS OVERHEAD / UNDERGROUND POWER AND TELECOMMUNICATION LINES AND EQUIPMENT, GAS PIPING, STORM SEWERS, SANITARY SEWERS, OR WATER PIPING.

CONTRACTOR SHALL NOT USE WATER WHEN IT MAY CREATE HAZARDOUS OR OBSTRUCTIONABLE CONDITIONS SUCH AS ICE, FLOODING AND/OR POLLUTION.

ENSURE SAFE PASSAGE OF PERSONS AROUND ALL AREAS OF DEMOLITION.

CONDUCT OPERATIONS TO PREVENT DAMAGE TO ADJACENT BUILDINGS, STRUCTURES, OTHER FACILITIES, OR INJURY TO PERSONS.

PROMPTLY REPAIR DAMAGES CAUSED TO ADJACENT FACILITIES BY DEMOLITION OPERATIONS AT NO COST TO THE OWNER.

MAINTAIN EXISTING UTILITIES INDICATED TO REMAIN, KEEP IN SERVICE, AND PROTECT AGAINST DAMAGE DURING DEMOLITION OPERATIONS.

PREVENT INTERRUPTION OF EXISTING UTILITIES SERVING OCCUPIED OR USED FACILITIES, EXCEPT BY AUTHORIZED IN WRITING BY AUTHORITIES HAVING JURISDICTION.

PROVIDE TEMPORARY SERVICES DURING INTERRUPTIONS TO EXISTING UTILITIES AS ACCEPTABLE TO OWNER AND GOVERNING AUTHORITIES.

PROVIDE TRAFFIC CONTROL MEASURES AS DEEMED NECESSARY FOR CONTROL OF VEHICULAR ROUTES DURING TIMES OF DEMOLITION OR RECONSTRUCTION WITHIN OR ADJACENT TO PUBLIC STREETS OR OTHER OFF-SITE VEHICULAR ROUTES. CONTROLS MAY INCLUDE, BUT NOT BE LIMITED TO, CONES, BARRIERS, BARRICADES, SIGNAGE (STATIC AND/OR MARQUEE) AND FLAGMEN.

USE WATER SPRINKLING AND OTHER SUITABLE METHODS TO LIMIT DUST AND DIRT RISING AND SCATTERING IN AIR TO LOWEST PRACTICAL LEVEL. COMPLY WITH GOVERNING REGULATIONS PERTAINING TO ENVIRONMENTAL PROTECTION.

CLEAN ADJACENT STRUCTURES AND IMPROVEMENTS OF DUST, DIRT, AND DEBRIS CAUSED BY DEMOLITION OPERATIONS. RETURN ADJACENT AREAS TO CONDITIONS EXISTING PRIOR TO THE START OF WORK, OR BETTER.

SITE SPECIFIC DEMOLITION NOTES

DEMOLITION OF EXISTING DWELLING
 UNLESS INTENDED TO USE THE EXISTING DWELLING AS A TEMPORARY OFFICE FOR CONSTRUCTION ADMINISTRATION, THE CONTRACTOR SHALL DEMOLISH THE EXISTING DWELLING IN ITS ENTIRETY, REMOVING ALL DEMOLISHED DEBRIS FROM THE SITE AND DISPOSING OF IN A LEGAL FASHION.

CONTRACTOR SHALL BE RESPONSIBLE FOR ALL COMPONENTS OF THE DEMOLITION PROCESSES, INCLUDING COORDINATION WITH UTILITY COMPANIES FOR REMOVAL / CAPPING OF ALL SERVICE LATERALS, DROPS, ETC.

AS THE EXISTING PUBLIC SANITARY SEWER DOES NOT EXTEND TO THE EXISTING DWELLING, IT IS EXERCISED THAT THE EXISTING DWELLING HAS A SEPTIC TANK, DISTRIBUTION BOX AND SEPTIC FIELD. THE CONTRACTOR IS REQUIRED TO REMOVE THESE ITEMS IN THEIR ENTIRETY AND DISPOSE OF OFF-SITE IN ACCORDANCE WITH RULES AND REGULATIONS PERTAINING THERETO. THE TANK SHALL BE PUMPED BY A LICENSED SEPTIC SYSTEM MAINTENANCE COMPANY PRIOR TO DEMOLITION.

DEMOLITION REQUIRED IN MECCA STREET, N.E.:
 THERE IS A CERTAIN AMOUNT OF WORK REQUIRED WITHIN THE RIGHT OF WAY OF MECCA STREET, INCLUDING:
 A. THE CONSTRUCTION OF NEW PUBLIC SIDEWALK FROM THE SITE ENTRANCE TO THE EXISTING BUS STOP AT THE INTERSECTION OF MECCA STREET AND ORANGE AVENUE.
 B. ANCILLARY RECONSTRUCTION OF MALDROES, RELOCATION OF PUBLIC SIGNAGE, ETC. ASSOCIATED WITH CONSTRUCTION OF THE NEW SIDEWALK.
 C. THE CONSTRUCTION OF NEW CURB AND GUTTER ALONG THE FRONTAGE OF THE SUBJECT SITE AND INTERCONNECTING WITH THE CURBING AT THE ADJACENT FIRE STATION ENTRANCE.
 D. THE CONSTRUCTION OF NEW CURB AND GUTTER ALONG A PORTION OF THE FRONTAGE OF THE CHURCH ACROSS MECCA STREET FROM THE SITE.
 E. THE CONSTRUCTION OF A NEW PUBLIC STORM DRAIN SYSTEM FROM THE NORTHWESTERN CORNER OF THE SUBJECT SITE TO THE EXISTING STORM DRAIN AT THE INTERSECTION OF MECCA STREET AND ORANGE AVENUE.
 F. THE CONSTRUCTION OF A NEW PUBLIC SANITARY SEWER SYSTEM FROM THE LOCATION OF THE ADJACENT FIRE STATION.
 G. HEAVY-DUTY PAVEMENT REPLACEMENT OF PUBLIC STREET PAVEMENT WHERE FULL-DEPTH REMOVAL IS REQUIRED FOR NEW CONSTRUCTION (SEE SHEET 06.1).
 H. MILLING AND OVERLAYING MECCA STREET ADJACENT TO AREAS OF NEW PIPELINE CONSTRUCTION (SEE SHEET 06.1).

DEMOLITION REQUIRED IN WOODED AREAS OF PROPERTY:
 IT IS IMPERATIVE THAT ONLY THE AREAS SHOWN WITHIN THE LIMITS OF DISTURBANCE OF THESE PLANS ARE CLEARED, GRUBBED, OR OTHERWISE PHYSICALLY ALTERED BY THIS PHASE OF CONSTRUCTION. SEE "CONSTRUCTION SEQUENCING-SITE SPECIFIC" ON SHEET 08.2.

ALL ORGANIC MATERIALS (TREES, SHRUBS, BRUSH, DEADFALLS, ETC.) SHALL BE REMOVED FROM THE AREA OF PHASE ONE DISTURBANCE IN THEIR ENTIRETY. IT HAS BEEN CONSIDERED BY BOTH THE PLANNING DEPARTMENT AND THE FIRE MARSHAL'S OFFICE THAT BURNING WILL BE PROHIBITED.

AT THIS TIME ASSUME THAT ALL STUMPS AND ROOTS WILL BE REMOVED IN THEIR ENTIRETY.

CLEANUP REQUIRED IN WOODED AREAS OF PROPERTY:
 THE DEMOLITION CONTRACTOR SHALL MAKE ACCOMMODATIONS TO PROVIDE THEIR SERVICES IN COLLECTING AND DISPOSING OF VARIOUS "LUMP" WHICH HAS ACCUMULATED THROUGHOUT THE PROPERTY. AT THIS TIME THE CONTRACTOR SHALL ASSUME THAT THEY WILL GENERALLY BE REQUIRED TO PROVIDE A UTILITY OR OTHER SMALL VEHICLE AND LANDSCAPE TRAILERS OR SIMILAR TO TRAVEL THE EXISTING DIRT ROADS THROUGHOUT THE SITE AND COLLECT TRASH, CAR PARTS AND OTHER INORGANIC DEBRIS, WITH THIS DEBRIS THEN BEING REMOVED FROM THE SITE AND DISPOSED OF IN A LEGAL FASHION.

POPE ARCHITECTS

POPE ARCHITECTS, INC.
 1295 BANDANA BLVD N, SUITE 200
 ST. PAUL, MN
 55108-2735
 (651) 642-9200 | FAX (651) 642-1101 | www.popearch.com

RICHFIELD LIVING AT THE ROANOKE CAMPUS
 Roanoke, Virginia



CWA CALDWELL WHITE ASSOCIATES

ENGINEERING / SURVEYING / PLANNING
 4000 MELBOURNE AVENUE
 ROANOKE, VA 24012-1900
 TEL: (540) 388-4400
 FAX: (540) 388-4700

Scale: As Shown W.G. 19-0034
 Designed: C.L. White
 Drawn: C.L. White

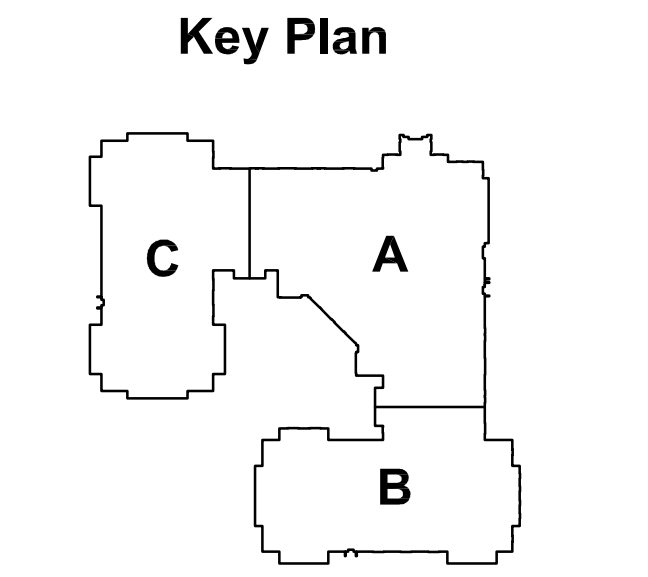

EXISTING STRUCTURE & SITE DEMOLITION PLAN

Issues and Revisions:	DESIGN DEVELOPMENT ISSUE
04/19/2019	DESIGN DEVELOPMENT ISSUE
06/06/2019	PERMIT SET
07/17/2019	PER 1ST CITY SITE REVIEW
07/31/2019	ADDENDUM 4 / 100% CD SET (see revisions same as Delta ST dated 07/17/2019)

Commission No: 63132-18180
 Drawn by:
 Checked by:

City of Roanoke
 Planning, Building, & Development
 COMPREHENSIVE DEVELOPMENT PLAN

APPROVED
 by Aaron Cypher 09/20/2019

Professional Engineer Seal for Corbin L. White, License No. 23843, 07-31-19

SHEET

C1.1

30' 0' 30' 60'
 1" = 30' GRAPHIC SCALE