

SMH TOP 1108.69  
 BM ELEV. = 1109.55  
 PK NAIL IN C&P POLE #1930-F  
 TOP DI/SIDEWALK 1108.47  
 THROAT 1107.63  
 CONTRACTOR TO FIT  
 DI TO EXISTING FEATURES  
 TOP DI/SIDEWALK 1108.67  
 THROAT 1107.65  
 STA 17+31.97  
 PROPOSED INV. 1104.50  
 DI'S STA 17+03.97  
 PROPOSED INV. 1104.19  
 PK  
 20'  
 10'  
 PI #3

EDEN DR.  
 STORM DRAIN  
 COMM. 582  
 TABLE 20 SCALE 1" = 30'  
 SEPT. 12, 1990 J. WORLEY

PIPE @ 1.09%

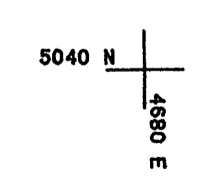
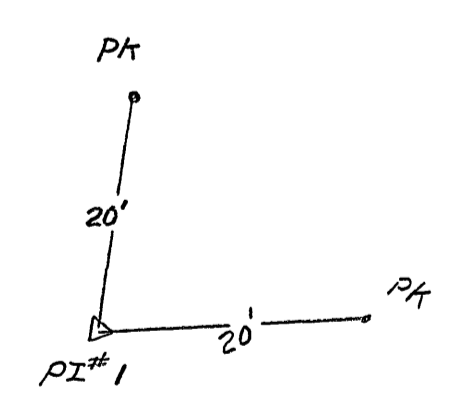
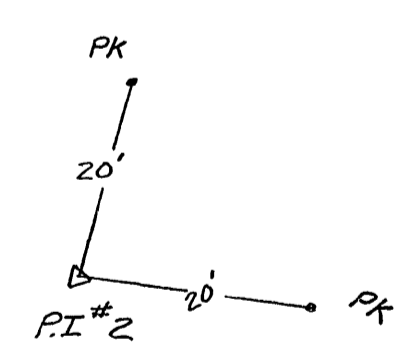
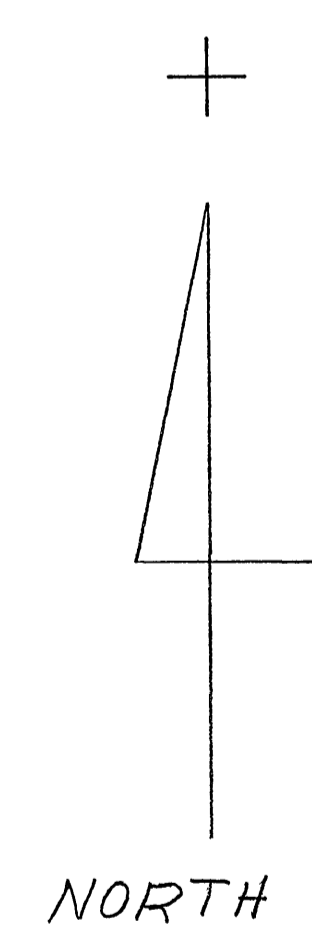

EXISTING SMH #103 USED  
 AS BENCH MARK  
 TOP 1102.82  
 FROM STREET 36  
 WILLIAMSON RD. PHASE 2

PHASE 2  
 WILLIAMSON RD.  
 STORM DRAIN  
 SHEET 36

DI #1 10400  
 PROPOSED INV. 1096.51  
 EXISTING DI TOP 1102.84  
 INV. 1096.33  
 STA 9+83.05

DI #2 12+2901  
 PROPOSED INV. 1099.01

SMH TOP 1105.84  
 INV. 1095.30  
 4' LAT INV. 1099.43

DI #1 10400  
 PROPOSED INV. 1096.51  
 DI #2 12+2901  
 PROPOSED INV. 1099.01  
 DI #3 15+000  
 PROPOSED INV. 1096.33  
 STA 9+83.05  
 DI #4 15+000  
 PROPOSED INV. 1096.33  
 STA 9+83.05  
 DI #5 15+000  
 PROPOSED INV. 1096.33  
 STA 9+83.05

CORNELL DR.  
 15' CP

