

1. G.C. SHALL ENSURE THAT VSPM PERMIT IS IN PLACE PRIOR TO THE START OF CONSTRUCTION AND THAT A SWPPP IS MAINTAINED ON-SITE AT ALL TIMES DURING CONSTRUCTION. SITE INSPECTIONS SHALL BE PERFORMED AND DOCUMENTED IN ACCORDANCE WITH THE REQUIREMENTS OF THE PERMIT.
2. THE CONSTRUCTION ENTRANCE SHALL BE INSTALLED FROM WOOD HAVEN ROAD AS THE FIRST STEP IN CONSTRUCTION. THE CONSTRUCTION ENTRANCE SHALL BE MAINTAINED THROUGHOUT THE DURATION OF THE PROJECT. G.C. SHALL PAY SPECIAL ATTENTION TO ENSURE THERE IS NO MUD "TRACKING" FROM THE SITE INTO THE PUBLIC RIGHT OF WAY.
3. SILT FENCE TO BE INSTALLED AS SHOWN. THE SILT FENCE SHALL BE MAINTAINED THROUGHOUT THE DURATION OF THE PROJECT. THE R.L.D. ASSIGNED TO THE PROJECT SHALL ENSURE ALL REGULATIONS ARE FOLLOWED AND DOCUMENTED THROUGHOUT THE PROJECT TO PREVENT THE EXCESSIVE BUILD-UP OF SEDIMENT.
4. STRIP TOPSOIL AND STORE IN LOCATION SHOWN.
5. MAJOR GRADING OPERATIONS SHALL COMMENCE AT THIS TIME. CULVERT TO BE INSTALLED AND CULVERT INLET AND OUTLET PROTECTION TO BE INSTALLED.
6. TEMPORARY SEEDING SHALL BE APPLIED WITHIN 7 DAYS TO ALL AREAS THAT WILL REMAIN DORMANT FOR LONGER THAN 14 DAYS. PERMANENT STABILIZATION SHALL BE APPLIED TO AREAS THAT WILL REMAIN DORMANT FOR LONGER THAN 1 YEAR.
7. ALL UTILITIES FOR THE SITE SHALL BE INSTALLED AT THIS TIME AND AREAS TEMPORARILY OR PERMANENTLY SEEDED AFTER COMPLETION OF INSTALLATION. INLET AND OUTLET PROTECTION SHALL BE INSTALLED WITH THE STORM SEWER IMPROVEMENTS AS APPLICABLE. DIVERSION DIKES TO BE INSTALLED AT INLETS #3 AND #5 TO KEEP STORMWATER OUT OF THE EXISTING ROADWAY AND DIVERT IT INTO THE STORM SEWER SYSTEM.
8. PERMANENT SEEDING, MULCHING, AND BLANKET MATTING SHALL BE APPLIED AT THIS TIME TO ALL AREAS AT FINAL GRADE.
9. GRAVEL FOR THE PROPOSED ACCESS DRIVE SHALL BE INSTALLED AT THIS TIME.
10. THE AREA OF THE PROPOSED STORMWATER MANAGEMENT FACILITY SHALL BE CLEANED OUT AT THIS TIME. THE CULVERT INLET PROTECTION SHALL BE REMOVED AND THE RISER INSTALLED WITH APPROPRIATE ORIFICES AND TRASH RACKS. THE PERMANENT DISTURBANCE SHALL BE INSTALLED AT THIS TIME. STORM SEWER AND STORMWATER MANAGEMENT AS-BUILTS SHALL BE PROVIDED TO ROANOKE COUNTY PRIOR TO FINAL PROJECT CLOSEOUT.
11. ALL REMAINING AREAS OF THE SITE SHALL BE PERMANENTLY STABILIZED.
12. AFTER FINAL SITE STABILIZATION AND ROANOKE COUNTY APPROVAL, INLET PROTECTION, SILT FENCE, AND THE CONSTRUCTION ENTRANCE CAN BE REMOVED.
13. G.C. SHALL ENSURE THAT THE LIMITS OF DISTURBANCE ARE STRICTLY ADHERED TO DURING THE PROJECT.
14. NO DEVIATIONS TO THE PLANS SHALL TAKE PLACE UNLESS PRIOR APPROVAL FROM THE OWNER, PROJECT ENGINEER, AND THE APPROPRIATE REVIEW AGENCIES.

3.02	TEMPORARY STONE CONSTRUCTION ENTRANCE	CE	3.18	OUTLET PROTECTION	OP
3.05	SILT FENCE	SF	3.31	TEMPORARY SEEDING	TS
3.07	STORM DRAIN INLET PROTECTION	IP	3.32	PERMANENT SEEDING	PS
3.08	CULVERT INLET PROTECTION	CIP	3.35	MULCHING	MU
3.09	TEMPORARY DIVERSION DIKE	DD	3.36	SOIL STABILIZATION BLANKETS & MATTING	B/M



A graphic scale bar and north arrow. The north arrow is a vertical line with a decorative swirl at the top and the word "NORTH" written vertically along it. Below the north arrow is a horizontal scale bar. The scale bar is divided into four equal segments, each labeled with a number: 40, 0, 40, 80, and 120. Below the scale bar, the text "SCALE: 1" = 40'" is written.

TEMPORARY
FARM HOUSE

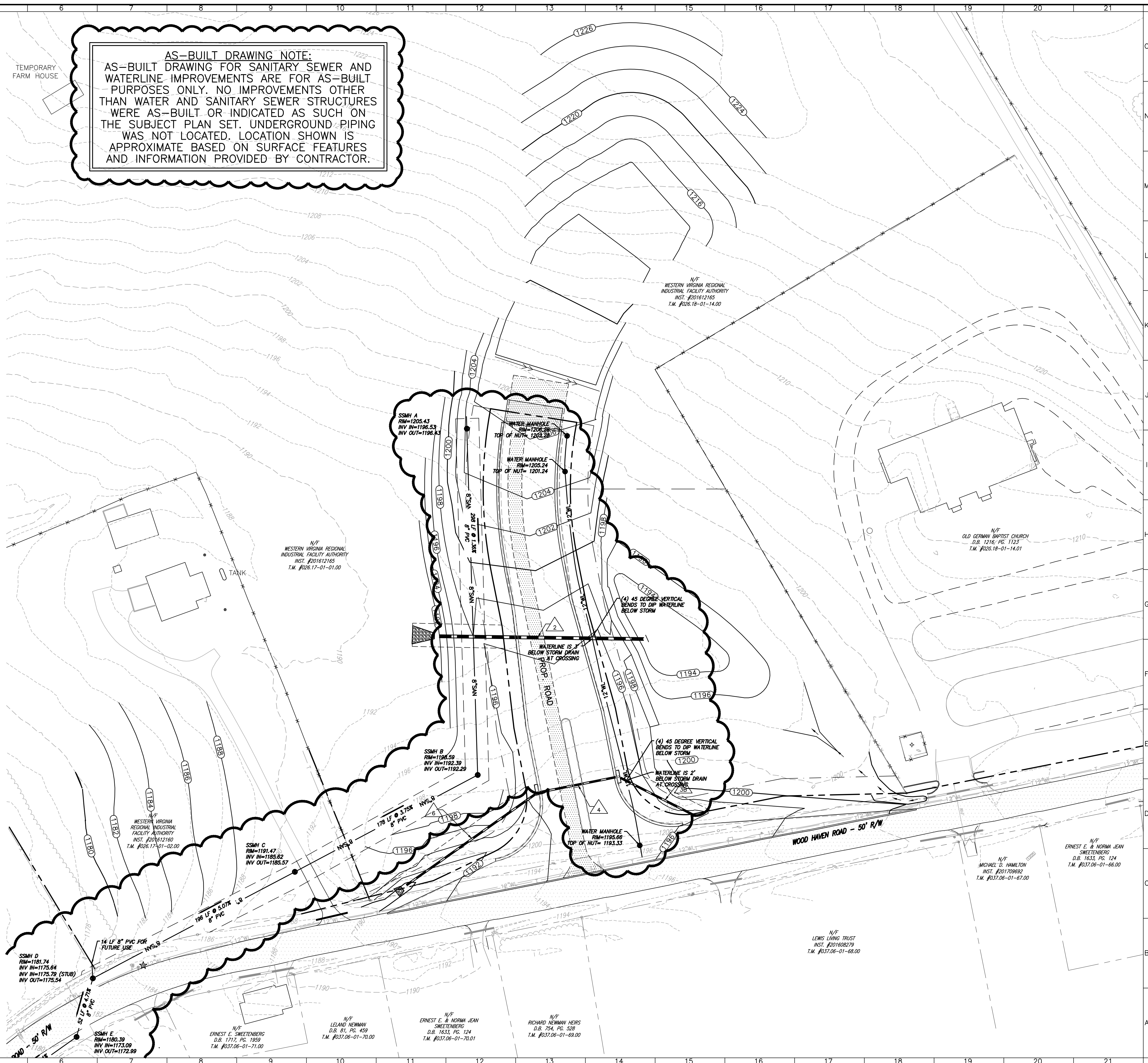

SHEET NO.
AB2
JOB NO. 04180095.00