

DATE: March 22, 2005

REVISIONS	△
	△
	△
	△
	△

HUGHES ASSOCIATES ARCHITECTS
 Architecture • Planning • Consulting

656 ELM AVENUE, S.W.
 P.O. BOX 1034
 ROANOKE, VIRGINIA 24005-1034

TEL (540) 342-4002
 FAX (540) 342-2060
 www.HughesArchitects.com

**ALTERATIONS TO
 WESTER VIRGINIA
 WATER AUTHORITY
 COULTER BUILDING**
 601 South Jefferson Street
 Roanoke, Virginia

**ENLARGED
 FLOOR
 PLAN
 (TELEPHONE,
 DATA,
 POWER &
 ELECTRICAL)**
 PHASE I

COMMISSION No.
 04102
 SHEET
E1-5
 No. 12 of 13
 © COPYRIGHT 2005
 HUGHES ASSOCIATES ARCHITECTS
 A PROFESSIONAL CORPORATION

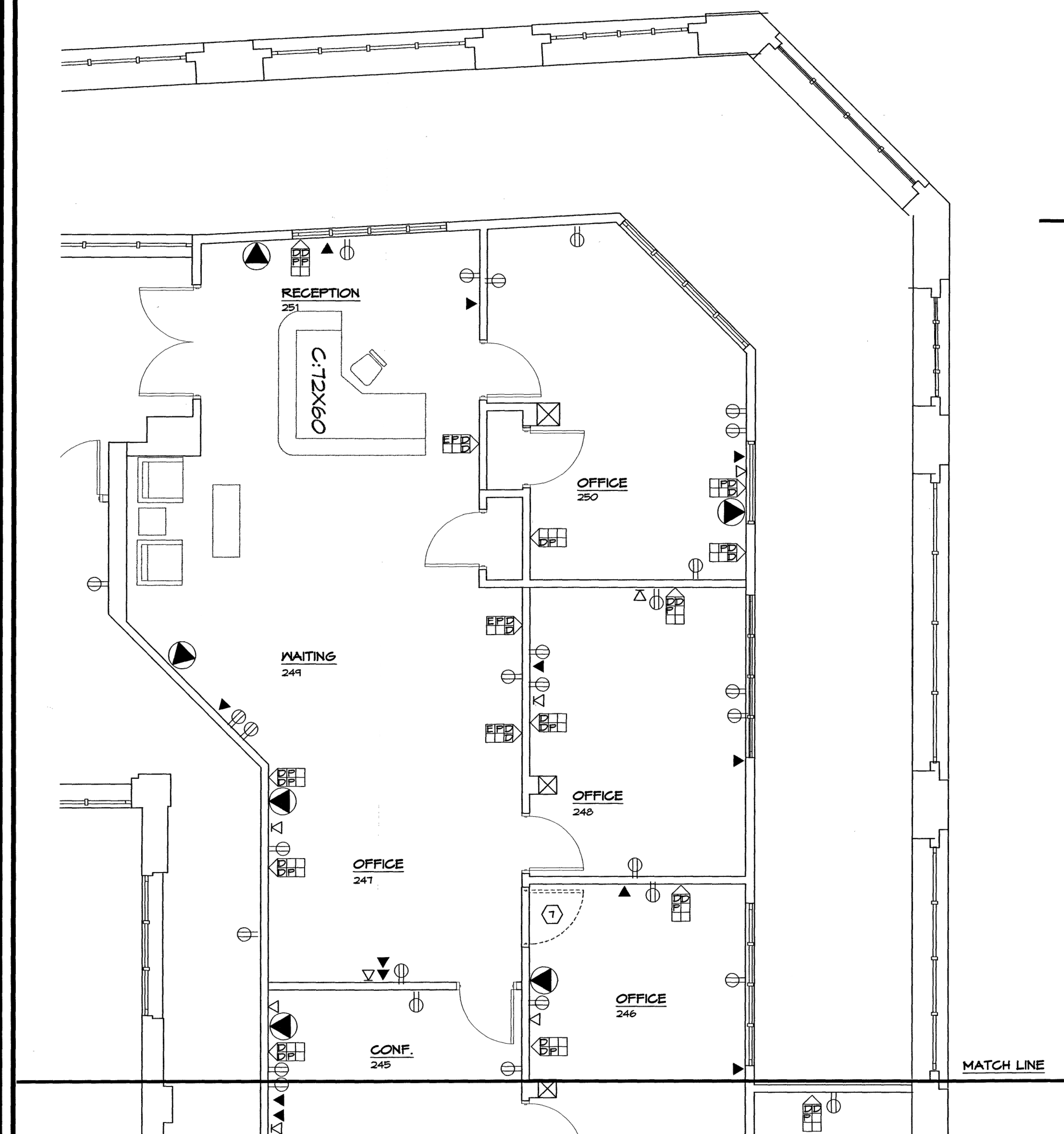
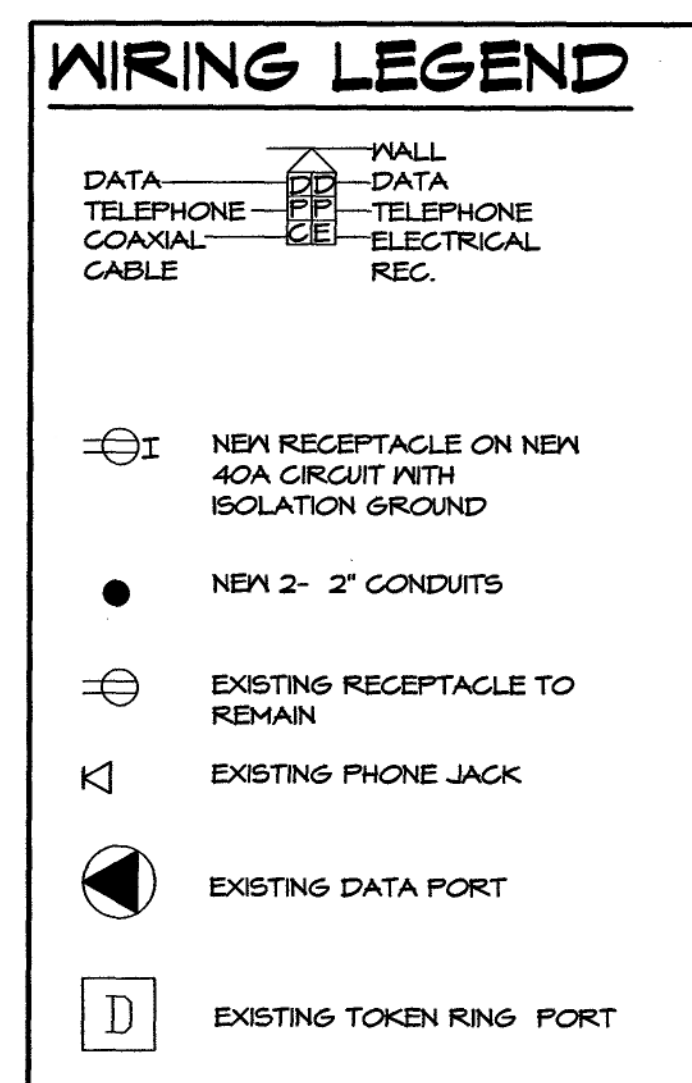
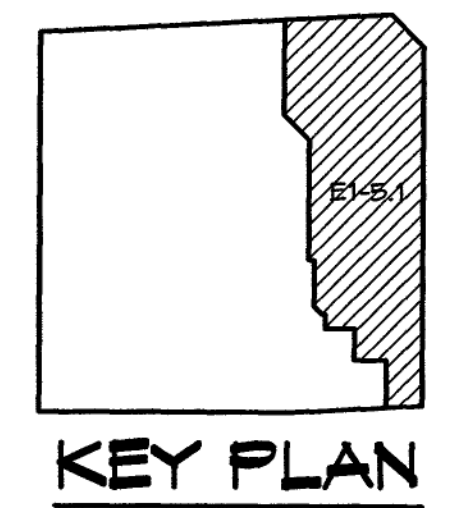

SECOND FLOOR (EAST)
 E1-5.1
 E1-3
 SCALE: 1/4" = 1'-0"

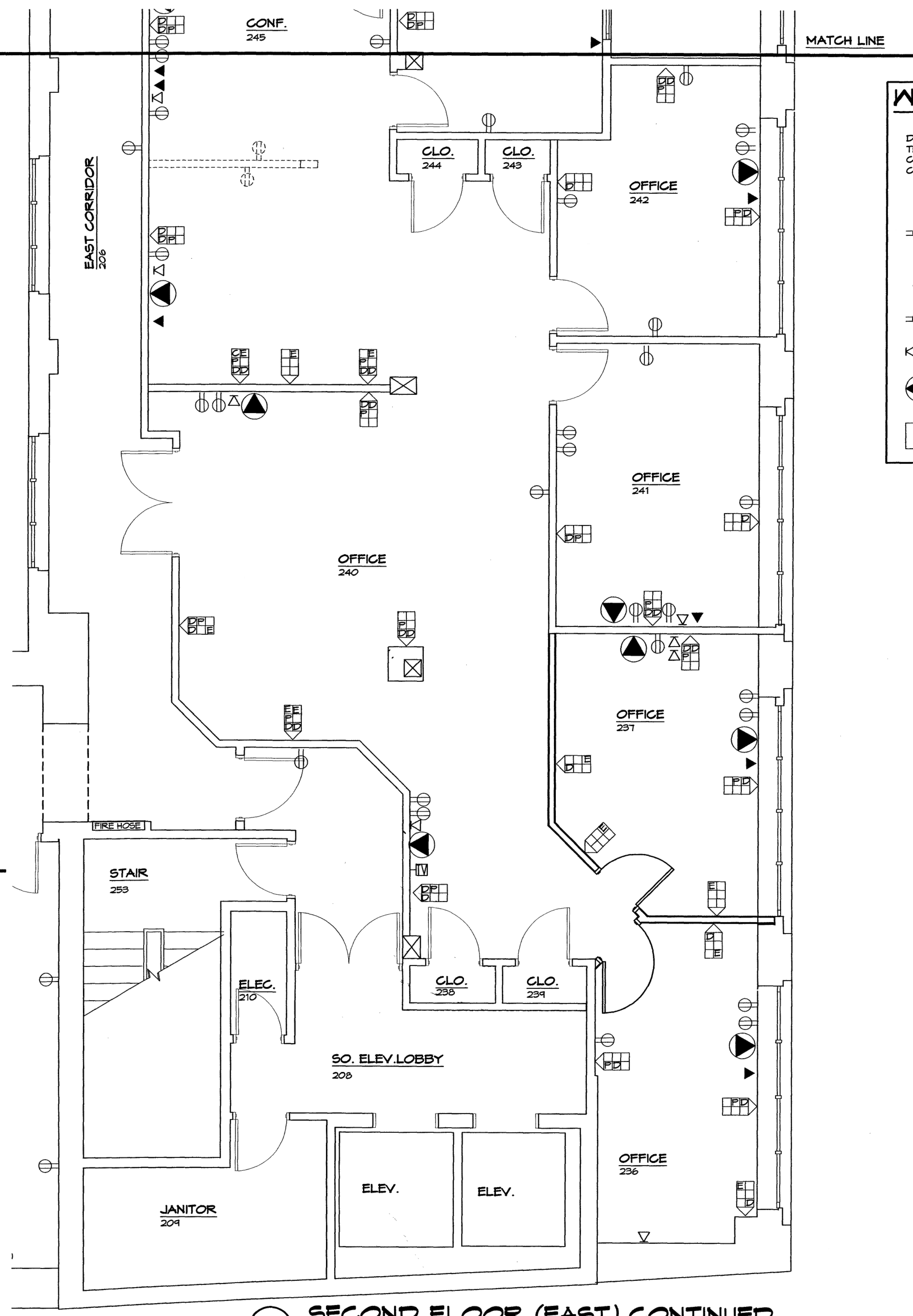

SECOND FLOOR (EAST) CONTINUED
 E1-5.1
 E1-3
 SCALE: 1/4" = 1'-0"

DRAWN BY: J. G. SMITH, P.E., ARCHITECT; DATE: MAR 22, 2005; SCALE: 1/4" = 1'-0"; SHEET: E1-5 OF 13