

SECOND FLOOR FIRE RATED CEILING PLAN

SCALE: 1/16" = 1'-0"
 NOTES: 1. RELOCATE AND PROVIDE NEW SPRINKLERS IN THIS AREA AS REQUIRED.
 2. EXTEND BULKHEAD FRAMING FINISH TO UNDERSIDE OF NEW RATED CEILING.

GENERAL NOTE:
 ITEMS NOTED AS EXISTING CONDITIONS ARE BASED ON DRAWINGS BY MARTIN BROTHERS GENERAL CONTRACTORS DATED 1-4-1987, (RENOVATIONS AND ALTERATIONS TO COULTER BUILDING AND NATIONAL BUSINESS COLLEGE)

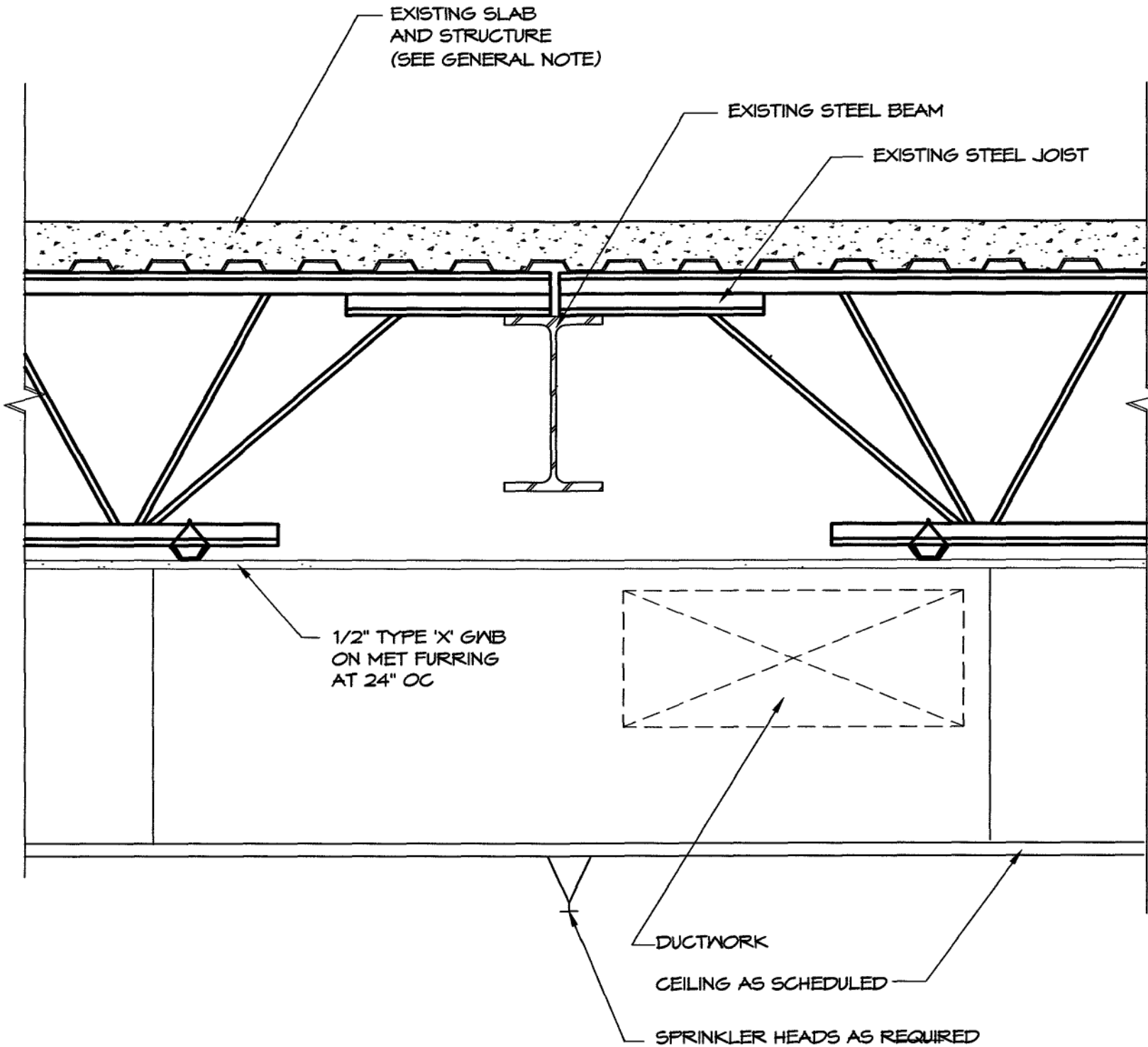

RATED FLOOR / CEILING ASSEMBLY
 UL DESIGN NO. G514 2-HOUR RATED

UL G514 NOTES

ONE LAYER 1/2" TYPE X GYPSUM WALLBOARD OR GYPSUM VENEER BASE APPLIED AT RIGHT ANGLES TO RIGID FURRING CHANNELS 24" O.C. WITH 1" TYPE S DRYWALL SCREWS 12" O.C. GYPSUM BOARD END JOINTS LOCATED MIDWAY BETWEEN CONTINUOUS CHANNELS AND ATTACHED TO ADDITIONAL PIECES OF CHANNEL 54" LONG WITH SCREWS 12" O.C. FURRING CHANNELS ATTACHED WITH 18 GAGE WIRE TIES 48" O.C. TO OPEN WEB STEEL JOISTS 24" O.C. FURRING CHANNELS MAY BE ATTACHED TO 1 1/2" COLD ROLLED CARRYING CHANNELS 48" O.C. SUSPENDED FROM JOISTS BY 8 GAGE WIRE HANGERS NOT OVER 48" O.C. (TWO HOUR RESTRAINED AND UNRESTRAINED)

NOTE: SEAL ALL EXISTING PENETRATIONS THROUGH FIRE BARRIERS AS REQUIRED USING UL LISTED PROTECTIVES COMPATIBLE WITH RATING OF ASSEMBLY

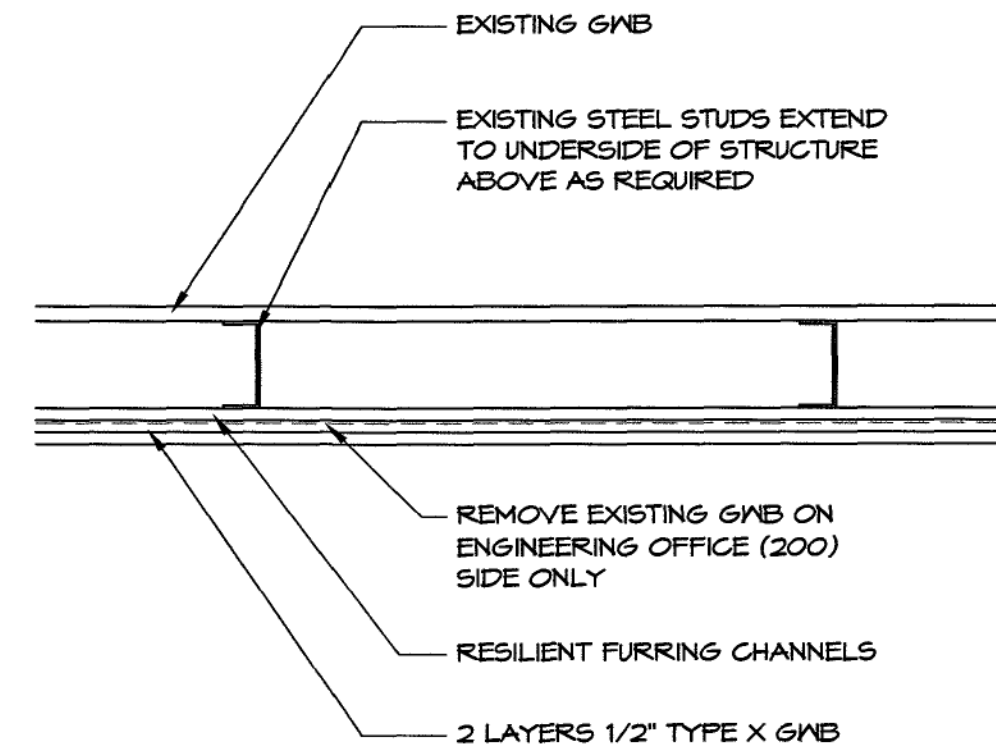

RATED WALL ASSEMBLY
 UL DESIGN NO. U453 2-HOUR RATED

UL U453 NOTES

RESILIENT CHANNELS 24" O.C. ATTACHED AT RIGHT ANGLES TO ONE SIDE OF 3 1/2" 20 GAGE STEEL STUDS 24" O.C. WITH ONE 1/2" TYPE 5-12 DRYWALL SCREW AT EACH STUD. BASE LAYER 1/2" PROPRIETARY TYPE X GYPSUM WALLBOARD OR GYPSUM VENEER BASE APPLIED AT RIGHT ANGLES TO CHANNELS WITH 1" TYPE S DRYWALL SCREWS 24" O.C. FACE LAYER 1/2" PROPRIETARY TYPE X GYPSUM WALLBOARD OR GYPSUM VENEER BASE APPLIED AT RIGHT ANGLES TO CHANNELS WITH 1 5/8" TYPE S DRYWALL SCREWS 12" O.C.

OPPOSITE SIDE: EXISTING 5/8" GYPSUM WALLBOARD
 JOINTS STAGGERED 24" EACH LAYER AND SIDE. (NLB)

PROPRIETARY GYPSUM BOARD
 G-P GYPSUM
 UNITED STATES GYPSUM COMPANY

1/2" GYPROC FIREGUARD C
 1/2" SHEETROCK BRAND GYPSUM PANELS, FIRECODE C CORE

UL L511 NOTES

FURRING CHANNELS - RESILIENT TYPE FORMED OF 25 MSG GALV STEEL AND INSTALLED AT 24" O.C. PERPENDICULAR TO FLOOR JOISTS AND LOCATED 12" FROM EACH LONG EDGE OF WALLBOARD. CHANNELS SHALL BE PLACED WITH 1/4" CLEARANCE AT THE ENDS AND FASTENED TO EACH JOIST WITH 1-7/8" LONG FURRING CHANNEL SCREWS. MINIMUM END CLEARANCE OF CHANNELS TO WALLS: 3/8". ADDITIONAL PIECES, 60" LONG, SHALL BE PLACED IMMEDIATELY ADJACENT TO CHANNELS FOR ATTACHMENT OF END JOINTS OF SECOND LAYER, SECURED WITH 1-7/8" LONG FURRING CHANNEL SCREWS DRIVEN THROUGH WALLBOARD TO JOISTS. ENDS SHALL EXTEND 6" BEYOND EACH SIDE OF END JOINT.

GYPSUM WALLBOARD - 5/8" THICK. FIRST LAYER INSTALLED WITH LONG DIMENSION PERPENDICULAR TO JOISTS, AND END JOINTS OF BOARDS LOCATED AT THE JOISTS. BOARD SHALL BE ATTACHED TO JOISTS WITH 8d CEMENT-COATED COOLER NAILS SPACED AT 7" O.C. IN THE FIELD OF THE BOARD. NAILS SHALL BE LOCATED A MINIMUM OF 1/2" FROM EDGES AND END OF BOARD. SECOND LAYER SECURED TO FURRING CHANNELS WITH 1" LONG WALLBOARD SCREWS, WITH LONG EDGE PERPENDICULAR TO THE FURRING CHANNELS, WITH THE CENTER LINE OF BOARDS LOCATED UNDER A JOIST, AND SO PLACED THAT THE LONG EDGE JOINTS ARE STAGGERED WITH THE BUTTED END JOINTS OF THE FIRST LAYER. SECOND LAYER SHALL BE SECURED TO THE FURRING CHANNELS WITH 1" LONG WALLBOARD SCREWS 12" O.C. BUTTED END JOINTS OF WALLBOARD SHALL BE FASTENED AT ADDITIONAL FURRING CHANNELS AS SHOWN IN END JOINT DETAIL. ALL SCREWS SHALL BE LOCATED 1" AND 1-3/4" FROM THE LONG EDGES AND THE BUTTED END OF BOARDS RESPECTIVELY.

SCREWS - FURRING CHANNEL: CASE-HARDENED STEEL, 1-7/8" LONG, 0.150" DIAMETER SHANK, DIAMOND POINT, 0.395" DIAMETER PHILLIPS-TYPE HEAD.

WALLBOARD: CASE-HARDENED STEEL, 1" LONG, 0.150" DIAMETER SHANK, SELF-DRILLING AND SELF-TAPPING, PHILLIPS-TYPE 0.395" DIAMETER HEAD.

ALTERNATE FINISH SYSTEM - OUTER LAYER WALLBOARD JOINTS COVERED WITH FIBER TAPE AND JOINT COMPOUND.

NOTE: SEAL ALL EXISTING PENETRATIONS THROUGH FIRE BARRIERS AS REQUIRED USING UL LISTED PROTECTIVES COMPATIBLE WITH RATING OF ASSEMBLY

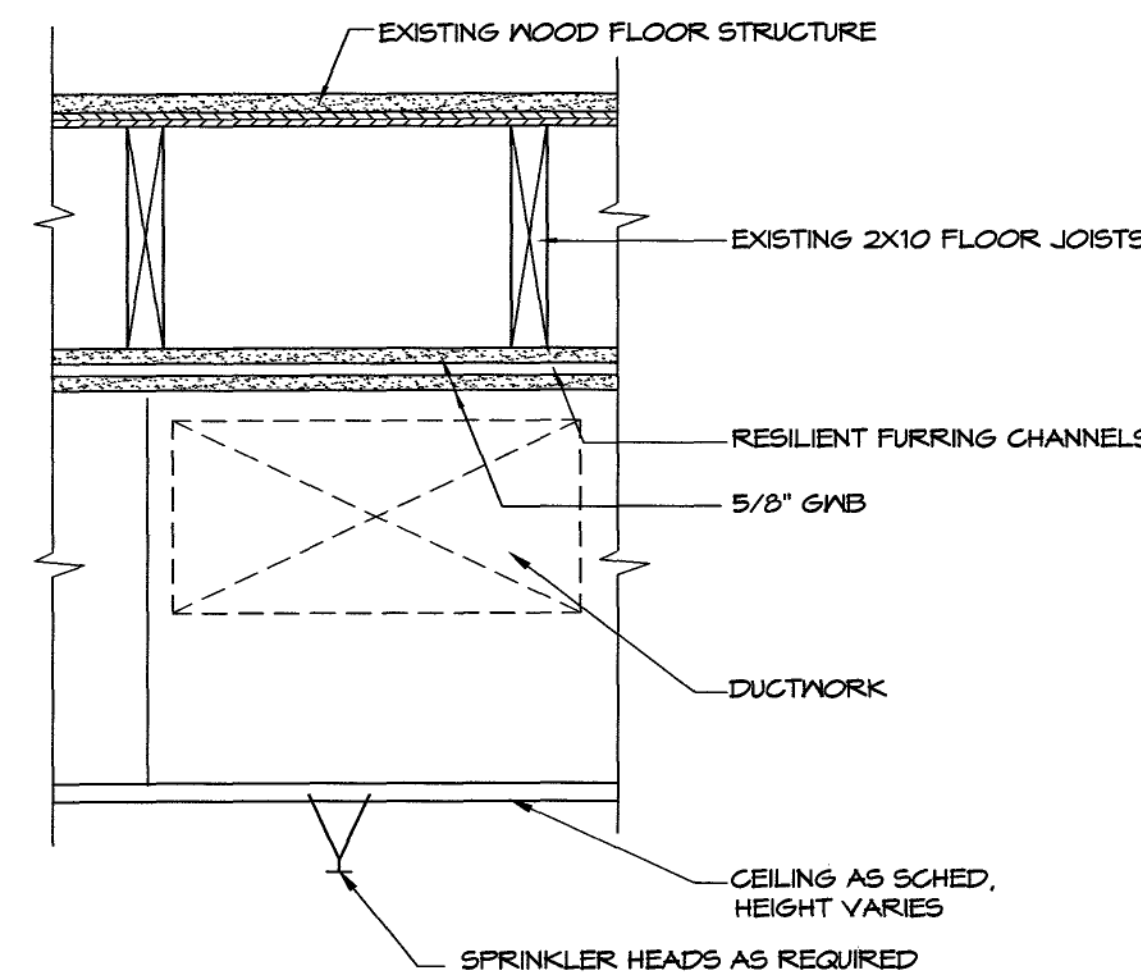

RATED FLOOR / CEILING ASSEMBLY
 UL DESIGN NO. L511 2-HOUR RATED

FIRE RATED CEILING PLAN & DETAILS

PHASE 2

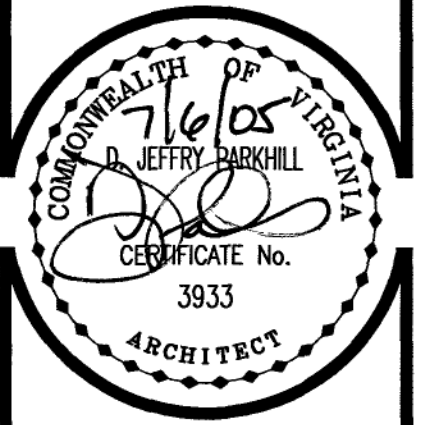

COMMISSION No.

04102

SHEET

A1-4

No. 10 of 18

© COPYRIGHT 2005 HUGHES ASSOCIATES ARCHITECTS PROFESSIONAL CORPORATION