

DOOR TYPES

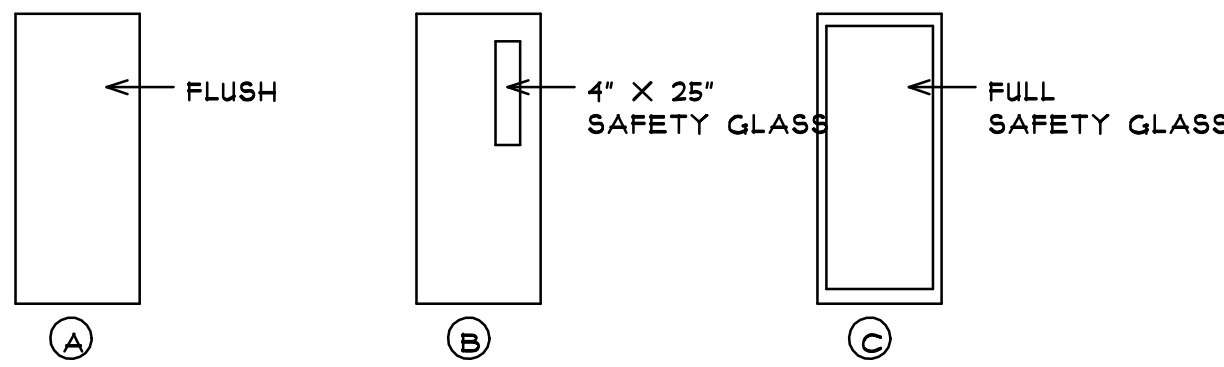

DOOR SCHEDULE

OPG NO.	SIZE			DOOR			FRAME		GRILLE OR U.C.	H'DWLR	REMARKS	OCCUPANCY
	W	H	T	TYPE	MAT.	GL.	MAT.	DET				
01	PR 3'-0"	7'-0"	1 3/4"	C	AL	TEMP	AL	-	-	SET # 1	DARK BRONZE TO MATCH EX	30
02	3'-0"	7'-0"	1 3/4"	B	HM	TEMP	HM	-	-	SET # 2	2" HEAD ON FRAME, 4 3/4" T.	1
03	3'-0"	7'-0"	1 3/4"	B	HM	TEMP	HM	-	-	SET # 2	2" HEAD ON FRAME, 4 3/4" T.	1
04	3'-0"	7'-0"	1 3/4"	B	HM	TEMP	HM	-	-	SET # 2	2" HEAD ON FRAME, 4 3/4" T.	1
05	PR 3'-0"	7'-0"	1 3/4"	A	HM	-	HM	-	-	SET # 3	2" HEAD ON FRAME, 4 3/4" T.	0
06	3'-0"	7'-0"	1 3/4"	A	HM	-	HM	-	-	SET # 4	2" HEAD ON FRAME, 4 3/4" T. REINF. FOR CLOSER	1
07	3'-0"	7'-0"	1 3/4"	B	HM	TEMP	HM	-	-	SET # 5	2" HEAD ON FRAME, 4 3/4" T.	4
08	3'-0"	7'-0"	1 3/4"	B	HM	TEMP	HM	-	-	SET # 4	2" HEAD ON FRAME, 4 3/4" T.	1
09	3'-0"	7'-0"	1 3/4"	EX	EX	-	EX	-	-	SET # 2	RELOCATED SEE DEMOLITION PLAN	9

DOOR HARDWARE SETS

SET # 1	EXISTING BB HINGES 1 LOCK SET ANSI X-86 EXISTING CLOSER 1 SET WEATHERSTRIP 1 SWEEP EXISTING LOCK BOLTS INACTIVE SWING
SET # 2	1 1/2 PAIR BB HINGES 1 LOCKSET SET ANSI X-86 1 CLOSER
SET # 3	1 1/2 PAIR BB HINGES 1 LOCKSET SET ANSI X-86 1 CLOSER 1 SET WEATHERSTRIP
SET # 4	1 1/2 PAIR BB HINGES 1 PANIC BAR ANSI A 156.3 GRADE 1 1 CLOSER

NOTES:
1. TEMP. = TEMPERED GLAZING.

FINISH NOTES

- FINISH NOTES:
1. ALL COLORS TO BE SELECTED BY OWNER.
 2. CONTRACTOR TO COORDINATE WITH SUBCONTRACTORS FOR INSTALLATION OF FINAL FINISHES.
 3. CONTRACTOR TO PROVIDE TEMPORARY PROTECTION FOR FINAL FINISHES. ANY SURFACE DAMAGE SHALL BE REPAIRED AT NO COST TO THE OWNER, PRIOR TO FINAL ACCEPATANCE.
 4. ALL PAINT SHALL BE ONE COAT PRIMER, TWO COATS FINAL LATEX PAINT
 5. ACT : FISSURED 2 X 2 LAY-IN, REVEALED EDGE, WHITE TILE AND GRID
 6. ALLOWANCES: CARPET TILE INCLUDING MATERIAL, LABOR AND SUPPLIES \$14.25/SF
CERAMIC TILE INCLUDING MATERIAL, LABOR AND SUPPLIES \$ 10.25/ SF

FINISH SCHEDULE

SPACE NUMBER	SPACE NAME	FLOOR	BASE		WALLS		CEILING		SUSP. HEIGHT	REMARKS
			MAT.	FIN.	MAT.	FIN.	MAT.	FIN.		
01	HALL	CARPET TILES	VIN	-	GWB	PAINT	ACT	-	11'-4"	WITH BULKHEAD AND CEILING TROUGH
02	OFFICE	CARPET TILES	VIN	-	GWB	PAINT	ACT	-	11'-4"	WITH BULKHEAD AND CEILING TROUGH
03	OFFICE	CARPET TILES	VIN	-	GWB	PAINT	ACT	-	11'-4"	WITH BULKHEAD AND CEILING TROUGH
04	OFFICE	CARPET TILES	VIN	-	GWB	PAINT	ACT	-	11'-4"	WITH BULKHEAD AND CEILING TROUGH
05	HALL	CARPET TILES	VIN	-	GWB	PAINT	ACT	-	11'-4"	WITH BULKHEAD AND CEILING TROUGH
06	COPY	CARPET TILES	VIN	-	GWB	PAINT	ACT	-	11'-4"	-
07	OPEN OFFICE	CARPET TILES	VIN	-	GWB	PAINT	ACT	-	11'-4"	11'-4" NEW, EXISTING CLG. 10'-2 1/2"
08	SAFE	CARPET TILES	VIN	-	GWB	PAINT	ACT	-	8'-0"	-
09	FILES	CARPET TILES	VIN	-	GWB	PAINT	ACT	-	8'-0"	-
10	UNISEX	CERAMIC TILES	VIN	-	GWB	PAINT	ACT	-	9'-0"	-
11	BREAK	CERAMIC TILES	VIN	-	GWB	PAINT	ACT	-	11'-4"	-
12	HALL	CARPET TILES	VIN	-	GWB	PAINT	ACT	-	11'-4"	COORDINATE MAX. HEIGHT
13	OFFICE	CARPET TILES	VIN	-	GWB	PAINT	ACT	-	8'-0"	-
14	OPEN OFFICE	CARPET TILES	VIN	-	GWB	PAINT	ACT	-	8'-0"	-

CRAIGHEAD ASSOCIATES

Architects, Designers, Construction Managers

3534 BRAMBLETON AVENUE SW
SUITE 18
ROANOKE, VIRGINIA 24018
(540) 774-5324
rcraigheadarchitect@yahoo.com

RENOVATIONS FOR

COULTER OFFICE BUILDING

401 S. JEFFERSON ST
ROANOKE, VA.

△	_____	_____
△	_____	_____
△	_____	_____
△	_____	_____
△	_____	_____
△	_____	_____
REVISIONS		DATE

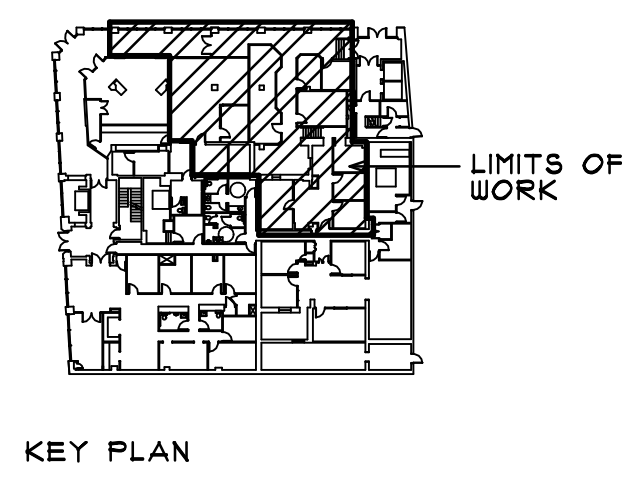
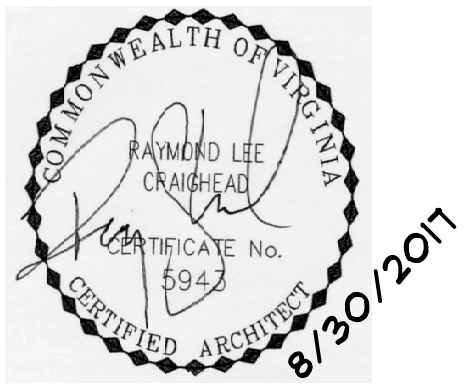

INTERIOR ALTERATIONS FOR
WESTERN VIRGINIA
WATER AUTHORITY

PROJECT NO: 2017043
DATE: 06/15/2017
DRAWN BY: RLC
CHECKED BY: RLC

APPROVED FOR THE CONTRACTOR _____ DATE _____

APPROVED FOR THE OWNER _____ DATE _____

A-5
SCHEDULES
SCALE: AS NOTED
GRAPHIC:

NOTE: THE DESIGN and concept indicated by this print and accompanying documents are the sole property of craighead and associates, architects. they may not be used, copied, altered or reproduced in any form or manner, nor may they be assigned to any third party without written permission of the architects. prints not bearing the signed architects seal shall be schematic or design development drawing only, not for construction.