

WATER AND SEWER MAIN NOTES:

1. ALL CONSTRUCTION METHODS AND MATERIALS SHALL CONFORM TO THE PROJECT MANUAL AND THE LATEST EDITION OF THE WESTERN VIRGINIA REGIONAL DESIGN AND CONSTRUCTION STANDARDS AVAILABLE AT WWW.WESTERNWATER.ORG OR BY CONTACTING THE WESTERN VIRGINIA WATER AUTHORITY (AUTHORITY) AT 540-853-5700. THE PROJECT SHALL ALSO COMPLY WITH THE GOVERNING JURISDICTION'S STANDARDS AND OTHER AGENCY STANDARDS (E.G., VDOT, DEQ, DCR, VHA, ETC.) WHERE APPLICABLE. IN CASE OF CONFLICT, THE MOST STRINGENT REQUIREMENT SHALL APPLY.
2. THE AUTHORITY WILL INSTALL ALL NEW WATER SERVICE METERS AND REMOVE ALL EXISTING WATER SERVICE METERS. THE CONTRACTOR SHALL INSTALL COMPLETE NEW WATER SERVICES INCLUDING THE METER SETTER AND BOX IN CONFORMANCE WITH THE AUTHORITY'S STANDARDS. FOLLOWING METER REPLACEMENT BY THE AUTHORITY, THE CONTRACTOR SHALL DEMOLISH THE EXISTING WATER METER SETTER AND BOX. THE CONTRACTOR SHALL COORDINATE EXISTING METER REMOVAL AND NEW METER INSTALLATION DIRECTLY WITH THE AUTHORITY. THE CONTRACTOR SHALL PROVIDE AT LEAST THREE (3) BUSINESS DAYS ADVANCE NOTICE TO THE AUTHORITY PRIOR TO BEGINNING METER INSTALLATIONS. THE CONTRACTOR SHALL SEQUENCE CONSTRUCTION ACTIVITY TO RECEIVE NEW METERS BEFORE CONTACTING THE AUTHORITY FOR WATER METER REPLACEMENT.
3. ALL LIVE CONNECTIONS TO EXISTING WATERLINES SHALL BE PERFORMED BY THE AUTHORITY. THE CONTRACTOR SHALL PROVIDE FULL STAINLESS STEEL TAPPING SLEEVE(S) AND VALVE(S). THE CONTRACTOR SHALL EXCAVATE TO THE EXISTING WATERLINE, SHORE THE TRENCH PER OSHA REQUIREMENTS, CLEAN THE EXISTING WATERLINE, AND INSTALL THE TAPPING SLEEVE AND VALVE PRIOR TO THE AUTHORITY PERFORMING THE TAP. THE CONTRACTOR SHALL NOTIFY THE AUTHORITY'S INSPECTOR AT LEAST SEVENTY-TWO (72) HOURS PRIOR TO REQUIRING THE CONNECTION.
4. ALL LIVE CONNECTIONS TO EXISTING SANITARY SEWERLINES SHALL BE PERFORMED BY THE AUTHORITY. THE CONTRACTOR SHALL EXCAVATE TO THE EXISTING SEWERLINE, SHORE THE TRENCH PER OSHA REQUIREMENTS, AND CLEAN THE EXISTING SEWERLINE PRIOR TO THE AUTHORITY PERFORMING THE TAP. THE CONTRACTOR SHALL NOTIFY THE AUTHORITY'S UTILITY LINE SERVICES DIVISION AT 540-853-2792 AT LEAST SEVENTY-TWO (72) HOURS PRIOR TO REQUIRING THE CONNECTION.
5. THE CONTRACTOR SHALL PERFORM ALL MANHOLE CONNECTIONS. THE CORING AND BOOT INSTALLATION SHALL BE INSPECTED AND APPROVED BY AN AUTHORITY CONSTRUCTION INSPECTOR PRIOR TO ACTIVATING SEWER SERVICE. THE CONTRACTOR SHALL NOTIFY THE AUTHORITY'S CONSTRUCTION INSPECTOR RESPONSIBLE FOR THE PROJECT AT LEAST ONE (1) DAY PRIOR TO INITIATING THE MANHOLE CONNECTION.
6. PRIOR TO CONSTRUCTION IN THE RIGHT-OF-WAY, ALL APPLICABLE PERMIT(S) FROM THE GOVERNING JURISDICTION AND/OR AGENCY MUST BE OBTAINED AND A COPY KEPT ON THE PROJECT SITE.
7. FOR PROJECTS REQUIRING TRAFFIC CONTROL IN THE CITY OF ROANOKE, NOTIFY MANAGER OF TRANSPORTATION, MARK JAMISON, AT 540-853-5471 AT LEAST TWO (2) WEEKS IN ADVANCE OF REQUIRING TRAFFIC CONTROL. FOR A LINE CLOSURE PERMIT IN THE CITY OF ROANOKE, CONTACT THE TRAFFIC ENGINEER, HONG LIU, AT 540-853-2886. TRAFFIC CONTROL SHALL BE PROVIDED IN ACCORDANCE WITH THE H-SERIES SHEETS OF THESE PLANS UNLESS OTHERWISE APPROVED BY THE CITY.
8. THE CONTRACTOR SHALL NOTIFY THE AUTHORITY'S ENGINEERING COORDINATOR, MARK SINK, AT 540-537-3460 AT LEAST THREE (3) DAYS PRIOR TO CONSTRUCTION.
9. A PRE-CONSTRUCTION CONFERENCE FOR WATER MAINS SHALL BE SCHEDULED WITH THE AUTHORITY AT LEAST ONE (1) DAY PRIOR TO ANY CONSTRUCTION.
10. THE CONTRACTOR SHALL HAVE A VALID MISS UTILITY TICKET PRIOR TO EXCAVATION. CONTACT MISS UTILITY AT 1-800-552-7001.
11. ALL EXISTING UTILITIES MAY NOT BE SHOWN OR MAY NOT BE SHOWN IN THEIR EXACT LOCATION. CONTRACTOR SHALL LOCATE ALL UTILITIES AND DETERMINE ALL INVERTS PRIOR TO CONSTRUCTION TO ALLOW FOR ADJUSTMENTS DUE TO CONFLICTS WITH OTHER UTILITIES. THE CONTRACTOR SHALL COMPLY WITH THE VIRGINIA STATE WATERWORKS REGULATIONS, SECTION 1204C5-500-1150, AND THE VIRGINIA STATE SEWAGE COLLECTION AND TREATMENT REGULATIONS WHERE LINES CROSS.
12. AN APPROVED SET OF PLANS AND PERMITS MUST BE AVAILABLE AT THE CONSTRUCTION SITE AT ALL TIMES.
13. CONSTRUCTION DEBRIS SHALL BE CONTAINERIZED IN ACCORDANCE WITH THE VIRGINIA LITTER CONTROL ACT.
14. THE CONTRACTOR'S CERTIFIED RESPONSIBLE LAND DISTURBER SHALL BE RESPONSIBLE TO IMPLEMENT ALL EROSION AND SEDIMENT CONTROLS REQUIRED. ALL EROSION AND SEDIMENT CONTROL MEASURES SHALL BE IN ACCORDANCE WITH THESE PLANS AND THE LATEST EDITION OF THE VIRGINIA EROSION AND SEDIMENT CONTROL HANDBOOK, AND SHALL BE INSTALLED PRIOR TO CONSTRUCTION. THE AUTHORITY MAY REQUIRE CHANGES TO AN APPROVED PLAN WHERE INSPECTION HAS REVEALED THAT THE PLAN IS INADEQUATE TO SATISFY APPLICABLE REGULATIONS.
15. THE CONTRACTOR SHALL PROVIDE ADEQUATE MEANS OF CLEANING ALL VEHICLES AND EQUIPMENT PRIOR TO ENTERING PUBLIC STREETS. IT IS THE CONTRACTOR'S RESPONSIBILITY TO ENSURE THAT THE STREETS ARE KEPT IN A CLEAN, MUD- AND DUST-FREE CONDITION AT ALL TIMES.
16. FIELD CHANGES SHALL BE APPROVED BY THE AUTHORITY'S ENGINEERING DIVISION PRIOR TO SUCH CONSTRUCTION. NO ADDITIONAL PAY ITEMS SHALL BE MADE TO CONTRACTOR FOR WORK PERFORMED WITHOUT PRIOR APPROVAL FROM AUTHORITY'S PROJECT MANAGER.
17. THE CONTRACTOR SHALL MAKE PROVISIONS TO PROVIDE ACCESS TO ALL PROPERTIES DURING CONSTRUCTION AND SHALL MAINTAIN SAFE ACCESSIBILITY TO FIRE HYDRANTS AT ALL TIMES.
18. THE CONTRACTOR SHALL BE RESPONSIBLE FOR LOCATING AND UNCOVERING ALL MANHOLES AFTER PAVING. MANHOLE RIMS SHALL BE INSTALLED TO GRADE AND FLUSH WITH THE FINAL PAVEMENT.
19. UNREPAIRED ROADWAYS OPENED TO TRAFFIC SHALL HAVE, AT A MINIMUM, COMPACTED AGGREGATE MATERIAL VDOT 21A OR 21B FLUSH WITH THE ADJACENT ROADWAY SURFACE AND SHALL BE INSPECTED AND REPAIRED ON A DAILY BASIS. SOME AREAS WILL REQUIRE A TEMPORARY PATCH UNTIL FINAL PAVING CAN BE COMPLETED.
20. ALL EXCAVATIONS, INCLUDING DEMATERING (IF NEEDED), AND BACKFILLING FOR STRUCTURES AND TRENCHES SHALL BE PERFORMED IN ACCORDANCE WITH SPECIFICATION SECTIONS 312316 AND 312319 AND DETAIL C-15. ALL BACKFILL MATERIAL USED SHALL ADHERE TO THE REQUIREMENTS OF SPECIFICATION SECTION 312323.
21. THE CONTRACTOR SHALL NOT EXCAVATE MORE TRENCH LENGTH THAN CAN BE RESTORED WITHIN THE SAME WORK DAY. ALL TRENCHES SHALL BE BACKFILLED OR PLATED AT THE END OF EACH WORK DAY OR WHEN THE CONTRACTOR IS NOT ON SITE.
22. THE CONTRACTOR SHALL SUPPLY THE AUTHORITY WITH CORRECT AS-BUILT PLANS BEFORE SUBSTANTIAL COMPLETION WILL BE GRANTED.
23. CONTRACTOR SHALL RECORD VERTICAL AS-BUILT DATA TO INCLUDE DEPTH OF WATER MAIN, WATER MAIN FEATURES & ALL UTILITY CROSSINGS.
24. HORIZONTAL AND/OR VERTICAL BEND FITTINGS SHOWN IN THE PLAN ARE APPROXIMATE. CONTRACTOR TO BE AWARE THAT ALL HORIZONTAL AND/OR VERTICAL BEND FITTINGS MAY NOT BE SHOWN IN THE PLANS.
25. THE WATER MAIN TEST PRESSURE SHALL BE 250 PSI.

SYMBOL LEGEND (PROPOSED)

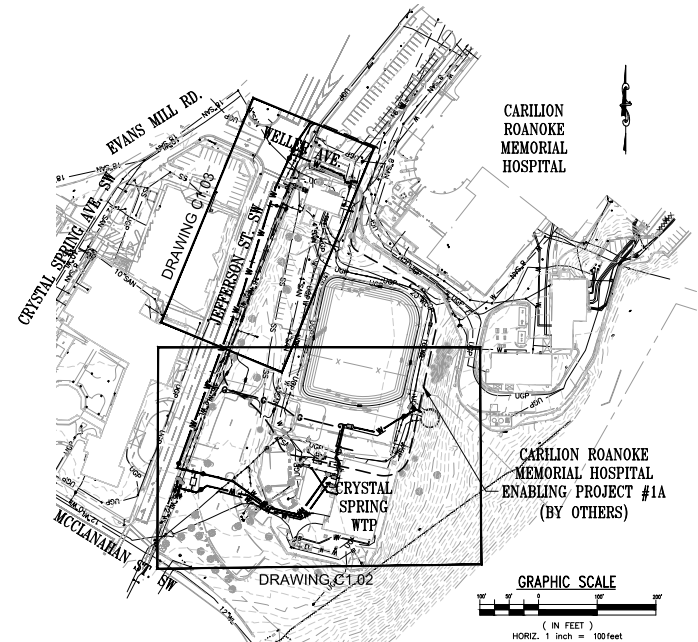
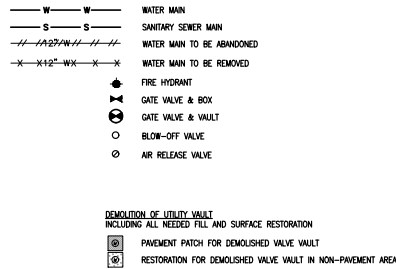

UTILITIES PLAN SHEET LAYOUT
SCALE: 1" = 100'

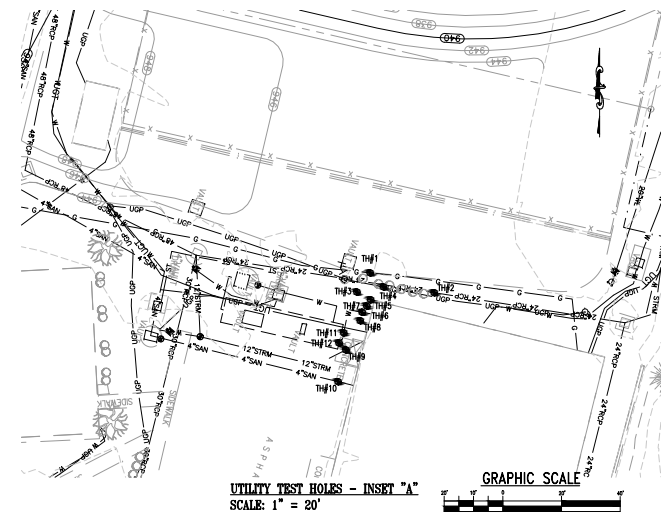

UTILITY TEST HOLES (TH) - DEPTH TO TOP OF UTILITY (INSET A)			
TH NO.	UTILITY	DEPTH	DRAWING
1	1.25" GAS SERVICE	1.54'	C0.01
2	24" STORM DRAIN	4.08'	C0.01
3	2 - 1" WATER LINES	2.80'	C0.01
4	1.25" ELECTRIC LINE	2.44'	C0.01
5	2 - 1.25" ELECTRIC LINES	2.77'	C0.01
6	5 - 1" METAL ELECTRIC CONDUITS	3.00'	C0.01
7	12" WATER LINE AT BUILDING	6.00'	C0.01
8	3 - 2" ELECTRICAL CONDUITS	3.25'	C0.01
9	12" STORM DRAIN	3.50'	C0.01
10	4" SEWER LATERAL	3.23'	C0.01
11	12" WATER LINE AT TANK	5.83'	C0.01
12	END OF NEUTRALIZATION TANK		C0.01



WESTERN VIRGINIA WATER AUTHORITY
601 South Jefferson Street, Suite 300
Roanoke, Virginia 24011

DES: PJM
DRAWN: JES
CHECK: GWP
DATE: 1/24/20

SCALE: AS SHOWN
HORIZ: 1" = 100'
VERT: N/A

CRYSTAL SPRING
PUMP STATION RELOCATION

PROPOSED LEGENDS, NOTES, &
SHEET LAYOUT

DRAWING
C0.01

SHEET
3