

MAJOR DIVISIONS			LETTER SYMBOL	TYPICAL DESCRIPTIONS
Coarse Grained Soils More than 50% of Material by Weight is Coarser than No. 200 Sieve Size	Gravel and Gravelly Soils More than 50% of Coarse Fraction Retained on No. 4 Sieve	Clean Gravels 0–5% Fines*	GW	Fully–Graded Gravels, Gravel–Sand Mixtures, Little or No Fines
		Gravels with Fines >12% Fines*	GP	Gap or Uniform–Graded Gravels, Gravel–Sand Mixtures, Little or No Fines
			GM	Silty Gravels, Gravel–Sand Silt Mixtures
	Sand and Sandy Soils More than 50% of Coarse Fraction Passing No. 4 Sieve	Clean Sand 0–5% fines*	GC	Clayey Gravels, Gravel–Sand–Clay Mixtures
		Sands with Fines >12% Fines	SW	Well–Graded Sands, Gravelly Sands, Little or No Fines
			SP	Gap or Uniform Graded Sands, Gravelly Sands, Little or No Fines
Fine Gravels Soils More than 50% of Material by Weight is Finer than No. 200 Sieve Size	Silt and Clays Low Compressibility Liquid Limit Less than 50%		SM	Silty Sands, Sand–Silt Mixtures
			SC	Clayey Sands, Sand–Clay Mixtures
			ML	Inorganic Silts and Very Fine Sands, Rock Flour, Silty or Clayey Fine Sands or Clayey Silts with Slight Plasticity
	Silt and Clays High Compressibility Liquid Limit Greater than 50%		CL	Inorganic Clays of Low to Medium Plasticity, Gravelly Clays, Sandy Clays, Silty Clays
			OL	Organic Silts and Organic Silty Clays of Low Plasticity
			MH	Inorganic Silts, Micaceous or Diatomaceous Fine Sands or Silty Soils
Highly Organic Soils		CH	Inorganic Clays of High Plasticity	
		OH	Organic Clays of Medium to High Plasticity, Organic Silts	
Highly Organic Soils			PT	Peat, Humus, Swamp Soils with High Organic Contents
* For soils having 5 to 12% fines, use dual symbol such as SP–SM				
UNIFIED SOIL CLASSIFICATION SYSTEM				

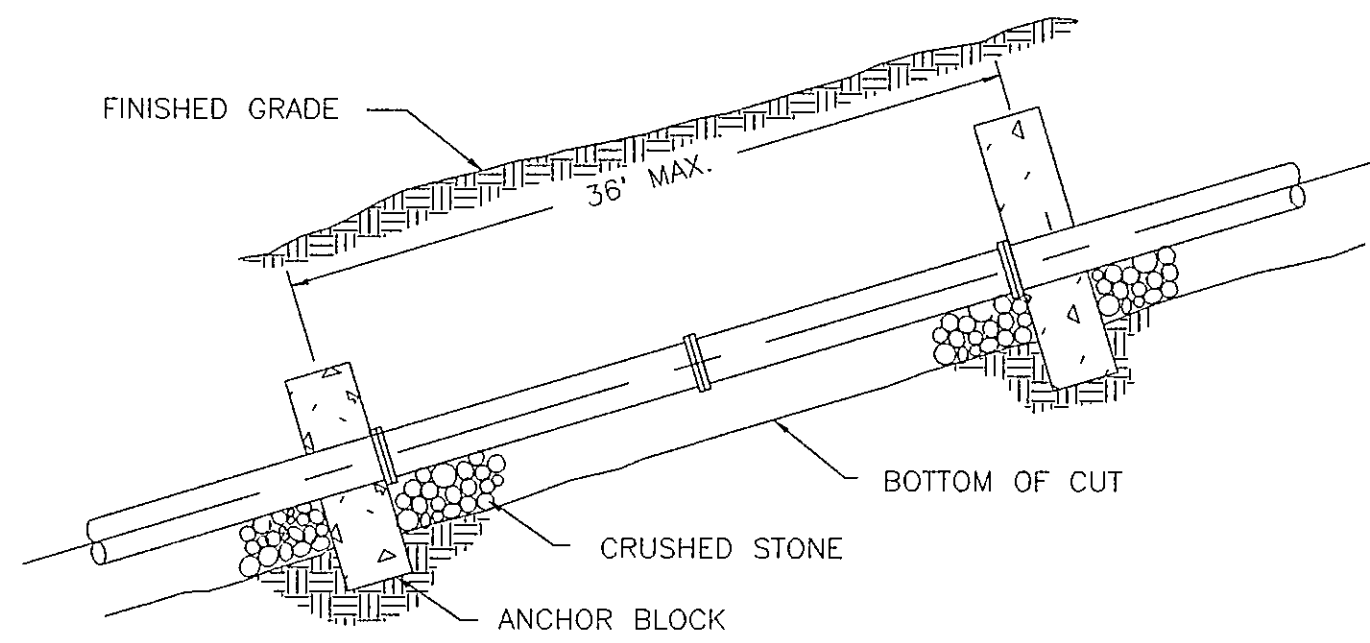

SLOPE ANCHOR SPACING

SLOPE	SPACING
20%-35%	36'
35%-50%	24'
50%-OVER	16'

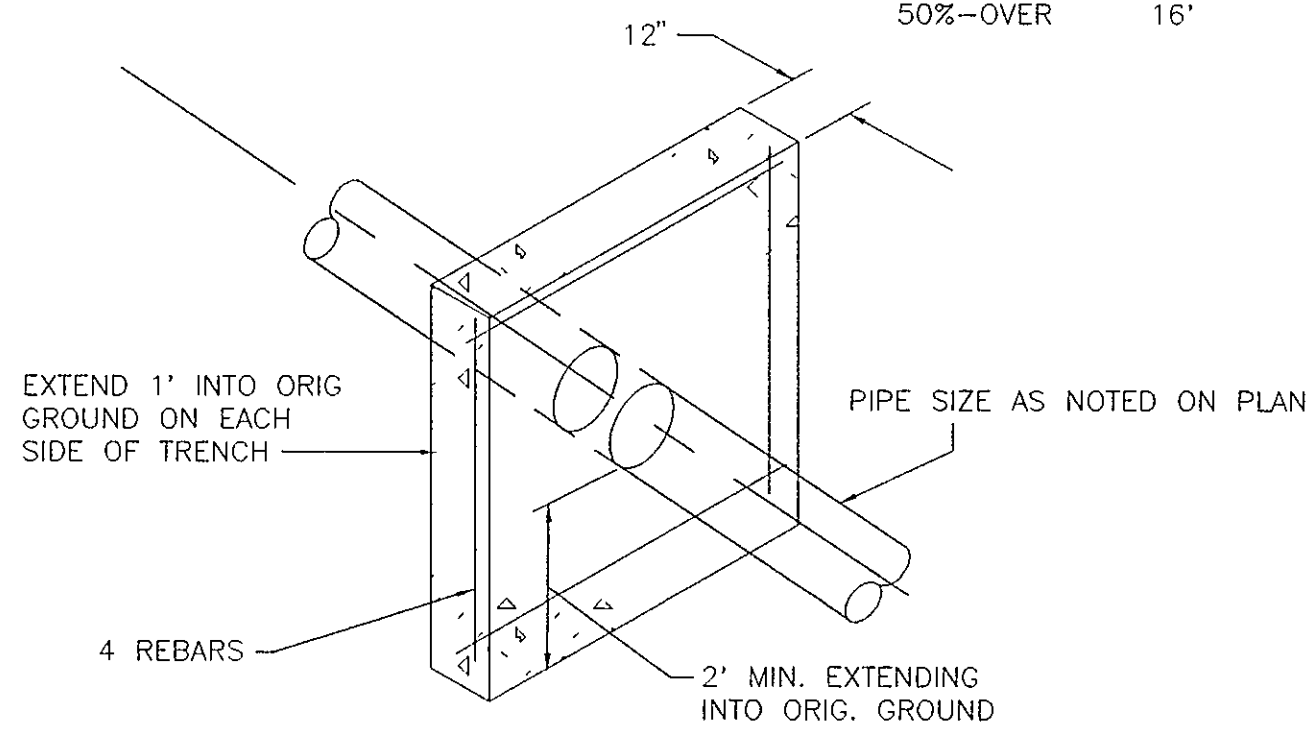

ANCHOR BLOCK DETAIL
NTS

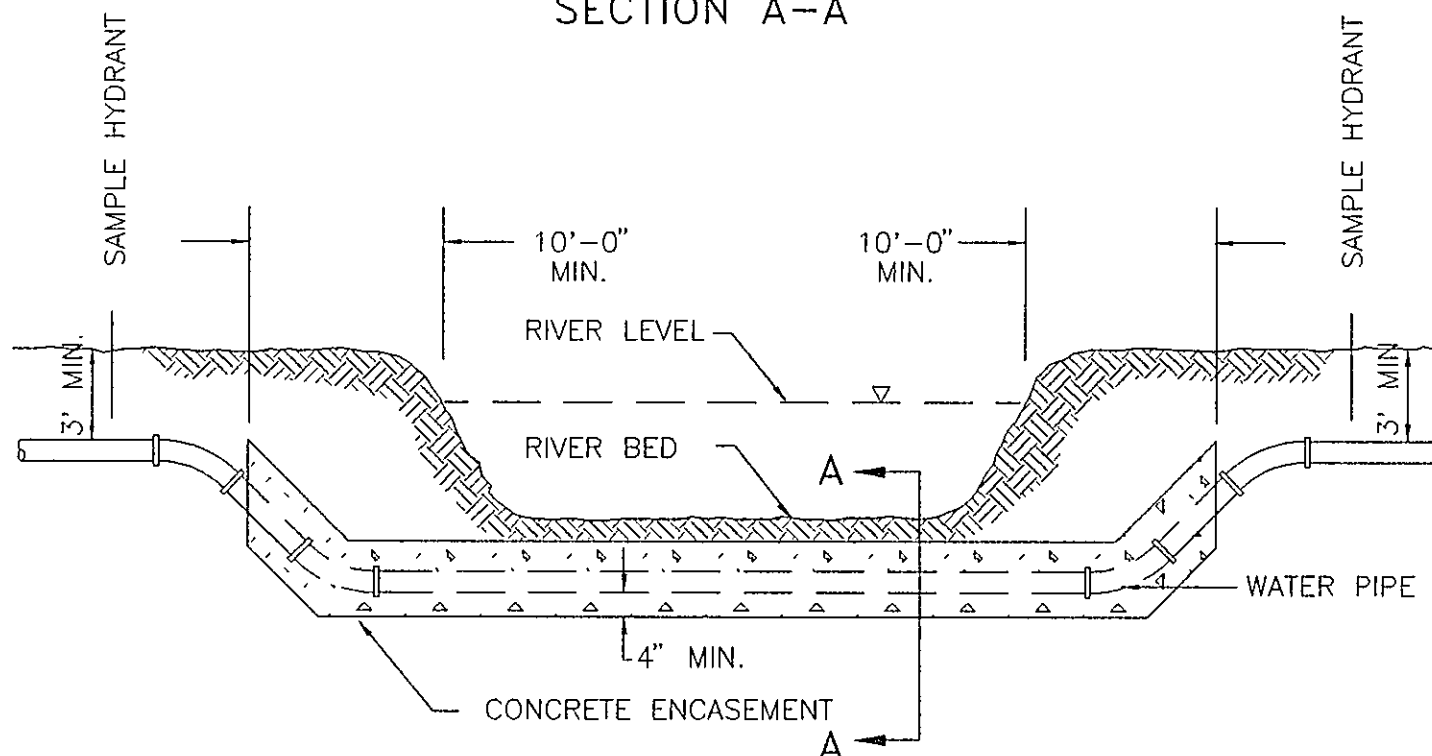
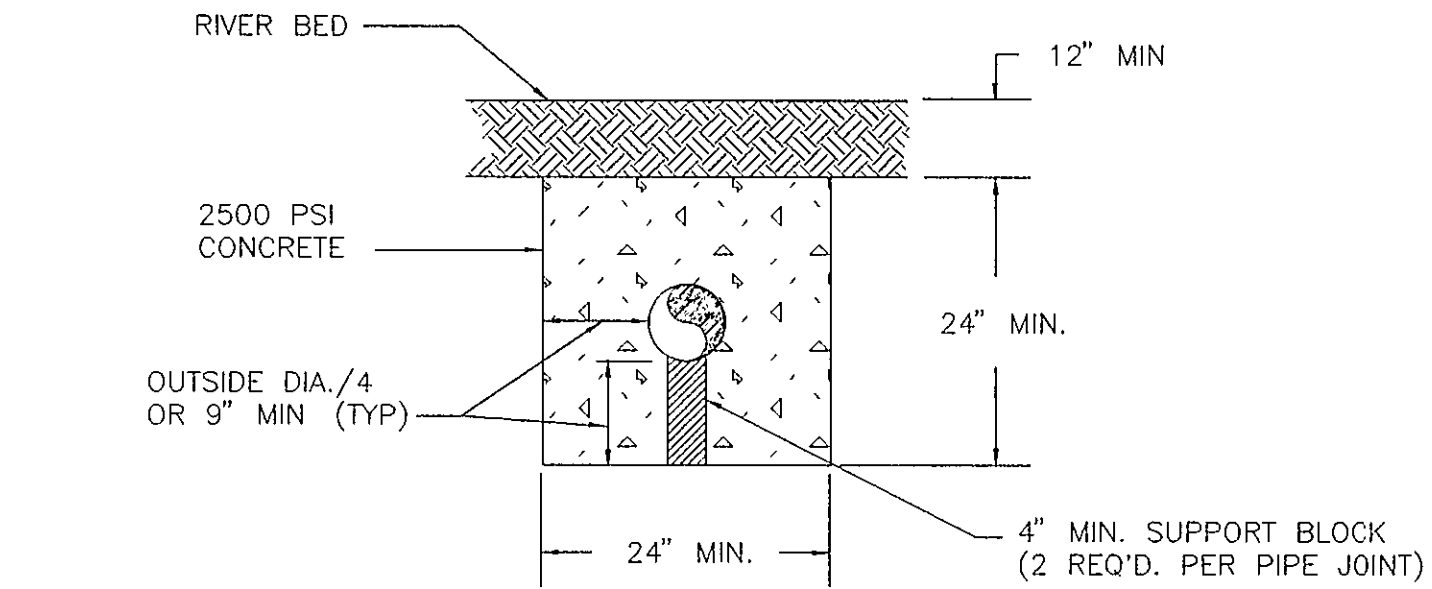

RIVER CROSSING DETAIL
NTS

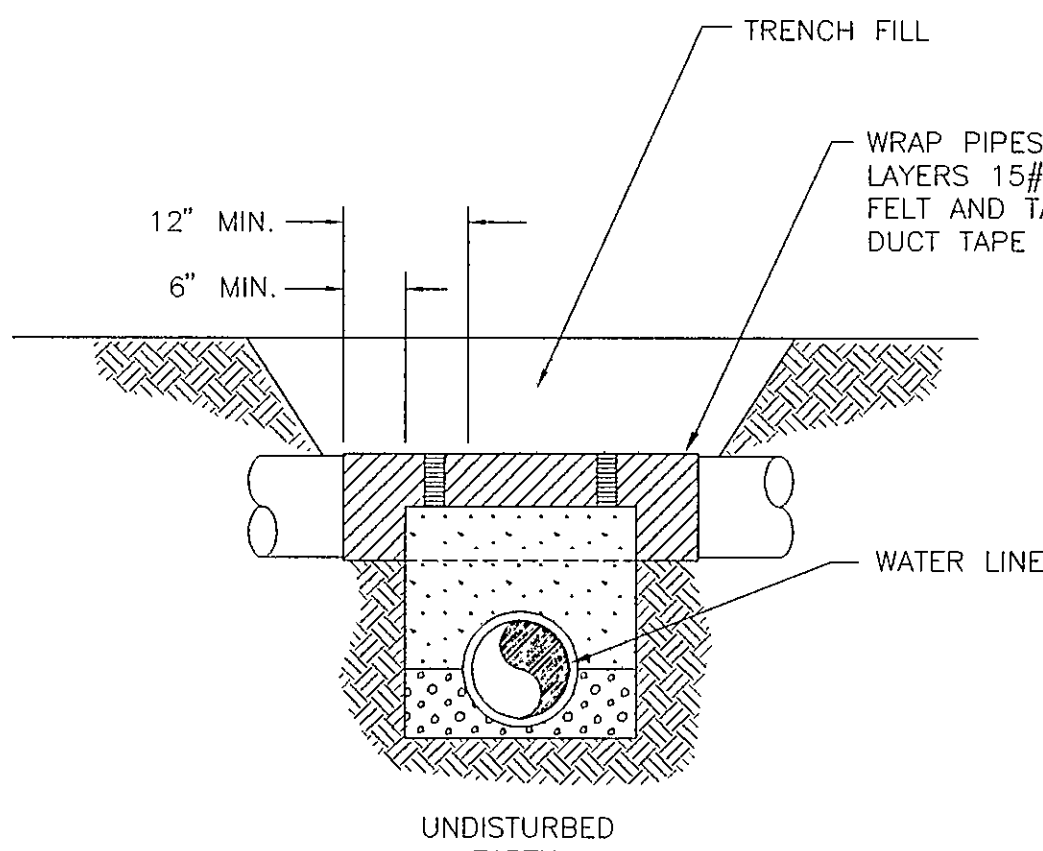

PIPE CROSSING OTHER THAN
SANITARY SEWER
NTS

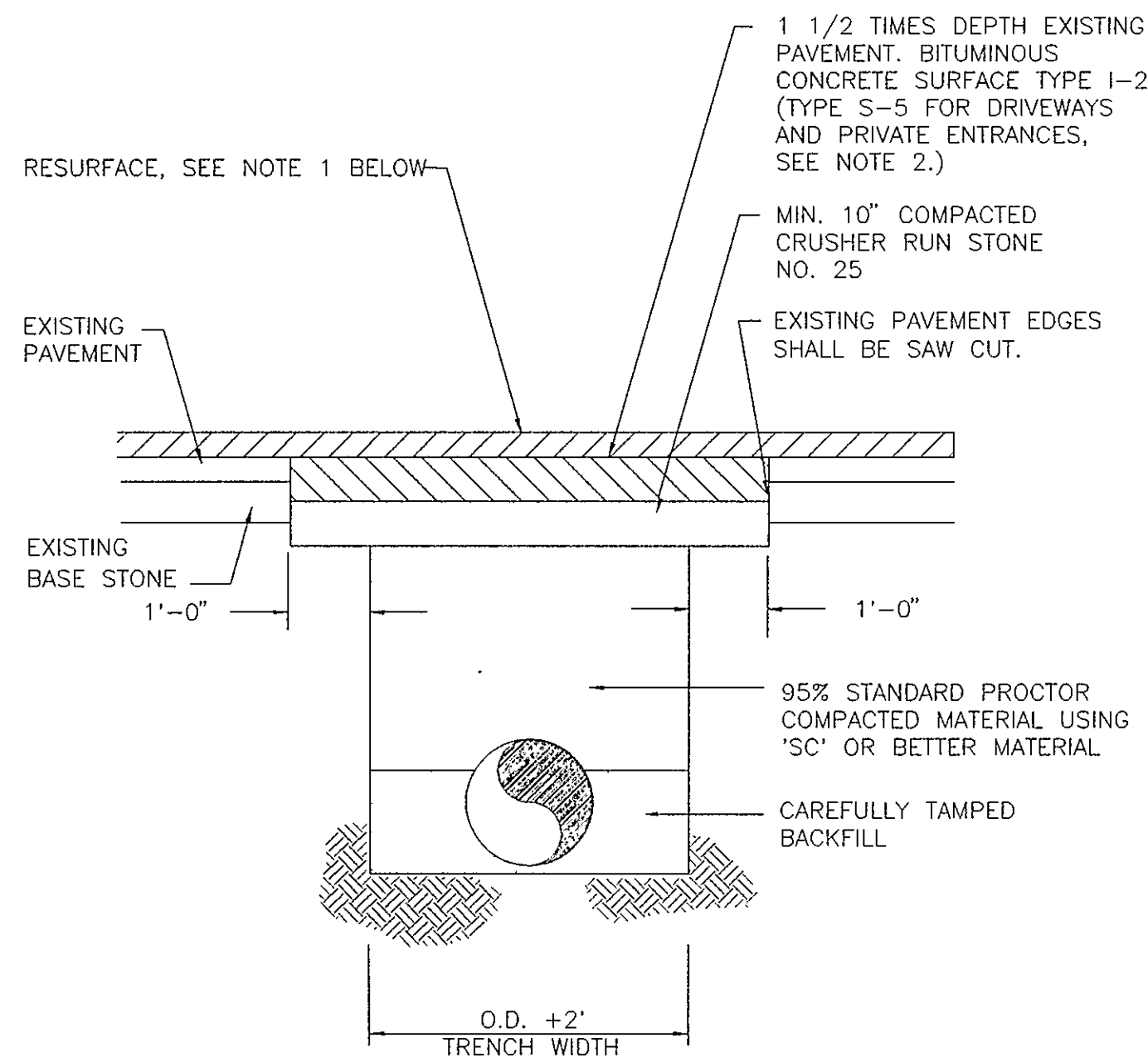
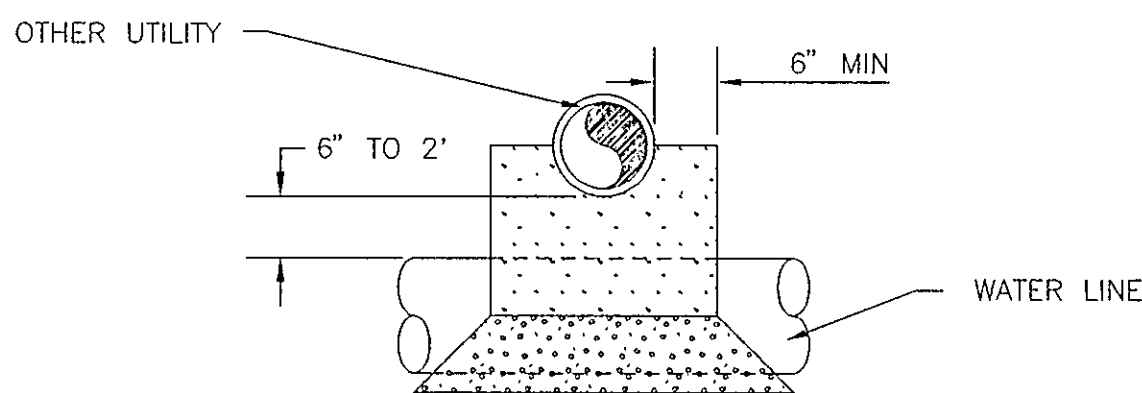

OPEN CUT ROAD and CROSSING DETAIL
NTS

- NOTES:
- 1) ALLPAVED SURFACES OWNED BY THE STATE SHALL BE RESURFACED 25' EACH SIDE OF CUT, AS PER V.D.O.T. SPECIFICATIONS.
 - 2) THIS DETAIL ALSO APPLIES TO ALL PAVED DRIVEWAYS AND ENTRANCES- EXCLUDING 25' RESURFACING EACH WAY
 - 3) WHERE EXISTING SURFACE IS GRAVEL, REPLACEMENT SURFACE TO BE CRUSHER RUN STONE NO. 25

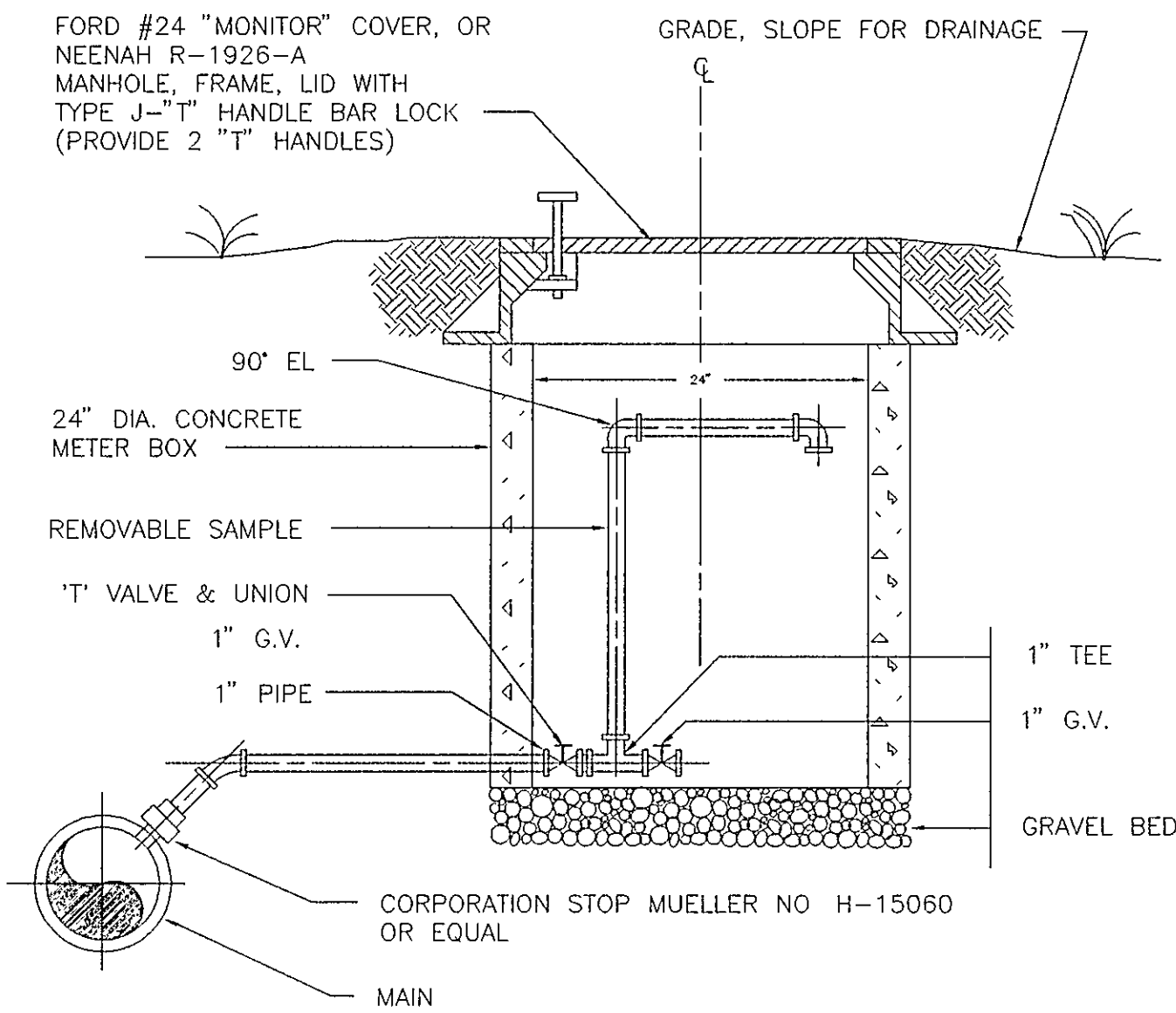

TYPICAL SAMPLE HYDRANT
NTS

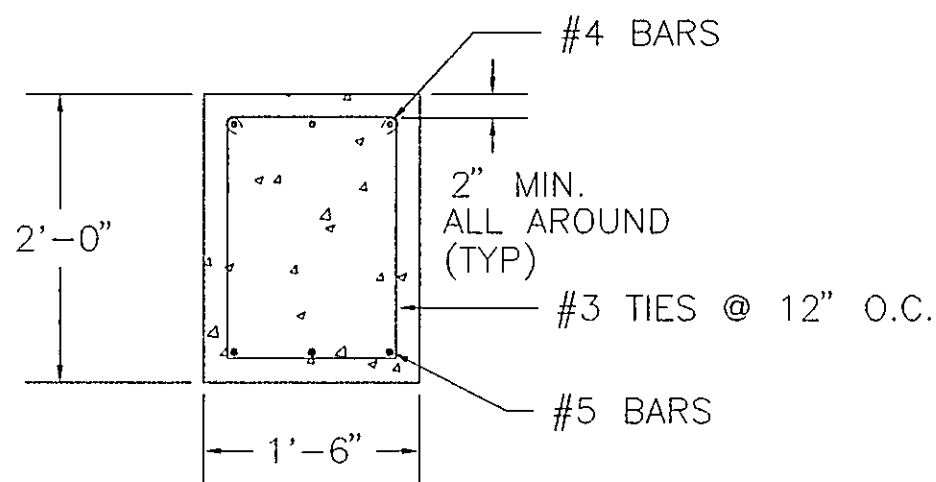
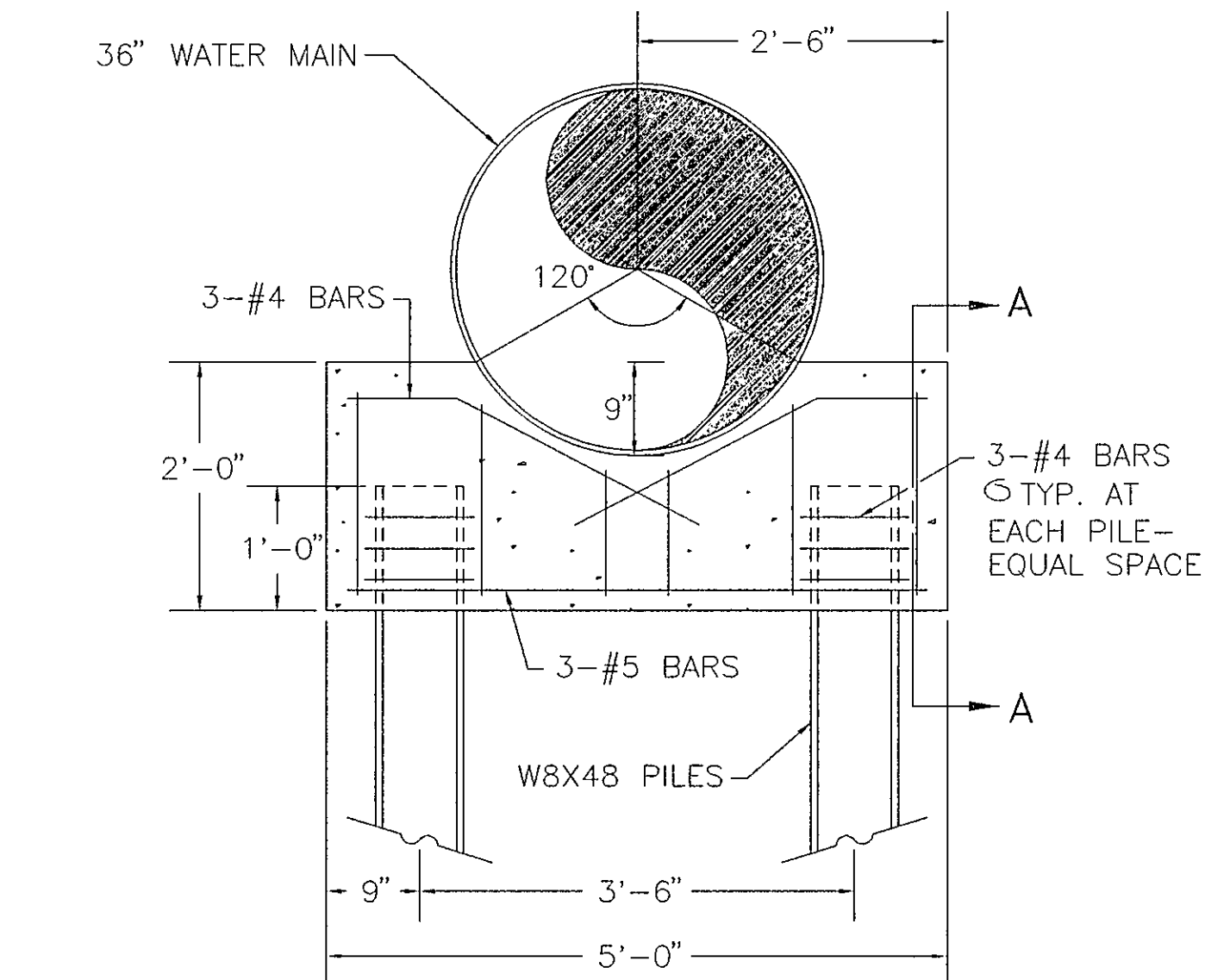

SECTION A-A
PILE CAP DETAIL
NTS

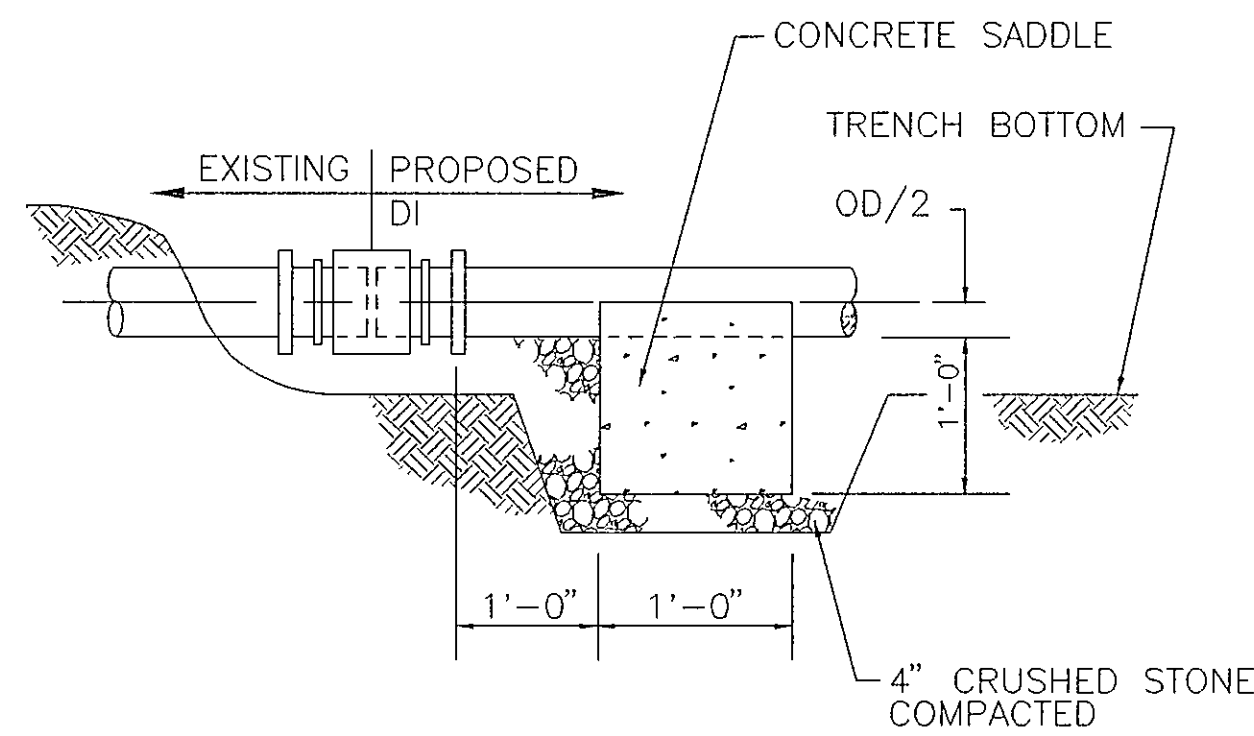

- COUPLING EQUAL TO FERNCO:
- SERIES 1051 WHEN EXISTING IS ASBESTOS CEMENT
- SERIES 1002 WHEN EXISTING IS VITRIFIED CLAY
- SERIES 1006 WHEN EXISTING IS CONCRETE

TYPICAL SEWER LINE COUPLING DETAIL
NTS

AS BUILT

WATER DEP'T. #93-25

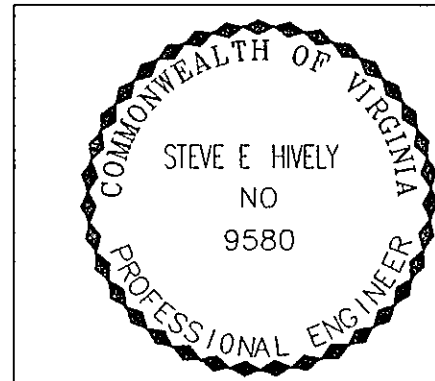

ENGINEER'S SEAL

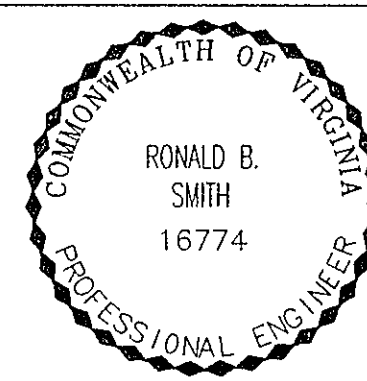

ENGINEER'S SEAL

Architects
Engineers
Planners
Surveyors

Dewberry & Davis

5238 Valleypointe Parkway, Suite One-B
Roanoke, Virginia 24019
☎ 703 362-7725

Carvins Cove, Phase II
City of Roanoke
Roanoke, Virginia

CONTRACT "C2"

DETAILS

Drawn By	ACF
Designed By	RBS
Checked By	SEH
Date	MARCH 93
Scale	AS SHOWN
Plan Number	C2DTRWL2
Zoned	NONE
Sheet	24 of 25
File Number	C1160