

AD11 LABELS:

1. GAS COMPRESSOR LOW OIL LEVEL
2. AFTERCOOLER INLET HIGH GAS TEMPERATURE
3. AFTERCOOLER OUTLET HIGH GAS TEMPERATURE
4. BLOWER DISCHARGE HIGH AIR PRESSURE
5. BLOWER DISCHARGE HIGH AIR TEMPERATURE
6. BLOWER INCOMPLETE UNLOAD SEQUENCE
7. GEAR/BLOWER HIGH BEARING TEMPERATURE
8. COOLING WATER TO BLOWER HEAT EXCH. HIGH TEMPERATURE
9. -
10. ENGINE OVERSPEED
11. ENGINE CYLINDER HIGH EXHAUST TEMPERATURE
12. JACKET WATER HIGH COOLANT PRESSURE
13. INTERCOOLER LEAVING AIR HIGH TEMPERATURE
14. -
15. BLOWER OIL HIGH TEMPERATURE
16. ENGINE OIL HIGH TEMPERATURE
17. GAS TO DIESEL TRANSFER ALARM
18. COOLER WATER LOW FLOW ALARM
19. BLOWER LOADING INCOMPLETE SEQUENCE ALARM
20. BLOWER OIL FILTER HIGH DIFF. PRESSURE ALARM
21. BLOWER OIL LOW PRESSURE ALARM
22. ENGINE OIL LOW PRESSURE ALARM
23. (PLUGGED HOLE)
24. GAS COMPRESSOR LOW SUCTION PRESSURE
25. GAS COMPRESSOR LOW DISCHARGE PRESSURE
26. INSTRUMENT AIR LOW PRESSURE
27. GUIDE VANE INCOMPLETE UNLOAD SEQUENCE
28. OVERLOAD
29. STEAM BOILER LOW WATER LEVEL [SIC]
30. COOLING WATER FROM BLOWER HEAT EXCH. HIGH TEMPERATURE
31. -
32. ENGINE UNDERSPEED
33. ENGINE CYLINDER LOW EXHAUST TEMPERATURE
34. ENGINE VIBRATION
35. GEAR VIBRATION
36. BLOWER VIBRATION
37. BLOWER OIL LOW PRESSURE

38. ENGINE OIL LOW PRESSURE
39. SEWAGE GAS TO NATURAL GAS TRANSFER ALARM
40. INTERCOOLER WATER LOW PRESSURE ALARM
41. -
42. -
43. BLOWER OIL LOW LEVEL ALARM
44. ENGINE OIL LOW LEVEL ALARM
45. INSTRUMENT AIR PRESSURE
46. DIESEL FUEL PRESSURE
47. AIR MANIFOLD PRESSURE
48. BLOWER INLET AIR TEMPERATURE
49. BLOWER DISCH. AIR TEMPERATURE
50. BLOWER OIL PRESSURE
51. ENGINE OIL PRESSURE
52. JACKET WATER PRESSURE
53. INTERCOOLER WATER PRESSURE
54. INTERCOOLER AIR OUT TEMPERATURE
55. STARTING AIR PRESSURE
56. SEWAGE GAS PRESSURE
57. GAS PRESSURE TO INLET VALVES
58. BLOWER DISCHARGE PRESSURE
59. GEAR OIL LEAVING TEMPERATURE
60. BLOWER HEAT EXCH. LEAVING OIL TEMPERATURE
61. ENGINE LUBE OIL IN TEMPERATURE
62. JACKET WATER IN TEMPERATURE
63. C.W.S. TEMP. TO ENG. I.C. & BLOWER OIL HEAT EXCH.
64. BLOWER OIL HEAT EXCH. COOL. WATER OUT TEMP.
65. TEST GAGE (OPEN HOLE)
66. NATURAL GAS PRESSURE
67. BLOWER AIR FLOW
68. ENGINE SPEED
69. BLOWER/GEAR ENTRANCE TEMP.
70. BLOWER OIL OUT TEMPERATURE
71. ENGINE OIL OUT TEMPERATURE
72. JACKET WATER OUT TEMPERATURE
73. INTERCOOLER OUT TO ENG. L.O. HEAT EXCH. TEMP.
74. ENG. OIL HEAT EXCH. WATER TEMP. OUT

75. (UP-IDLE) ENGINE LOADING (DOWN-RUN)
76. (GAGE 0-30psi)
77. (TURN KNOB-"INCREASE")
78. (GAGE 0-30psi)
79. SEWAGE GAS RED-LOCKED OUT GREEN-EFFECTIVE
80. -
81. NATURAL GAS
82. (UP-ON) NATURAL GAS (DOWN-OFF)
83. MAIN BLOWER VANE LOADING PRESSURE
84. (TURN KNOB) BLOWER VANE MANUAL LOADING STATION
85. ACTUAL BLOWER VANE LOADING PRESSURE
86. -
87. SYSTEM - PULL FOR ON PUSH FOR OFF/RESET
88. PERMISSIVE START RED-LOCKED OUT GREEN-PERMISSIVE
89. -
90. -
91. GROUP 2 FUNCTIONS RED-LOCKED OUT GREEN-EFFECTIVE
92. -
93. -
94. TEST (PUSH BUTTON)
95. ALARM SILENCE (PUSH BUTTON)
96. -
97. -
98. SEWAGE GAS COMPRESSOR
99. BLOWER AUX. LUBE PUMP
100. ENGINE AUX. LUBE PUMP
101. START IN AIR [?] STARTING AIR [?]
102. FUEL
103. BLOWER DISCHARGE VALVE
104. BLOWER DISCHARGE VALVE
105. BLOWER BLOWOFF VALVE
106. BLOWER BLOWOFF VALVE
107. (UP-ON) SEWAGE GAS COMPRESSOR (DOWN-OFF)
108. (UP-ON) BLOWER AUX. LUBE PUMP (DOWN-OFF)
109. (UP-ON) ENGINE AUX. LUBE PUMP (DOWN-OFF)

INDICATES FUNCTION TO BE DISABLED.  
REMOVE GAUGE OR SWITCH AND COVER  
OPENING. REMOVE WIRING OR PNEUMATIC  
TUBING FOR FUNCTIONS NOT REMAINING.

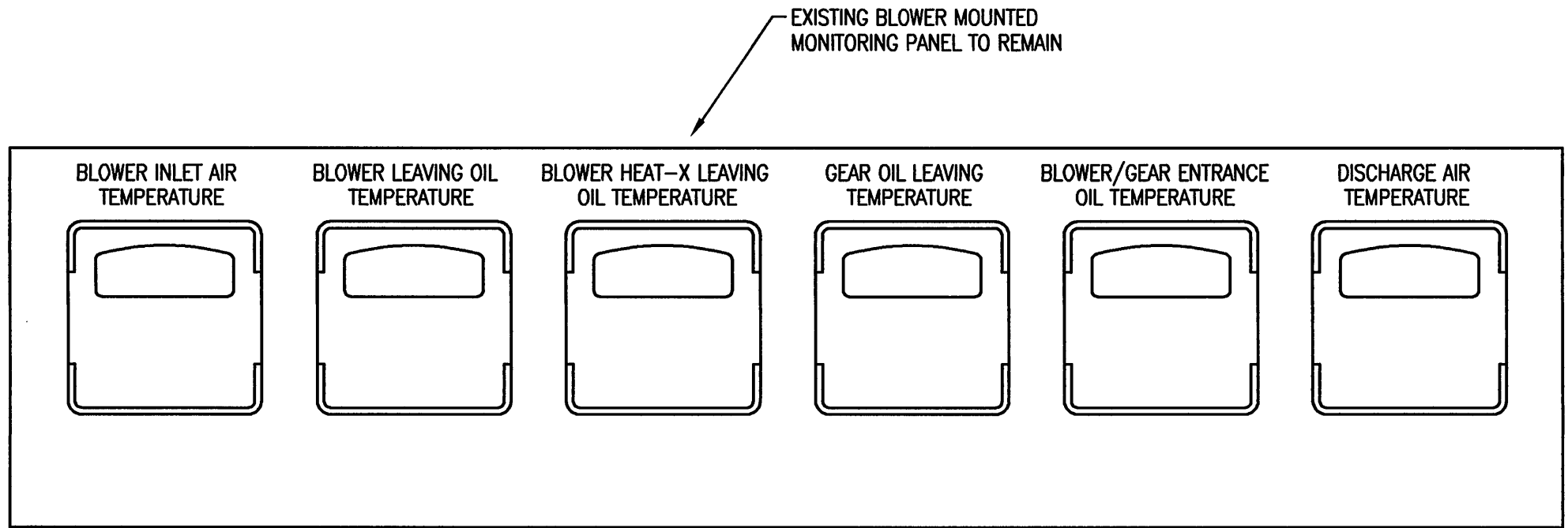

KEY PLAN

GENERAL NOTES

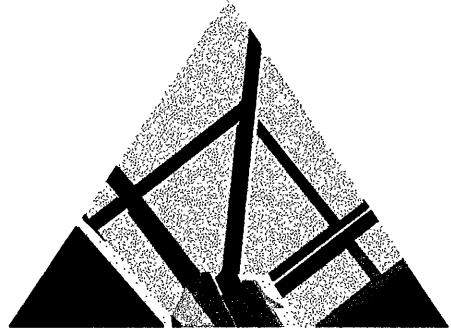

SPECTRUM DESIGN

325 MOUNTAIN AVENUE ROANOKE, VIRGINIA 24016 540.345.8020  
ROANOKE • MARION • VIRGINIA BEACH

ROANOKE SEWAGE  
TREATMENT PLANT  
BLOWER  
ROOM  
RENOVATION

SPECTRUM DESIGN PROJECT NO. 00001

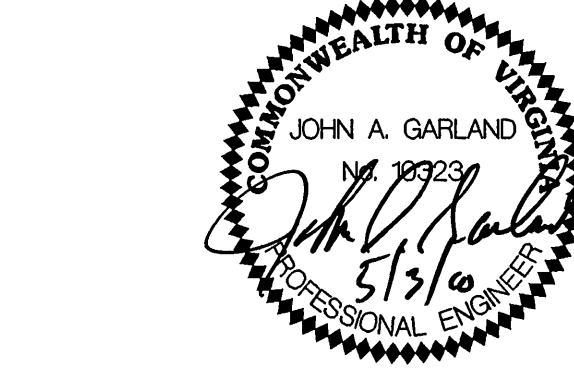

DATE 28 APRIL 2000  
DESIGN ARCHITECT  
PROJECT ARCHITECT  
PROJECT ENGINEER  
CHECKED BY LER  
DRAWN BY CPU  
REVISIONS NUMBER DATE

SHEET TITLE

BLOWER CONTROL  
PANEL DETAIL