

SECTION A
1/4"=1'-0" M601

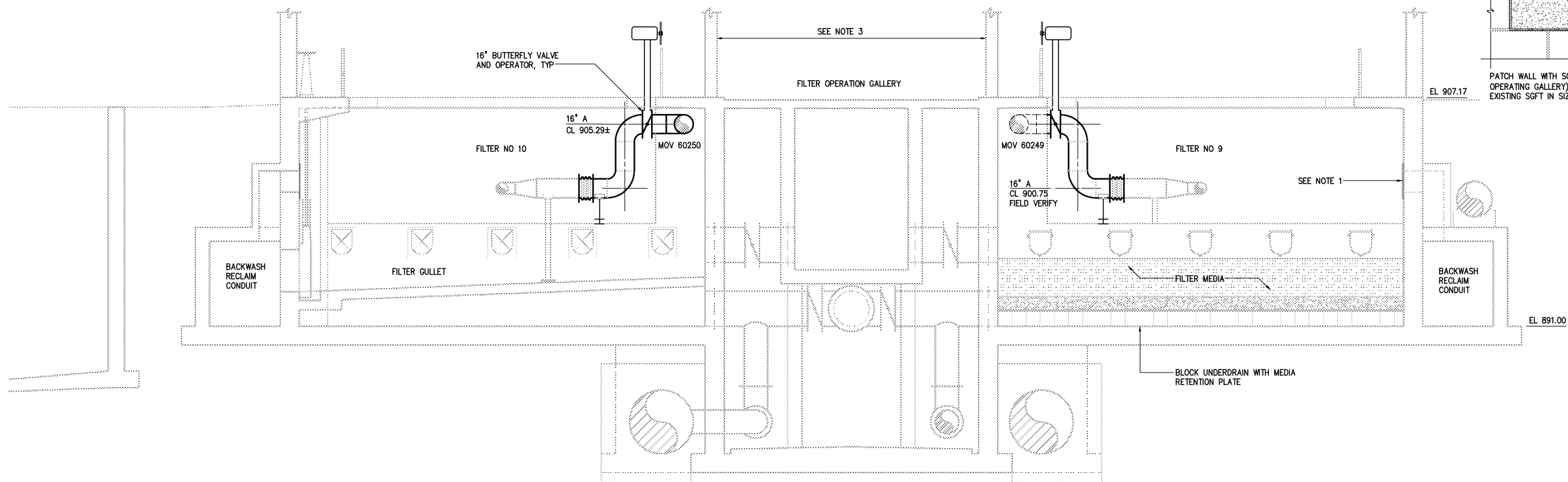

SECTION B
1/4"=1'-0" M601

- NOTES:**
- COVER FILTER OVERFLOW PORT IN FILTER NUMBERS 1-10. SEE DETAIL 4/M604
 - CONTRACTOR VERIFY BOLT PATTERN OF EXISTING WALL THIMBLES PRIOR TO ORDERING NEW SLUICE GATES.
 - CONTRACTOR SHALL REPAIR WALL OF FILTER GALLERY AT LOCATIONS WHERE EXISTING FILTER CONTROL PANELS ARE TO BE REMOVED. SEE DETAIL 10/M602.

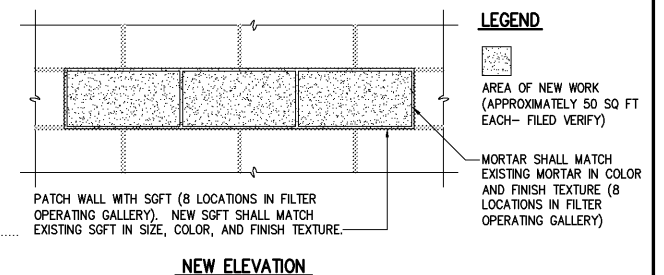
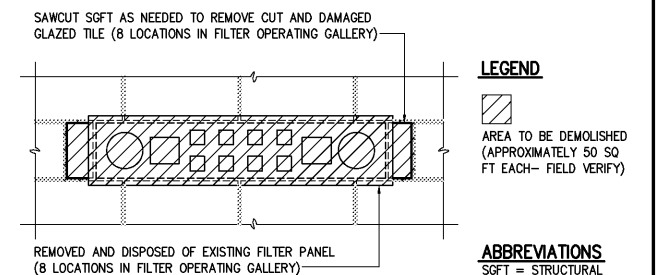

DETAIL 10
1"=1'-0" M602

				DESIGNED	MAF	THIS DOCUMENT ORIGINALLY ISSUED FOR CONSTRUCTION AND SEALED BY ROBERT S. DIFIORE, SEAL NO. 22769	RECORD DRAWING	THIS DRAWING HAS BEEN MODIFIED TO REFLECT FIELD CHANGES REPORTED BY THE CONTRACTOR OR ANOTHER PARTY, BUT NOT VERIFIED BY THE CERTIFYING ENGINEER. THIS DOCUMENT ORIGINALLY ISSUED AND SEALED BY DAVID A. NAILOR, 025465. THIS MEDIA SHALL NOT BE CONSIDERED A CERTIFIED DOCUMENT.	HAZEN AND SAWYER Environmental Engineers & Scientists 4011 WestChase Blvd, Raleigh, North Carolina 27607	CITY OF ROANOKE VIRGINIA	REGIONAL WATER POLLUTION CONTROL PLANT PROCESS TRAIN IMPROVEMENTS	EFFLUENT FILTER MODIFICATIONS	MECHANICAL SECTIONS	THE SCALE BAR SHOWN BELOW MEASURES ONE INCH LONG ON THE ORIGINAL DRAWING.	DATE MARCH 2004	H & S JOB NUMBER 30788B	CONTRACT NUMBER B	DRAWING NUMBER M602
				DRAWN	RWB													
				CHECKED														
				PROJ. ENGR.	DAN													
3	AS BUILT	OCT 2007	RLT	THIS DOCUMENT ORIGINALLY ISSUED FOR CONSTRUCTION AND SEALED BY RONALD L. TAYLOR, SEAL NO. 024649	APPROVED													
2	CONSTRUCTION	MAR 2004	RLT															
1	REGULATORY APPROVAL	NOV 2003	RLT															
NO.	ISSUED FOR	DATE	BY															