

NOTES:

- 1 METAL DECKING AT ELEVATION 924.50 SHALL BE 1 1/2" DEEP, TYPE C, 20 GAGE. METAL DECKING AT ELEVATION 934.25 SHALL BE 1 1/2" DEEP, TYPE B, 20 GAGE. WELD PATTERN SHALL BE 3/6" WITH 7 SIDELAP CONNECTIONS PER SPAN.
- 2 SEE DRAWING S928 FOR COLUMN SCHEDULE.
- 3 STEEL JOISTS SHALL BE FABRICATED IN ACCORDANCE WITH SPECIFICATION SECTION 05210. SEE DETAIL 11/S928 FOR JOIST CONNECTION TO STEEL BEAM. SEE JOIST LOADING SCHEDULE ON DRAWING S923 FOR JOIST DESIGN LOADS.
- 4 ——— INDICATES MOMENT CONNECTION PER DETAIL 6/S928 OR 7/S928. ALL OTHER BEAM CONNECTIONS SHALL BE SIMPLE CONNECTIONS PER DETAIL 8/S928 UNLESS NOTED OTHERWISE.
- 5 ** INDICATES CONTRACTOR TO COORDINATE DIMENSION WITH HVAC EQUIPMENT MANUFACTURER.

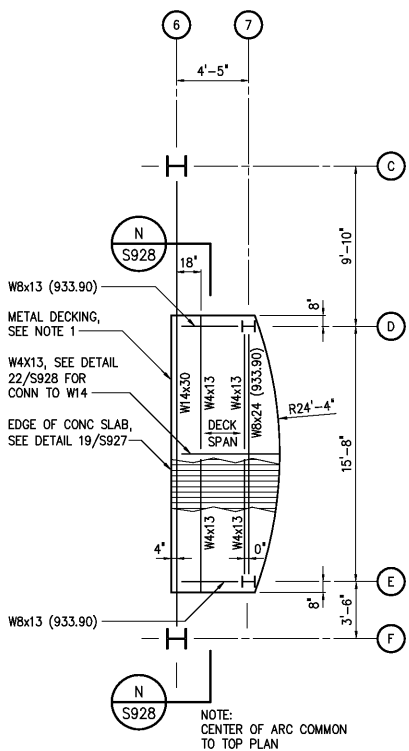

				DESIGNED	BGS
				DRAWN	SMH
				CHECKED	
3	RECORD DRAWING	JAN 2006	RLT	PROJ. ENGR.	DAN
2	CONSTRUCTION	JAN 2004	RLT		
1	REGULATORY APPROVAL	NOV 2003	RLT		
NO.	ISSUED FOR	DATE	BY	APPROVED	

THIS DOCUMENT ORIGINALLY ISSUED FOR CONSTRUCTION AND SEALED BY ROBERT S. DIFIORE, SEAL NO. 22769

RECORD DRAWING

THIS DRAWING HAS BEEN MODIFIED TO REFLECT FIELD CHANGES REPORTED BY THE CONTRACTOR OR ANOTHER PARTY, BUT NOT VERIFIED BY THE CERTIFYING ENGINEER. THIS DOCUMENT ORIGINALLY ISSUED AND SEALED BY CHRISTOPHER T. PHILLIPS, 033796. THIS MEDIA SHALL NOT BE CONSIDERED A CERTIFIED DOCUMENT.

THIS DOCUMENT ORIGINALLY ISSUED FOR CONSTRUCTION AND SEALED BY RONALD L. TAYLOR, SEAL NO. 024649

HAZEN AND SAWYER
Environmental Engineers & Scientists
4011 WestChase Blvd, Raleigh, North Carolina 27607

CITY OF ROANOKE
VIRGINIA

REGIONAL WATER POLLUTION CONTROL PLANT
PROCESS TRAIN IMPROVEMENTS

ADMINISTRATION BUILDING
STRUCTURAL
TOP PLAN

THE SCALE BAR SHOWN BELOW MEASURES ONE INCH LONG ON THE ORIGINAL DRAWING.	DATE	JANUARY 2004
	H & S JOB NUMBER	30788C
	CONTRACT NUMBER	C
	DRAWING NUMBER	S922