

- NOTES:
1. REMOVE EXISTING FLOOR DRAIN. CAP EXISTING SANITARY WASTE LINE AND ABANDON IN PLACE.
 2. SITE CLEAR DRAINAGE PIPING BACK TO A CONCEALED LOCATION AND CAP OFF IN A MANNER CONSISTENT WITH ADJACENT CONSTRUCTION AND MATERIALS. EXISTING VENT PIPING SHALL REMAIN.
 3. SITE CLEAR DOMESTIC WATER PIPING BACK TO A CONCEALED LOCATION AND CAP OFF IN A MANNER CONSISTENT WITH ADJACENT CONSTRUCTION AND MATERIALS.

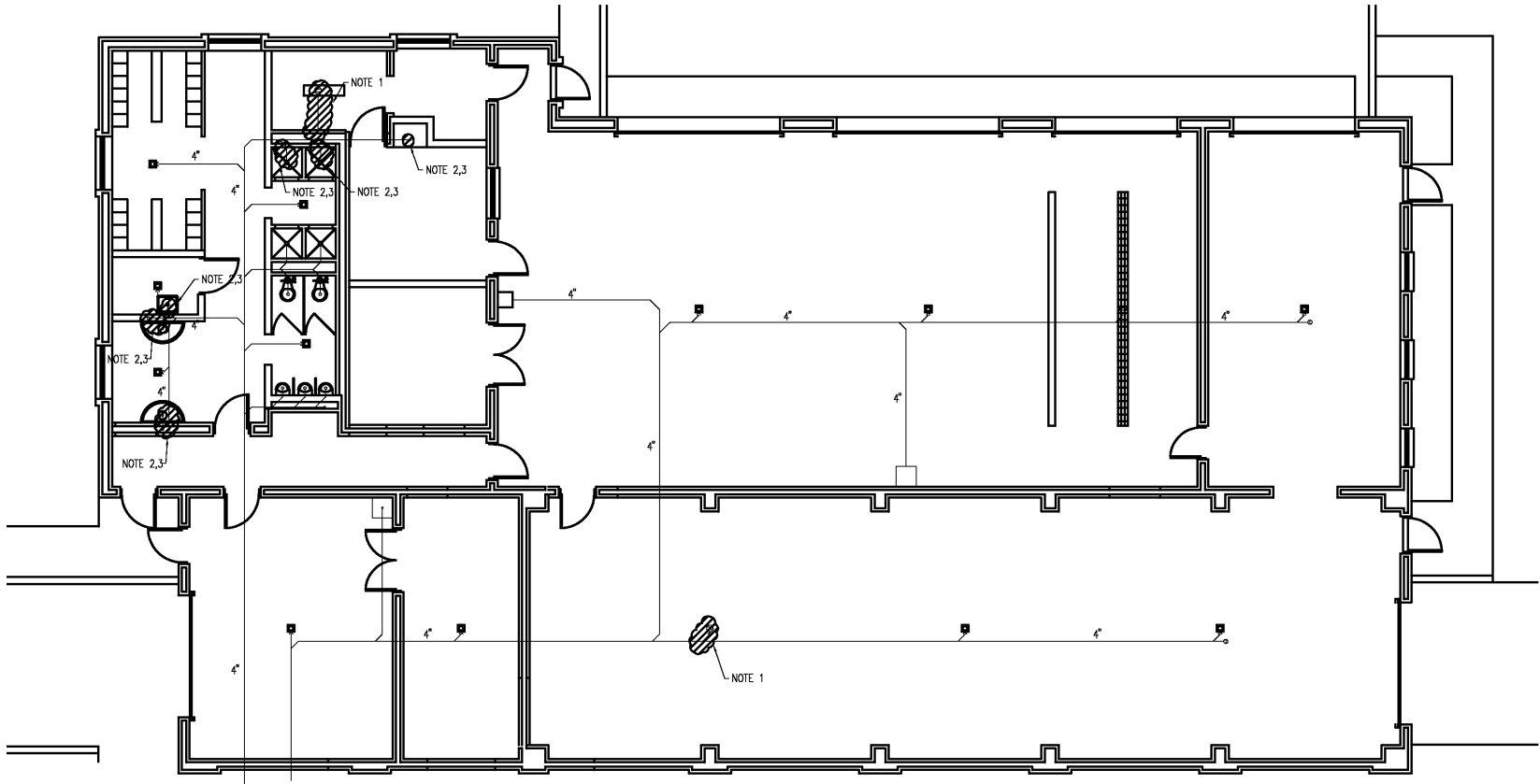

PLUMBING DEMOLITION PLAN
1/8"=1'-0"

			DESIGNED _____	RDM	RECORD DRAWING	THIS DOCUMENT ORIGINALLY ISSUED FOR CONSTRUCTION AND SEALED BY M. GINGER SCOGGINS, SEAL NUMBER 0402 033234. THIS MEDIA SHALL NOT BE CONSIDERED A CERTIFIED DOCUMENT	EDI Engineered Designs, Inc. 1011 Schaub Dr. Suite 201 Raleigh, North Carolina 27606 Office: 919.851.8481 Fax: 919.851.9703	HAZEN AND SAWYER Environmental Engineers & Scientists 4011 WestChase Blvd, Raleigh, North Carolina 27607	CITY OF ROANOKE VIRGINIA	REGIONAL WATER POLLUTION CONTROL PLANT ADMINISTRATION AND MAINTENANCE BUILDINGS	MAINTENANCE BUILDING PLUMBING DEMOLITION PLAN	THE SCALE BAR SHOWN BELOW MEASURES ONE INCH LONG ON THE ORIGINAL DRAWING.	DATE JANUARY 2004	
			DRAWN _____	RDM									H & S JOB NUMBER 30788C	
			CHECKED _____										CONTRACT NUMBER C	
			PROJ. ENGR. _____	H & S									DRAWING NUMBER P961	
3	RECORD DRAWING	JAN 2006												
2	CONSTRUCTION	JAN 2004												
1	REGULATORY APPROVAL	NOV 2003												
NO.	ISSUED FOR	DATE	BY	APPROVED										