

- NOTES:
1. THE CONTRACTOR SHALL WIRE THE EXHAUST FANS SO THAT THE FAN OPERATES WHEN THE LIGHTS IN THEIR RESPECTIVE ROOMS ARE SWITCHED ON. EF-1 SHALL OPERATE WHEN THE LIGHTS IN THE BOTTOM FLOOR MENS ROOM ARE SWITCHED ON. EF-2 SHALL OPERATE WHEN THE LIGHTS IN THE BOTTOM FLOOR WOMENS BATHROOM ARE SWITCHED ON.
 2. THE EF-6 THERMOSTAT SHALL BE A HEAVY DUTY, LINE VOLTAGE TYPE THERMOSTAT. THE THERMOSTAT SHALL HAVE CONTACTS RATED FOR 16A AT 120VAC.

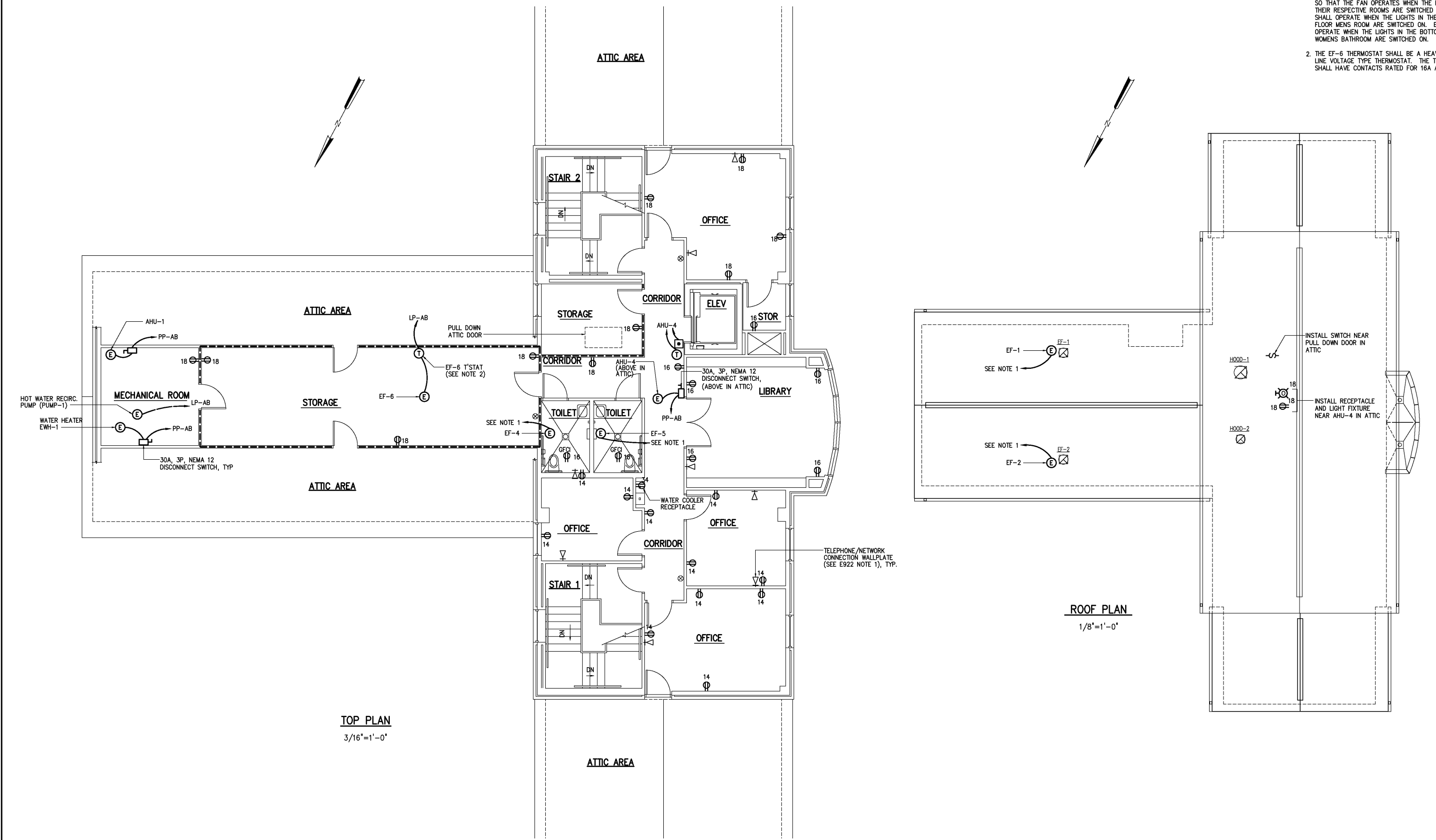

				DESIGNED	BRL	THIS DOCUMENT ORIGINALLY ISSUED FOR CONSTRUCTION AND SEALED BY ROBERT S. DIFIORE, SEAL NO. 22769	RECORD DRAWING	<div><div>Hazen and Sawyer</div><div>Environmental Engineers & Scientists</div><div>4011 WestChase Blvd, Raleigh, North Carolina 27607</div></div>	CITY OF ROANOKE VIRGINIA	ADMINISTRATION BUILDING	THE SCALE BAR SHOWN BELOW MEASURES ONE INCH LONG ON THE ORIGINAL DRAWING.	DATE	JANU.
				DRAWN	DJG							H & S JOB NUMBER	
				CHECKED								CONTRACT NUMBER	
				PROJ. ENGR.	H & S							C	
3	RECORD DRAWING	JAN 2006	RLT			THIS DOCUMENT ORIGINALLY ISSUED FOR CONSTRUCTION AND SEALED BY RONALD L. TAYLOR, SEAL NO. 024649	THIS DRAWING HAS BEEN MODIFIED TO REFLECT FIELD CHANGES REPORTED BY THE CONTRACTOR OR ANOTHER PARTY, BUT NOT VERIFIED BY THE CERTIFYING ENGINEER. THIS DOCUMENT ORIGINALLY ISSUED AND SEALED BY GERALD J. RATASKY, 026535. THIS MEDIA SHALL NOT BE CONSIDERED A CERTIFIED DOCUMENT.	REGIONAL WATER POLLUTION CONTROL PLANT PROCESS TRAIN IMPROVEMENTS		ELECTRICAL	TOP AND ROOF POWER PLANS		
2	CONSTRUCTION	JAN 2004	RLT										
1	REGULATORY APPROVAL	NOV 2003	RLT										
NO.	ISSUED FOR	DATE	BY	APPROVED									